

KLA 418
ANADOLU'DA ROMA MİMARİSİ

7. Hafta

HAMAM GYMNASİONLAR

HAMAM GYMNASİONLAR

Kaynakça:

- 1- F. Yegül, *Roma Dünyasında Yıkanma* (Koç Üniversitesi Yayınları, 2010)
- 2- F. Yegül, *Bathing in the Roman world* (Cambridge University Press 2010).
- 3-F. Yegül, *Antik Çağ'da Hamamlar ve Yıkanma* (Homer Yayınları, 2006).
- 4- E. Brödner, *Die römischen Thermen und das antike Badewesen* (Wissenschaftliche Buchgesellschaft, Darmstadt 1983)
- 5- P. Connolly – H. Dodge, *Die antike Stadt, Das Leben in Athen und Rom* (Könemann Verlag, 1998)
- 6- [A. Mau](#), “[Bäder](#)”, in: [Paulys Realencyclopädie der classischen Altertumswissenschaft](#)(RE). Band II,2, Stuttgart 1896, Sp. 2743–2758.
- 7- E. Seidl (ed.), *Lexikon der Bautypen. Funktionen und Formen der Architektur.* (Stuttgart 2006).
- 8- M. Weber, *Antike Badekultur* (C. H. Beck, München 1996).

İrili ufaklı hamamlar Roma İmparatorluk dönemi boyunca hep bir arada varlıklarını korumuştur.

Büyük halk hamamlarını ifade eden devletin mülkiyetinde olan **thermae** çok geniş alanları kaplar, mimarileri çok görkemli olan **thermae** terimi MS 1. yüzyılın sonunda Roma İmparatorluğu'nda yaygınlaşmıştır.

Thermae terimi Eski Yunanca: θερμὸν λουτρὸν (sıcak banyo), θερμός (thermos) "sıcak" kelimelerinden türemiş ve **balneum** teriminin yerini almıştır (Eski Yunanca βαλανεῖον *balaneion* "Banyo"; latinceleşmiş olarak *balineum, balneum, balnea*).

Balnae: Küçük hamamlar, özel mülkiyet mallarıdır ve kent içindeki yoğun yapılaşmanın içindedir, çoğunlukla başka yapılarla duvarlarını paylaşmaktadır.

Hypokaust ısıtma sistemi

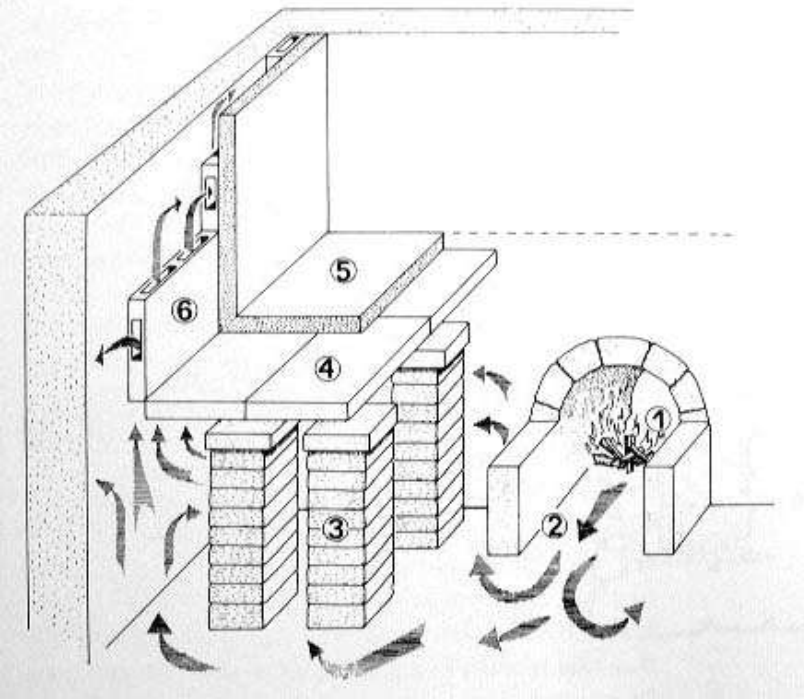

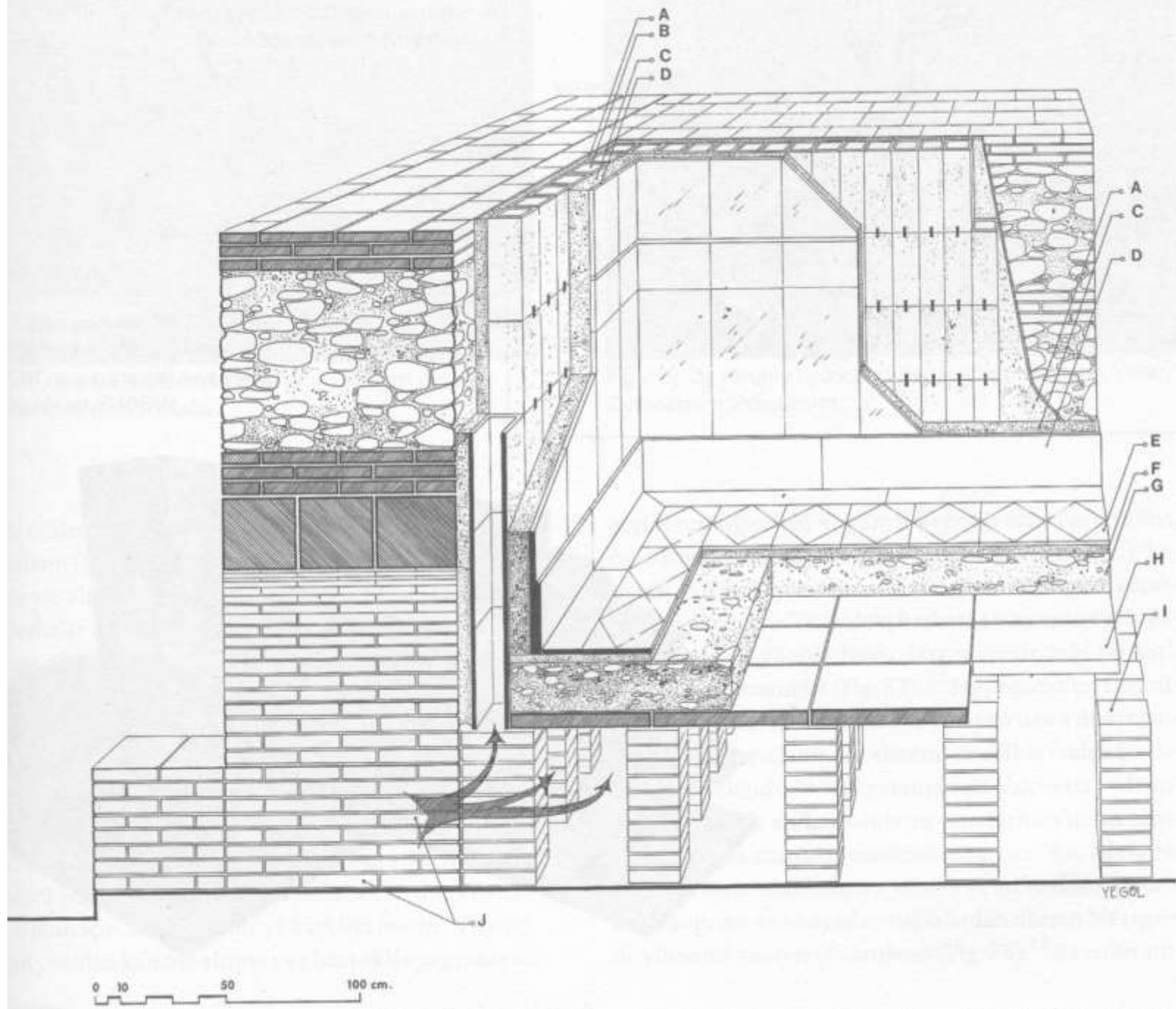

0 10 50 100 cm.

Külhan



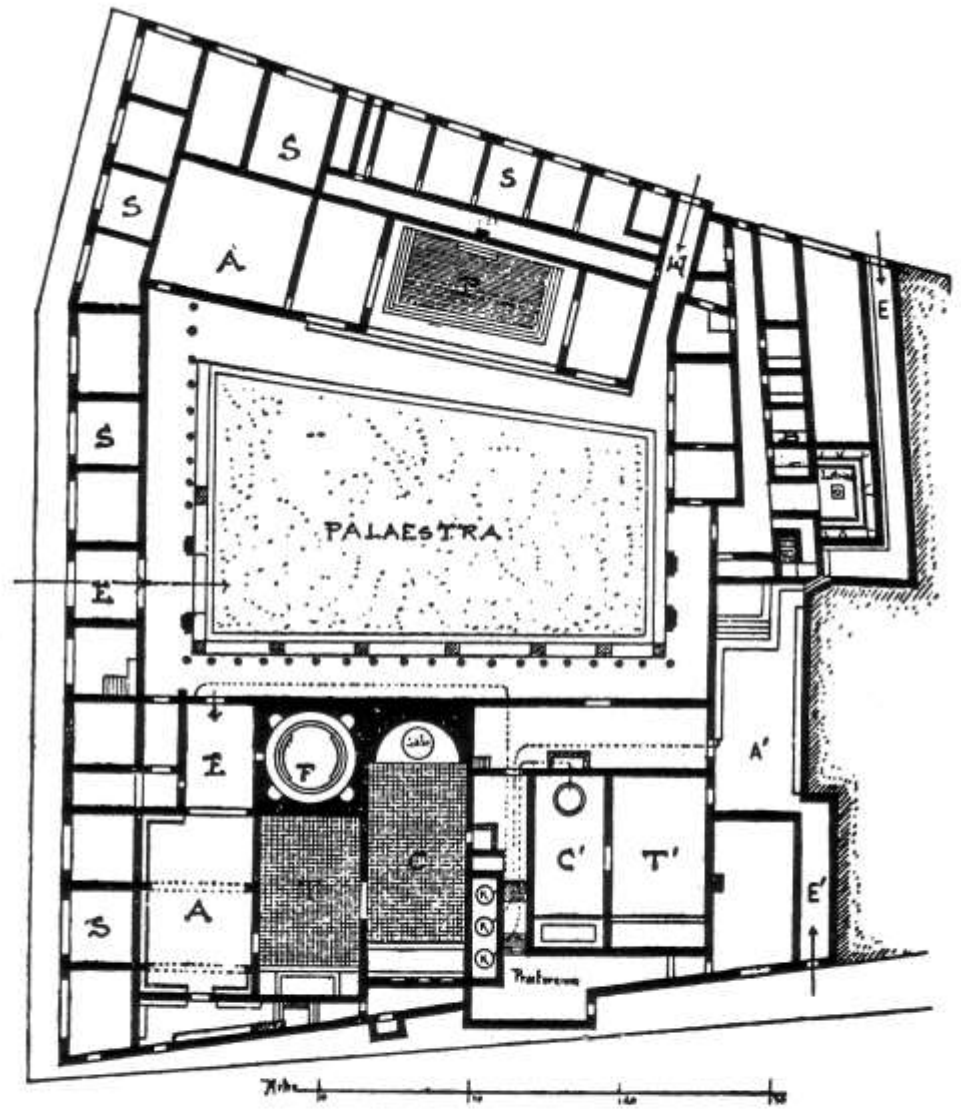
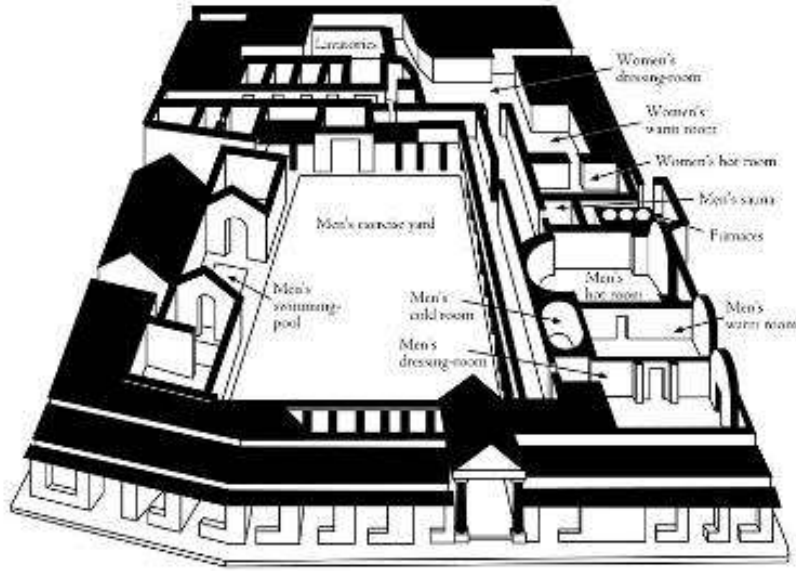

STABIAN HAMAMLARI, POMPEII

S,S. Dükkânlar. B. Özel Hamamlar. A-T. Erkekler Hamamı A-T. Kadınlar Hamamı. E.É. Girişler. A,Á. Apodyteriumlar. F. Frigidarium. T.T. Tepidarium. C.C. Caldarium. K,K,K. Kazanlar. P. Piscina.

BÖLÜMLER

Apodyterium: Soyunma odası

Frigidarium : Soğukluk

Tepidarium : Ilıklık

Caldarium : Sıcaklık

Laconicum: Terleme Odası

Piscina : Yüzme havuzu

Praefurnium : Külhan

APODYTERIUM: SOYUNMA ODASI

Campania Hamamı apodyterium

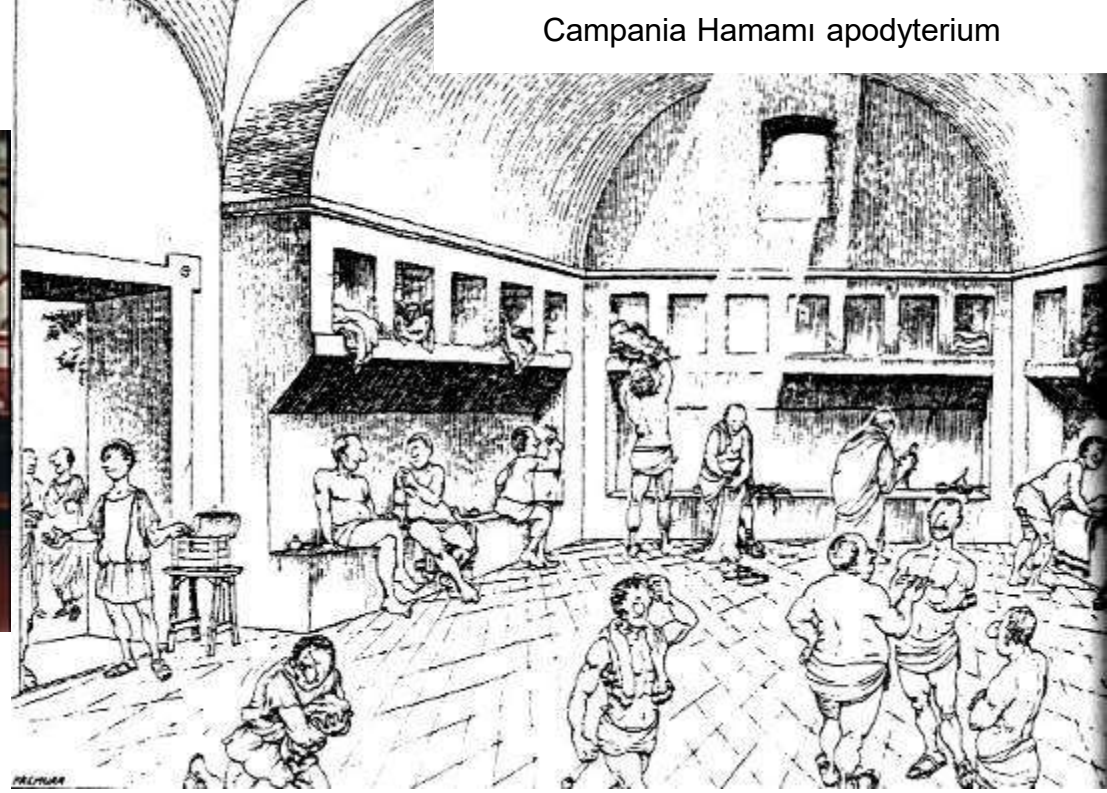

Herculaneum Forum Hamamı bayanlar apodyterium



Pompei Stabian Hamamı bayanlar apodyterium



Isthmia Roma Hamamı apodyterium

FRIGIDARIUM : SOĞUKLUK

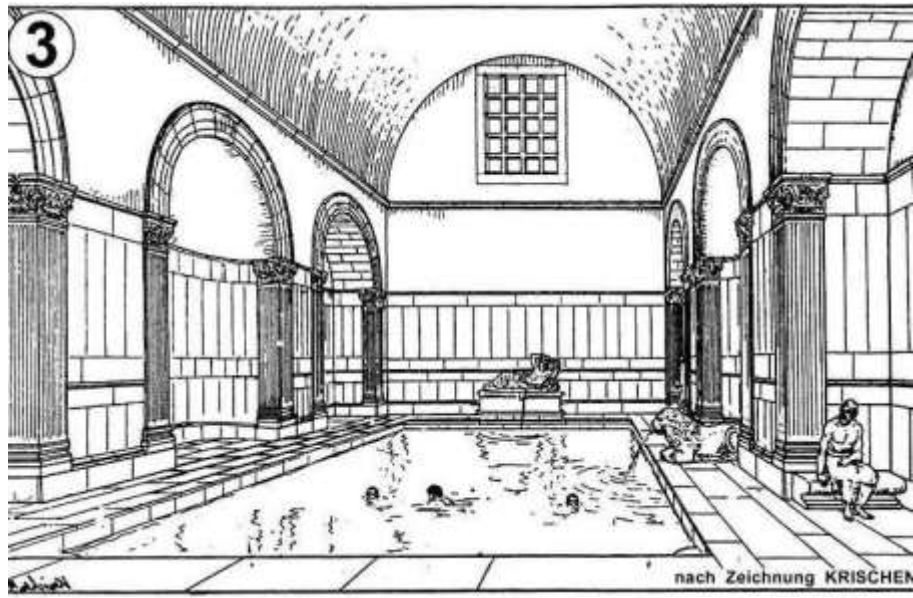
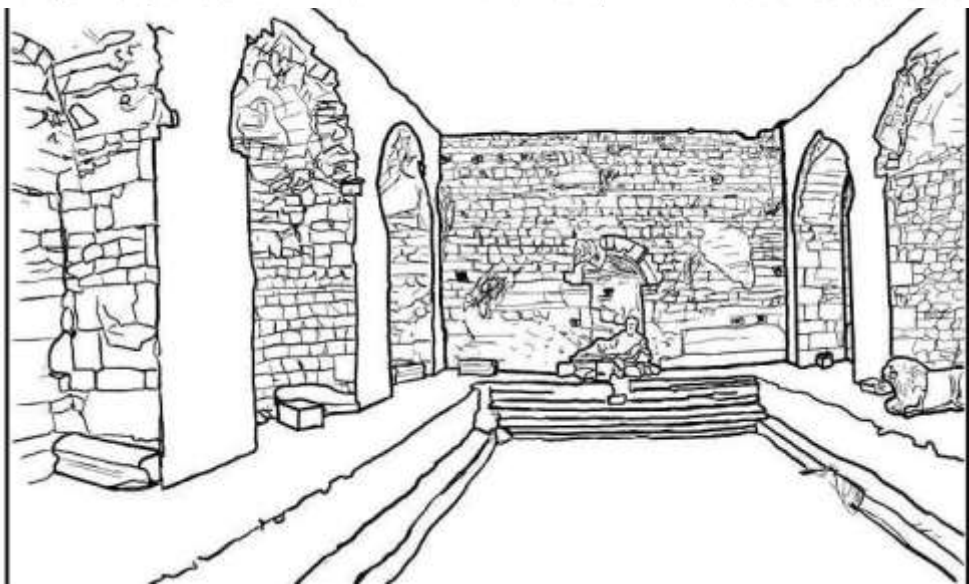
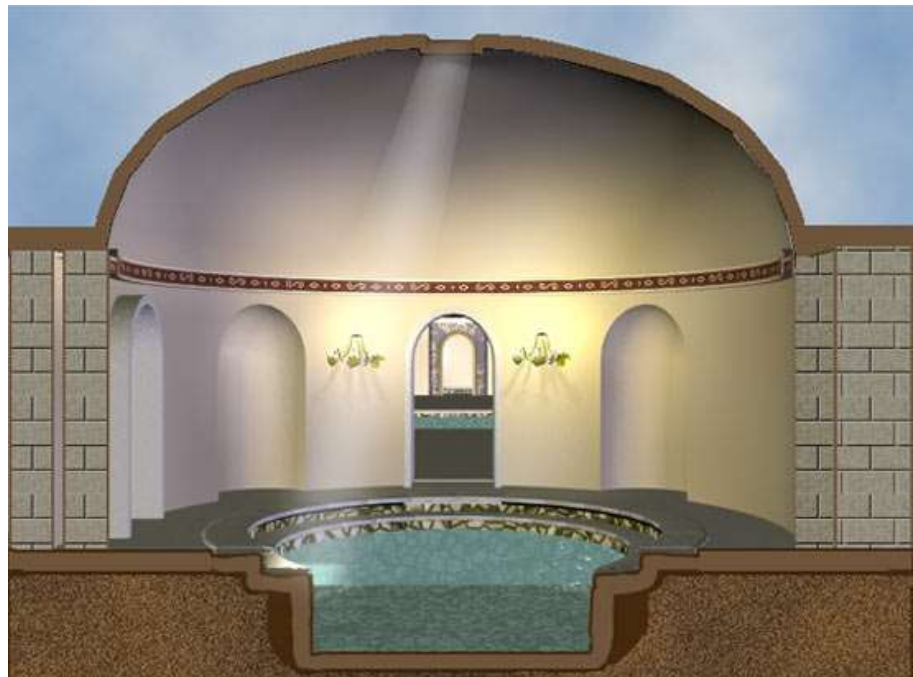
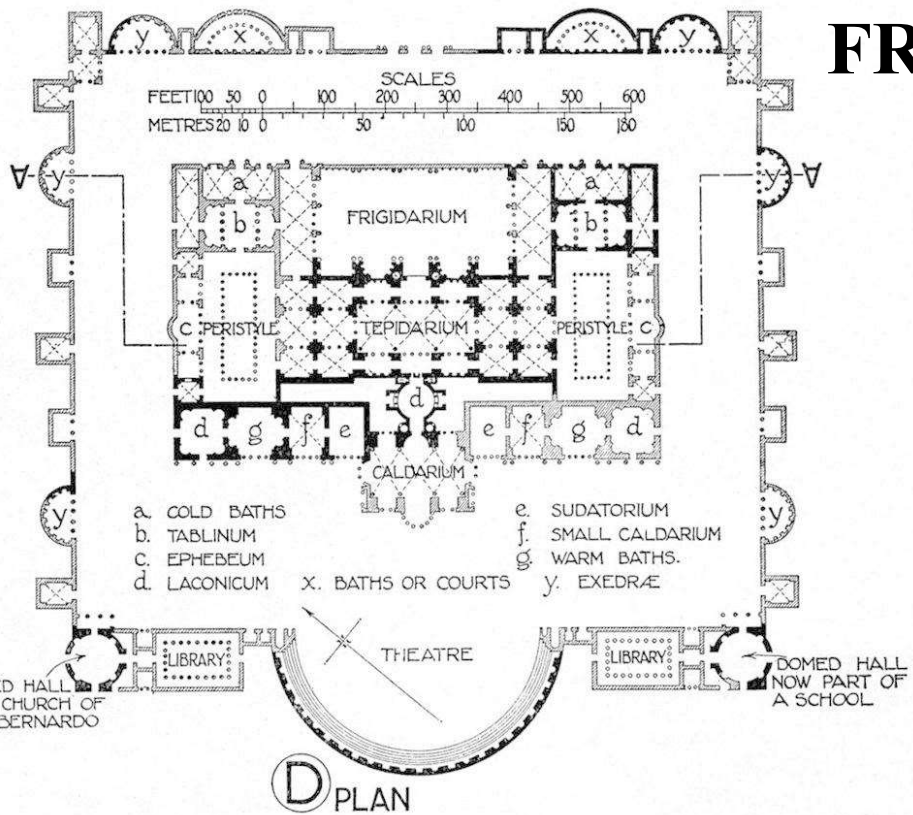

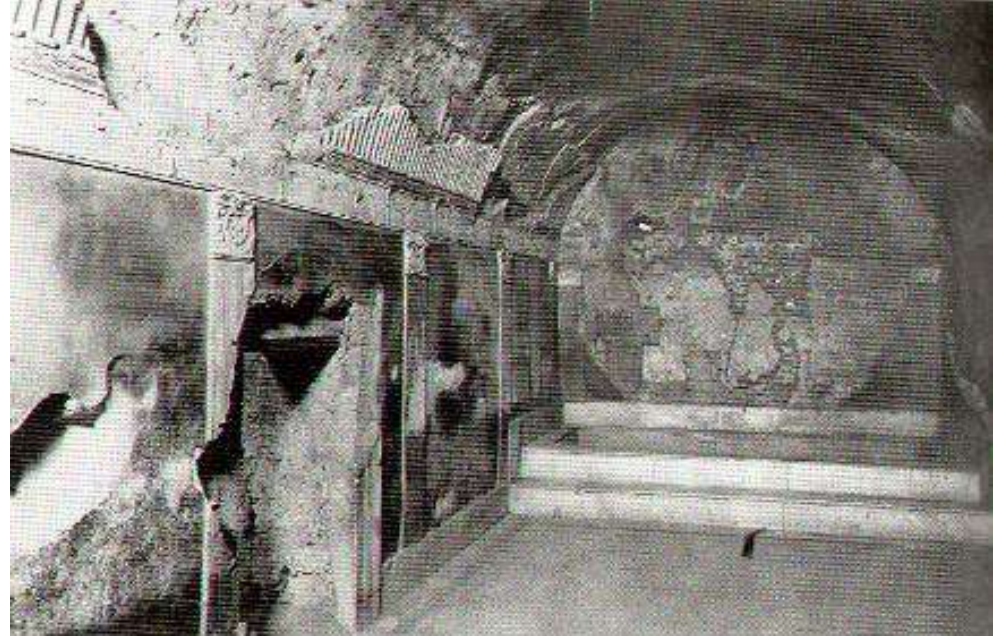
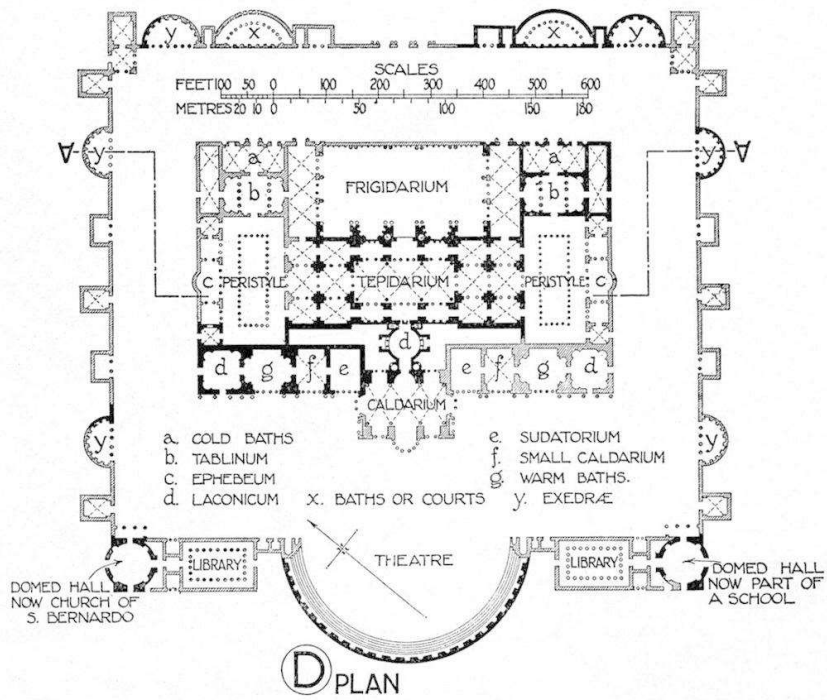

Pompei Stabia Hamamı bayanlar caldarium

CALDARIUM : SICAKLIK

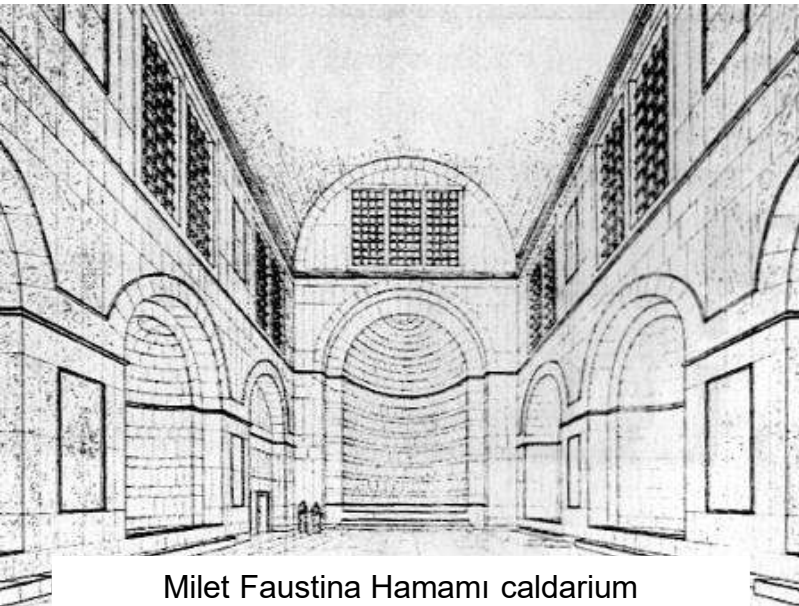

Milet Faustina Hamamı caldarium



Pompei Forum Hamamı erkekler caldarium

LACONICUM : TERLEME ODASI

Pompei Stabian Hamamı Laconicum

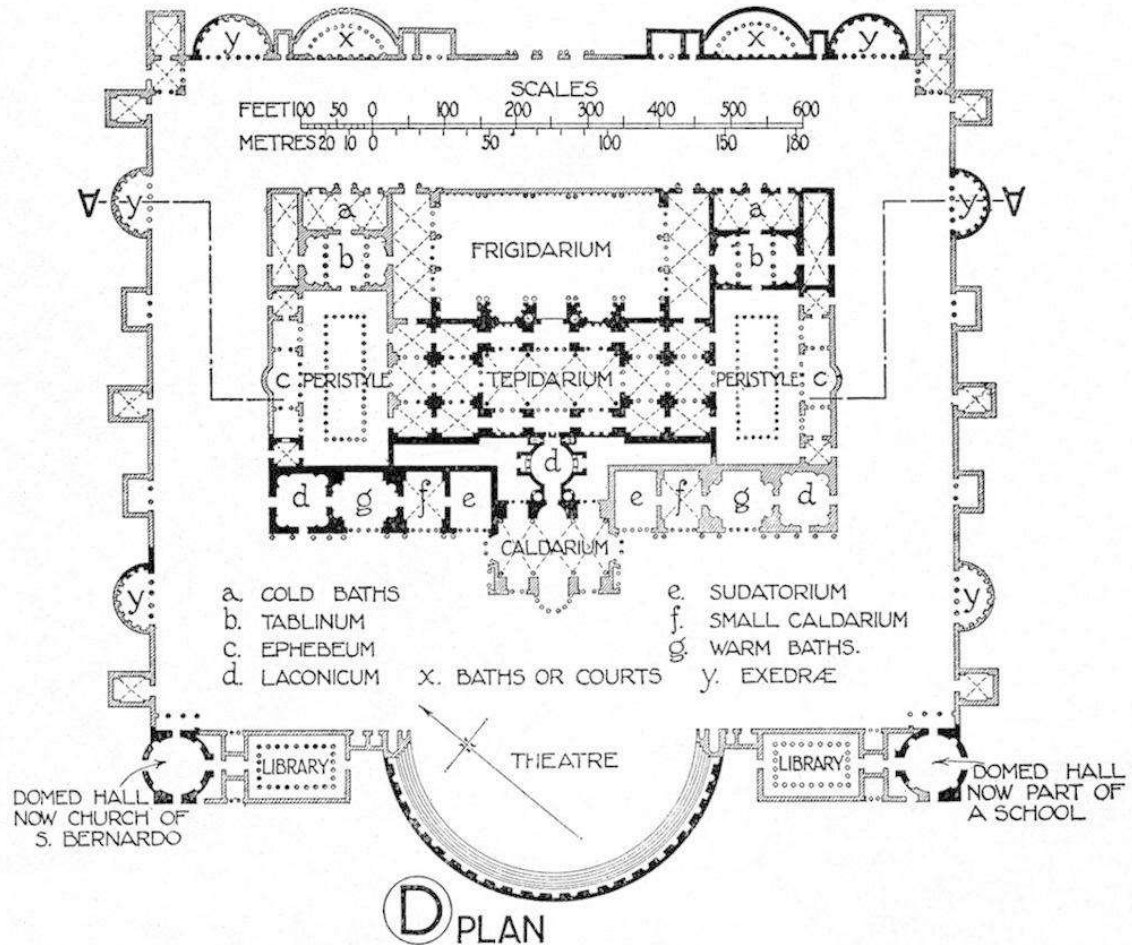
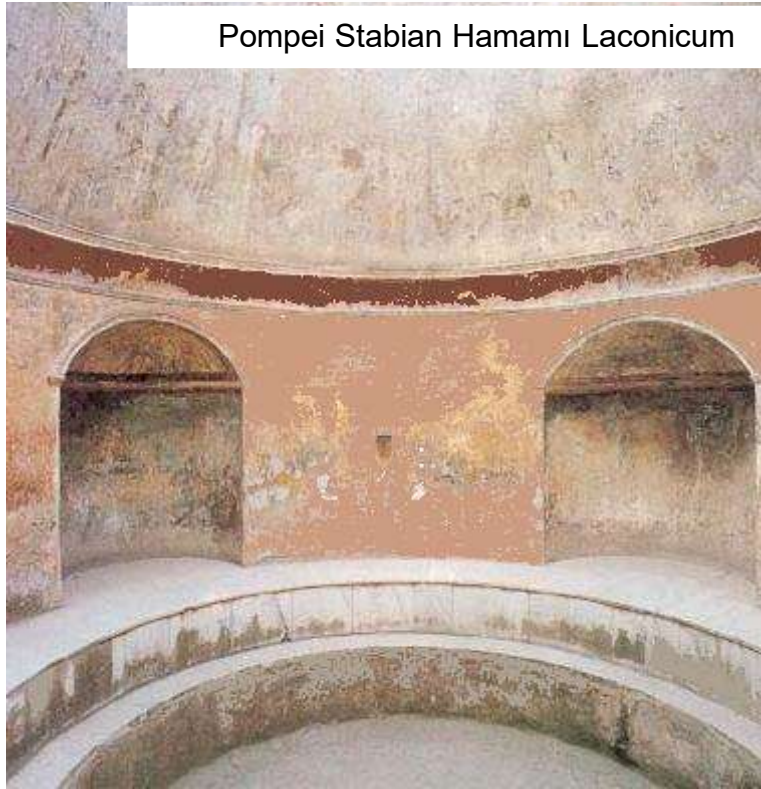

Roma hamamları Őu plan tiplerinde incelenebilir:

1. Simetrik planlı hamamlar
2. Asimetrik planlı hamamlar
3. Kismen simetrik ya da “yarı-eksensel” Őemalardan oluŐan hamamlar.

Roma Traian Hamami (MS 98-117)

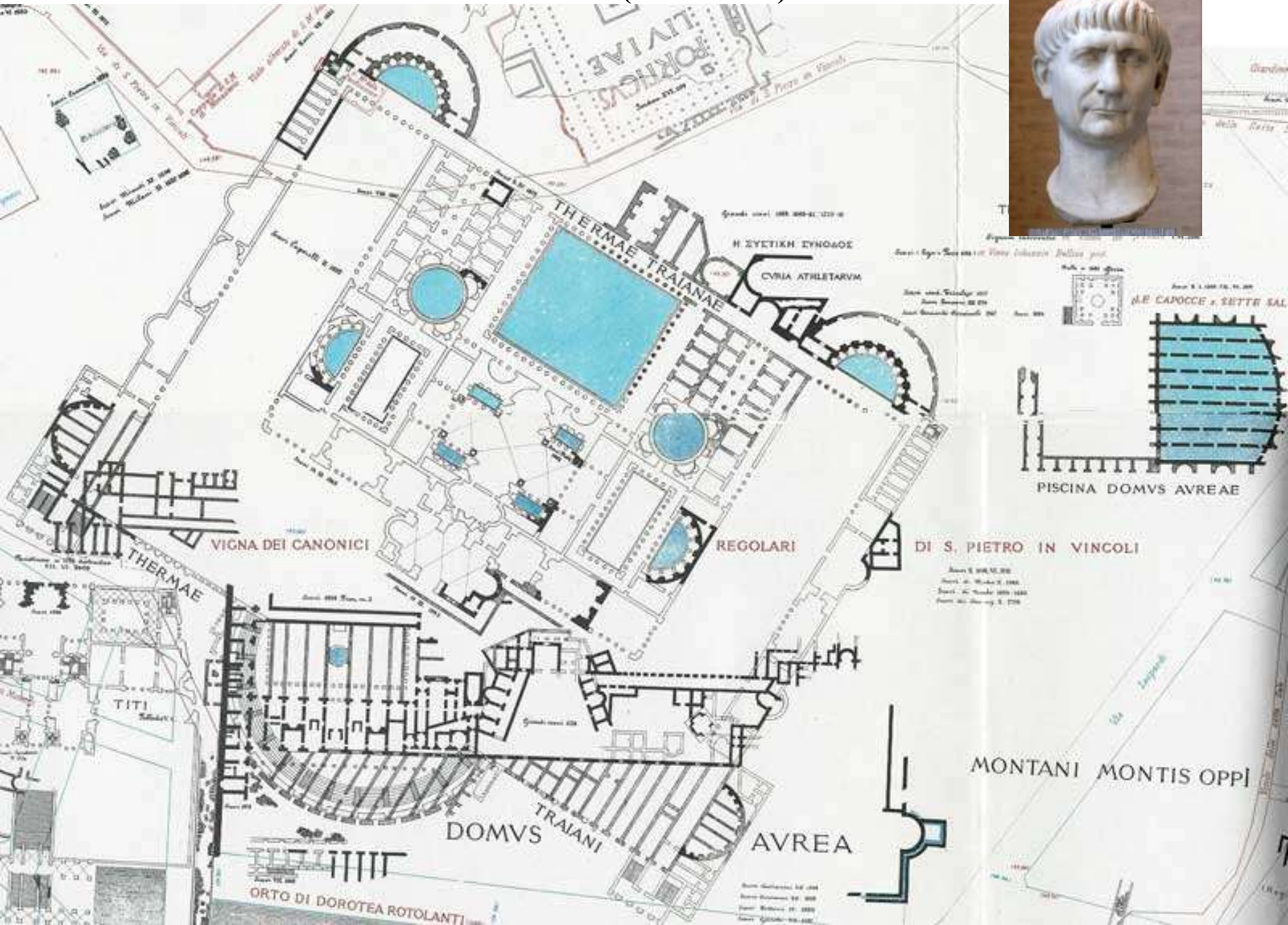

THERMAE TRAIANAE

Η ΣΥΕΤΙΚΗ ΕΥΧΟΑΟΣ
CVRIA ATHLETARVM

PISCINA DOMVS AVREAE

VIGNA DEI CANONICI

REGULARI

DI S. PIETRO IN VINCOLI

DOMVS TRAIANI

AVREA

MONTANI MONTIS OPPI

ORTO DI DOROTEA ROTOLANTI

TITI

Roma Caracalla Hamami (MS 188-211)

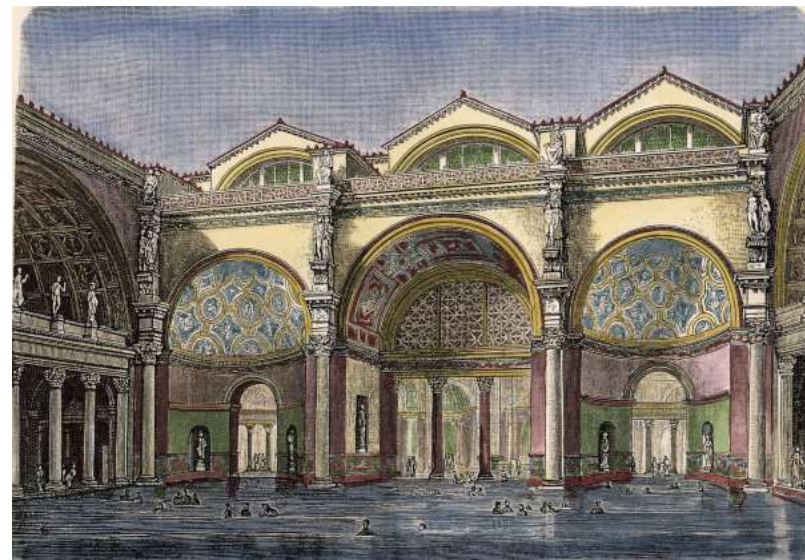
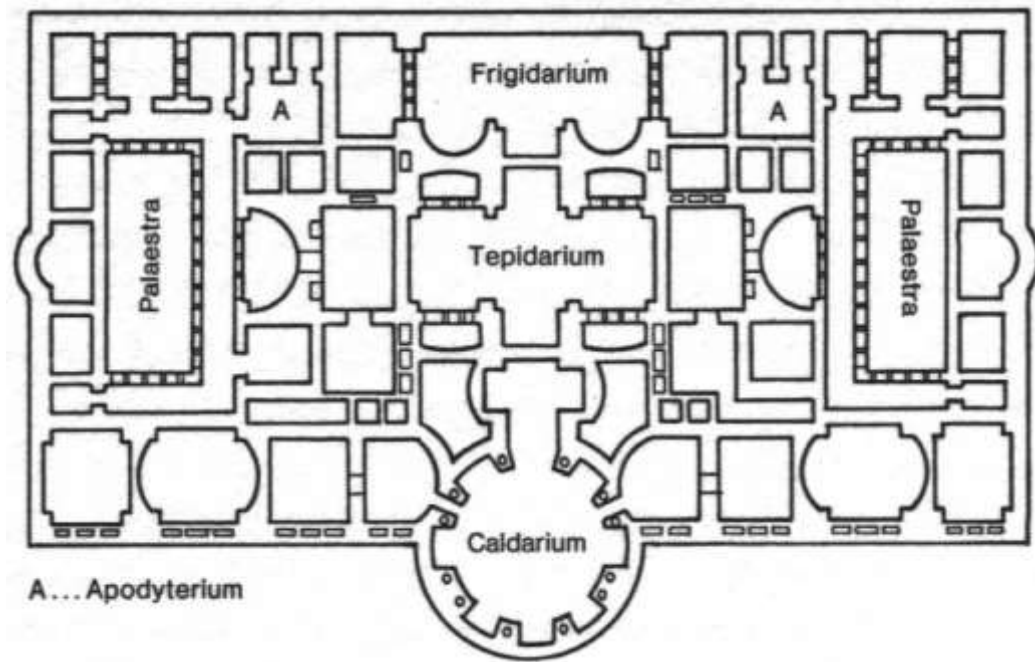

Roma Diocletian Hamami (M.S. 298 – 306)

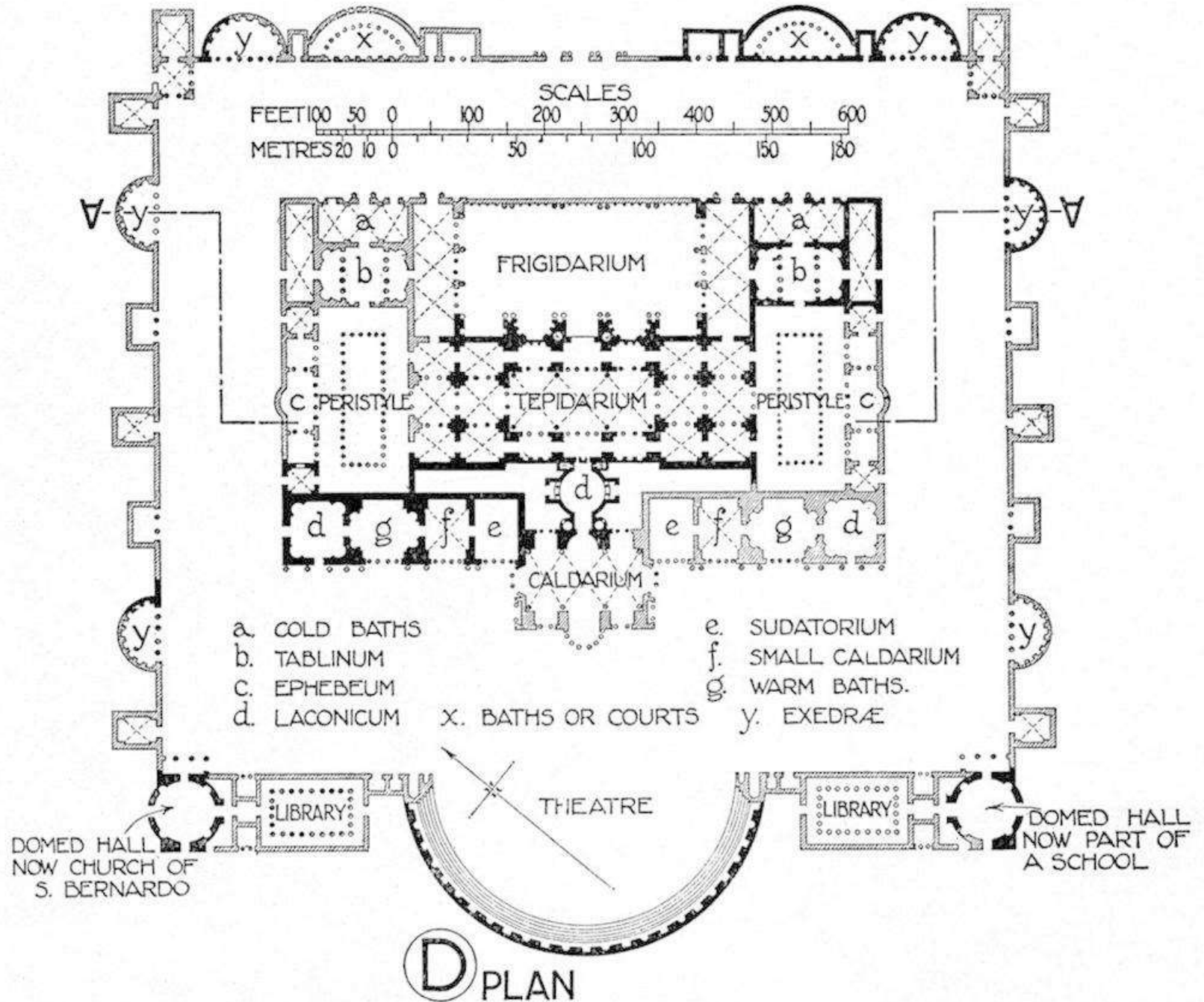

**Anadolu Hamam – Gym.
Çift Sıralı Mekanlar olan tip**

Ephesos – Liman Hamam-Gym.

Termessos – Hamam-Gym.

Laodikeia – Hamam-Gym.

Aphrodisias – Hamam-Gym.

Hierapolis – Hamam-Gym.

Magnesia ad Maeandrum - Caserma Hamamı

Magnesia ad Maeandrum – Gym. Hamamları

Ancyra – Caracalla Hamam-Gym.



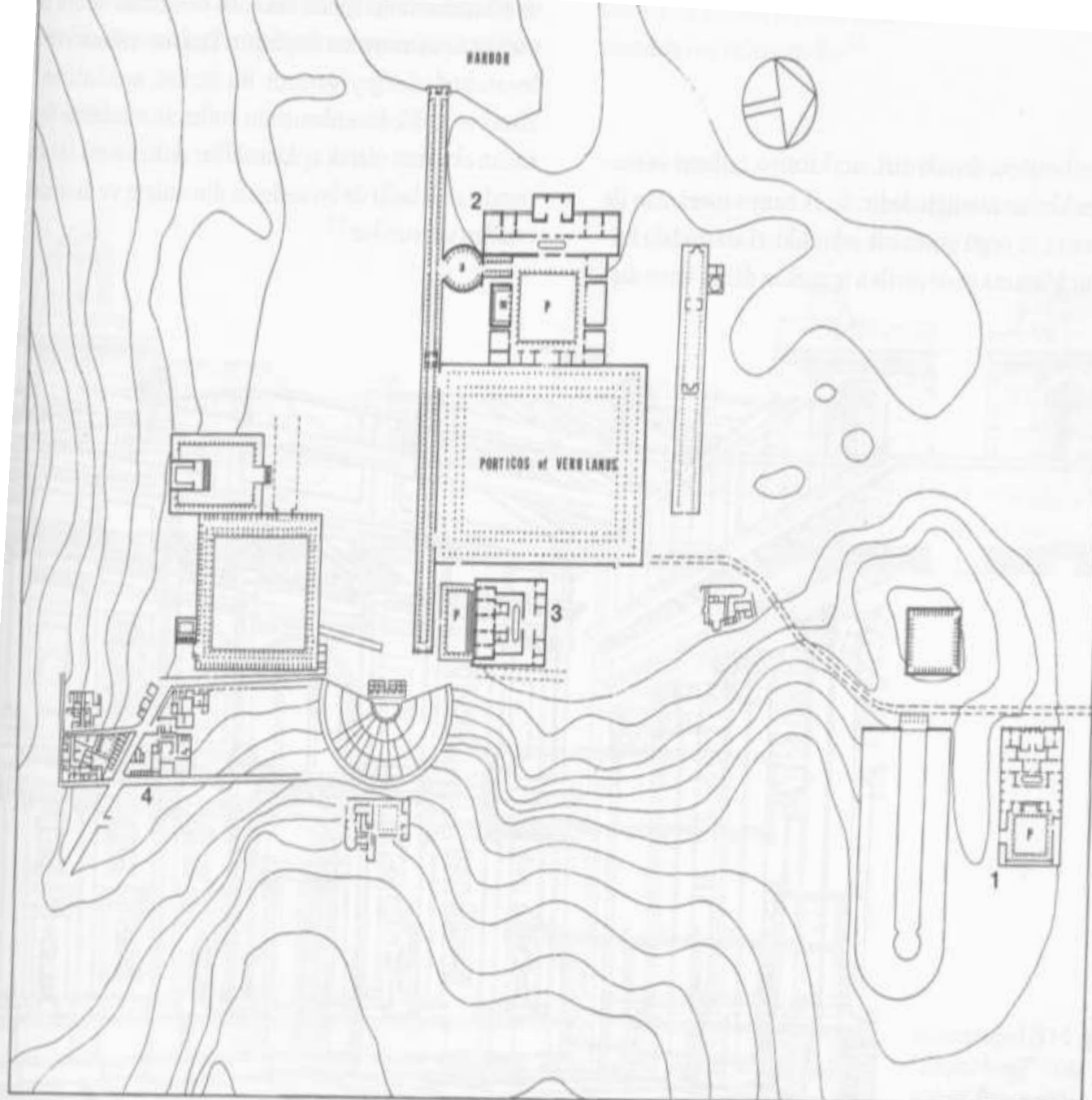

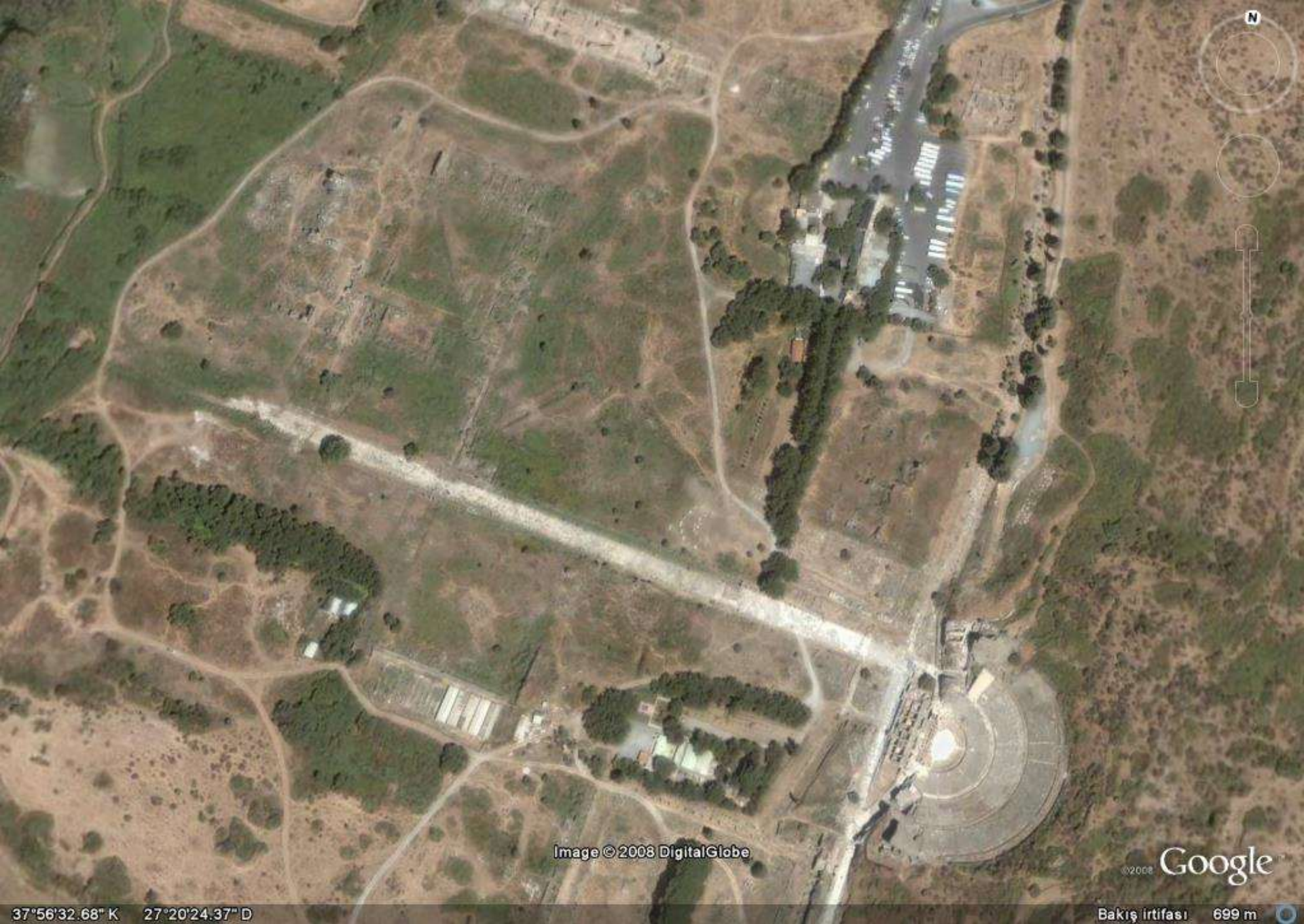
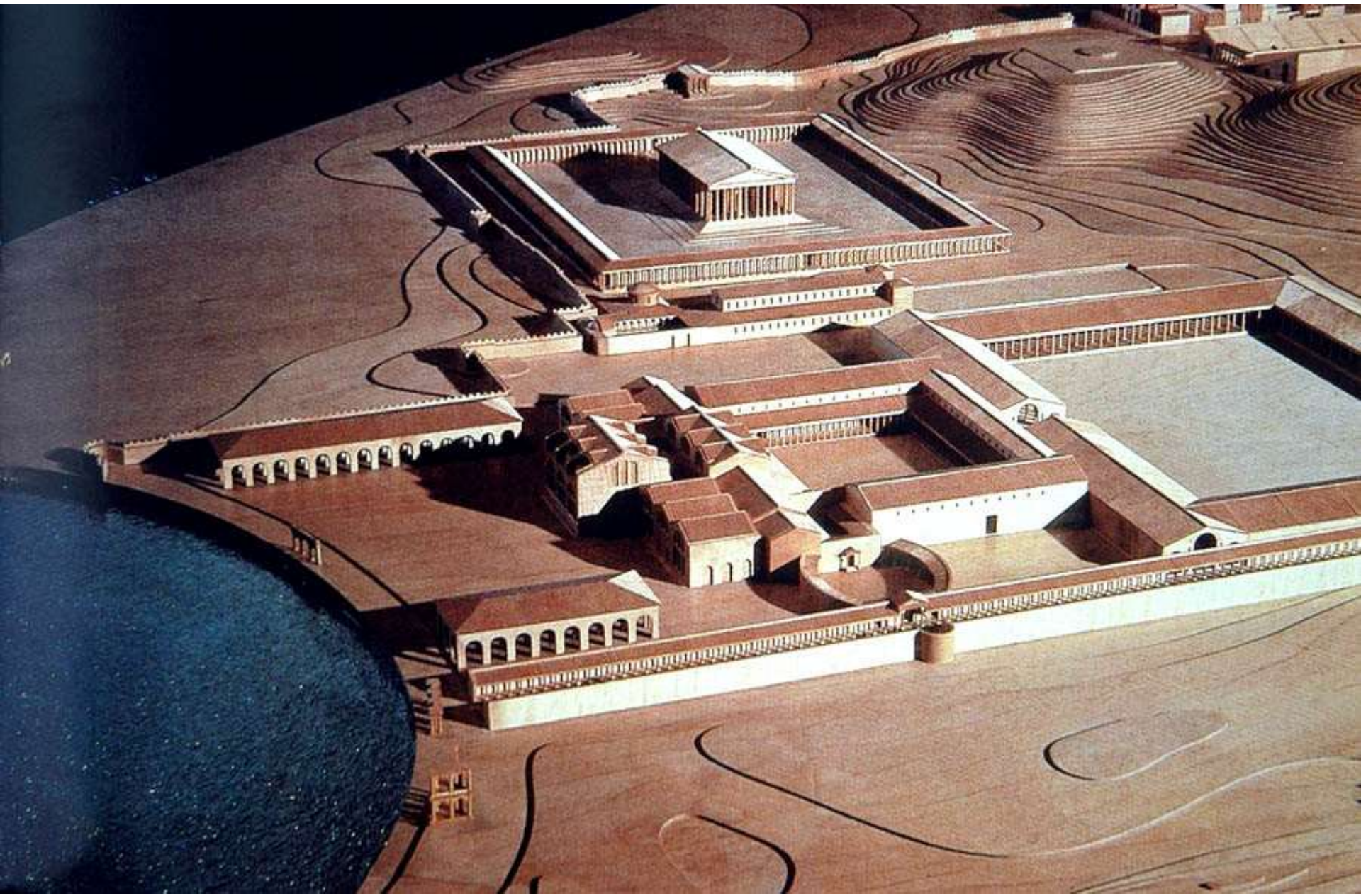

Image © 2008 DigitalGlobe

©2008 Google

37°56'32.68" K 27°20'24.37" D

Bakış İrtifası 699 m



Ankara Caracalla Hamamı



Ankyra Caracalla Hamamı

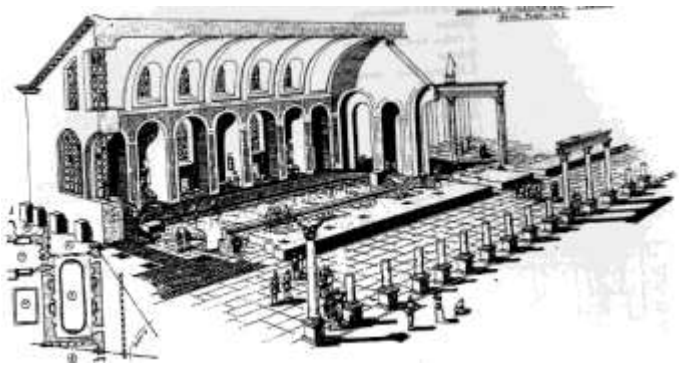

- P:** Palaestra (spor alanı)
M: İmparator Kült Salonu
F: Frigidarium (soğukluk)
B: Basilica thermarum (kapalı palaestra)
A: Apodyterium (soyunma odası)
T: Tepidarium (ılıkılık)
C: Caldarium (sıcaklık)
N: Natatio (büyük yüzme havuzu)
L: Laconicum (terleme odası)
1-3: Isıtılan odalar
S: Servis odaları
V: Giriş
f: praefurnium (ocak)
La: Latrina (tuvalet)

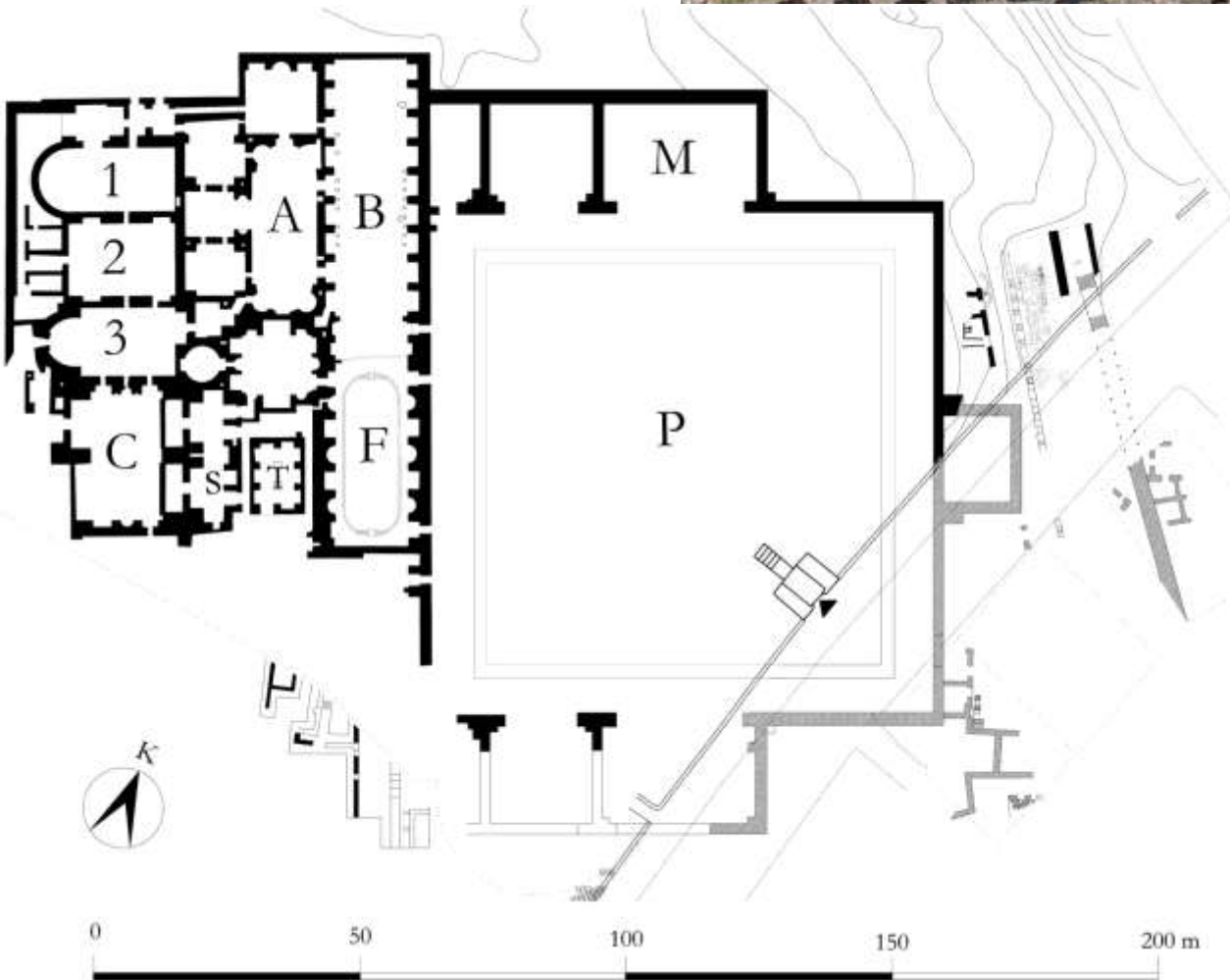

**Anadolu Hamam – Gym.
U-Planlı Salonlar ve Ters Dolaşım olan tip**

**Ephesos – Dođu Hamam-Gym.
Tiyatro – Hamam-Gym.
Alexandria Troas – Hamam-Gym.**

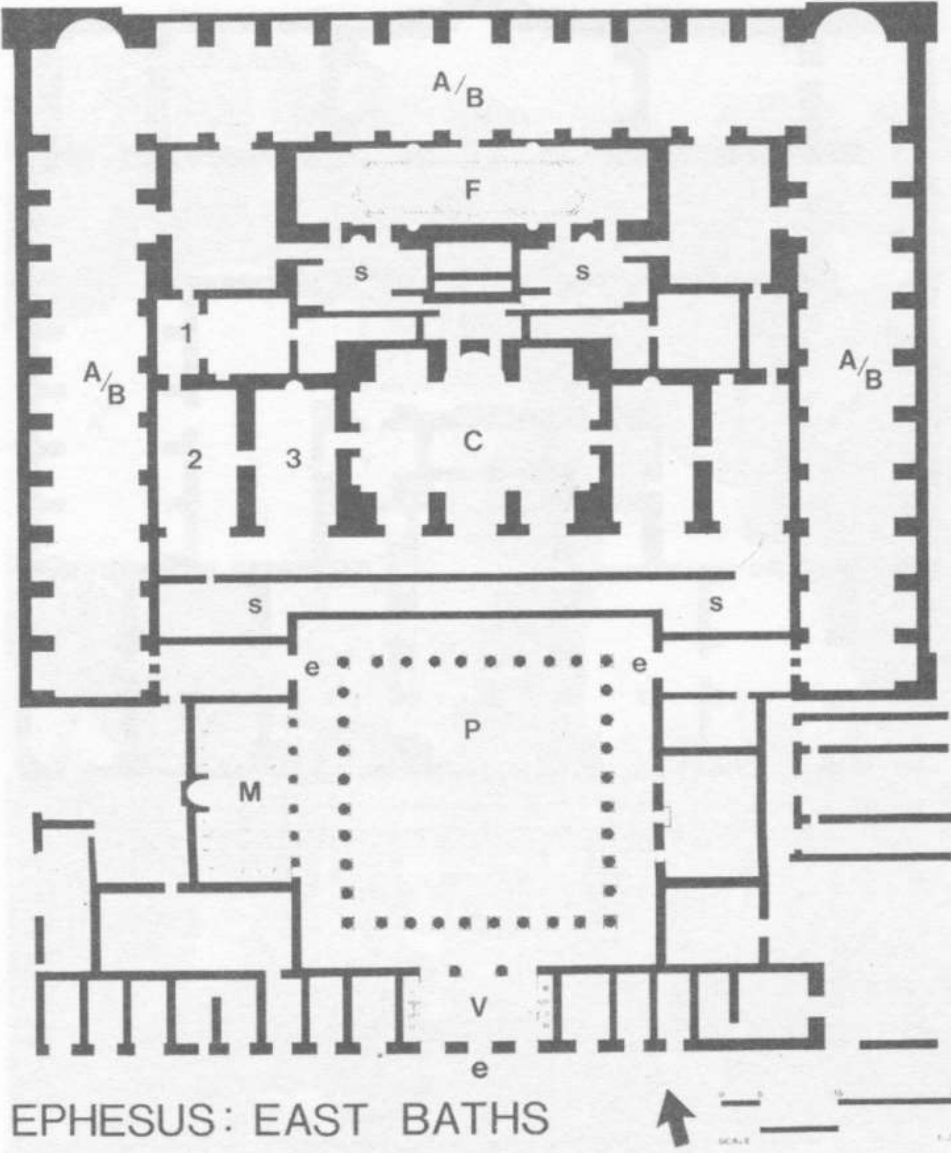

EPHESUS: EAST BATHS

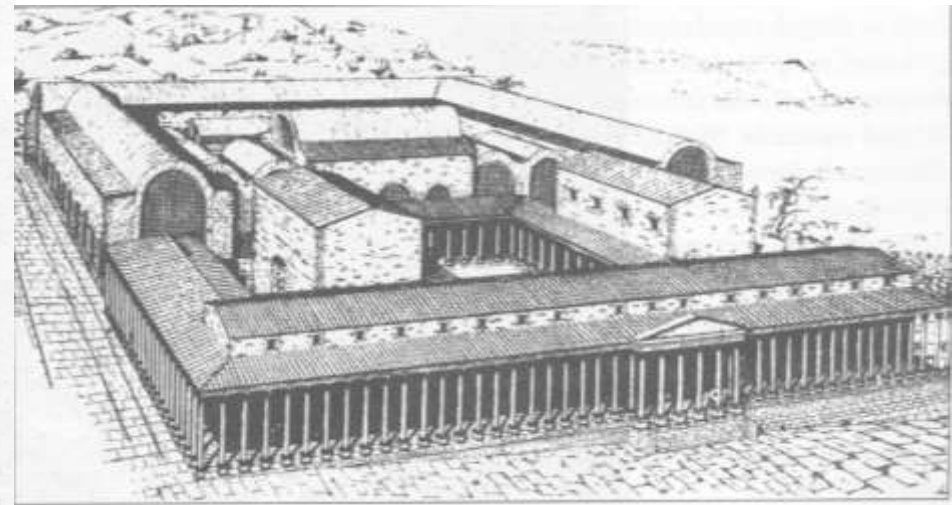

Ephesos – Doğu Hamam-Gym.

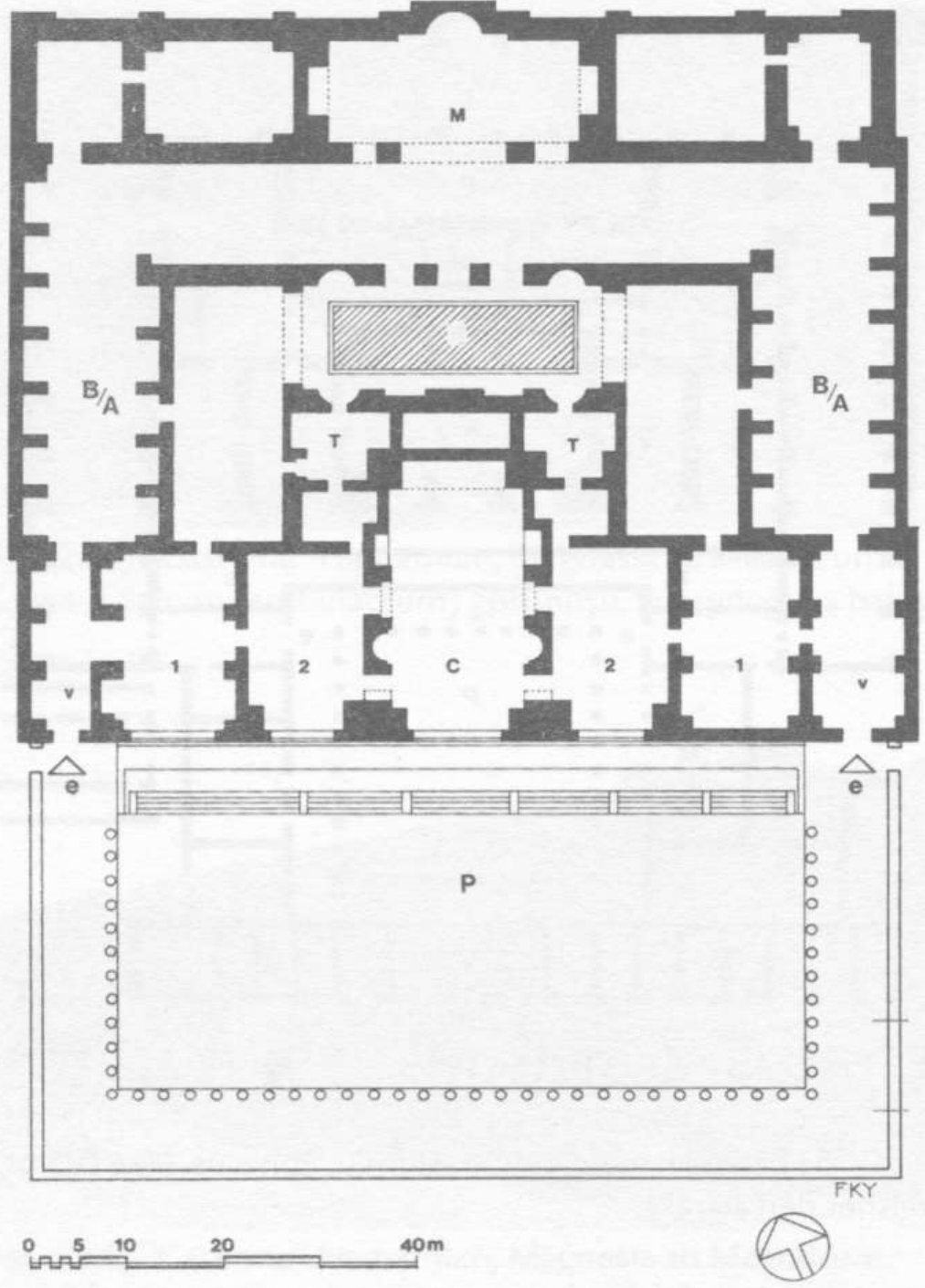

Tiyatro – Hamam-Gym.

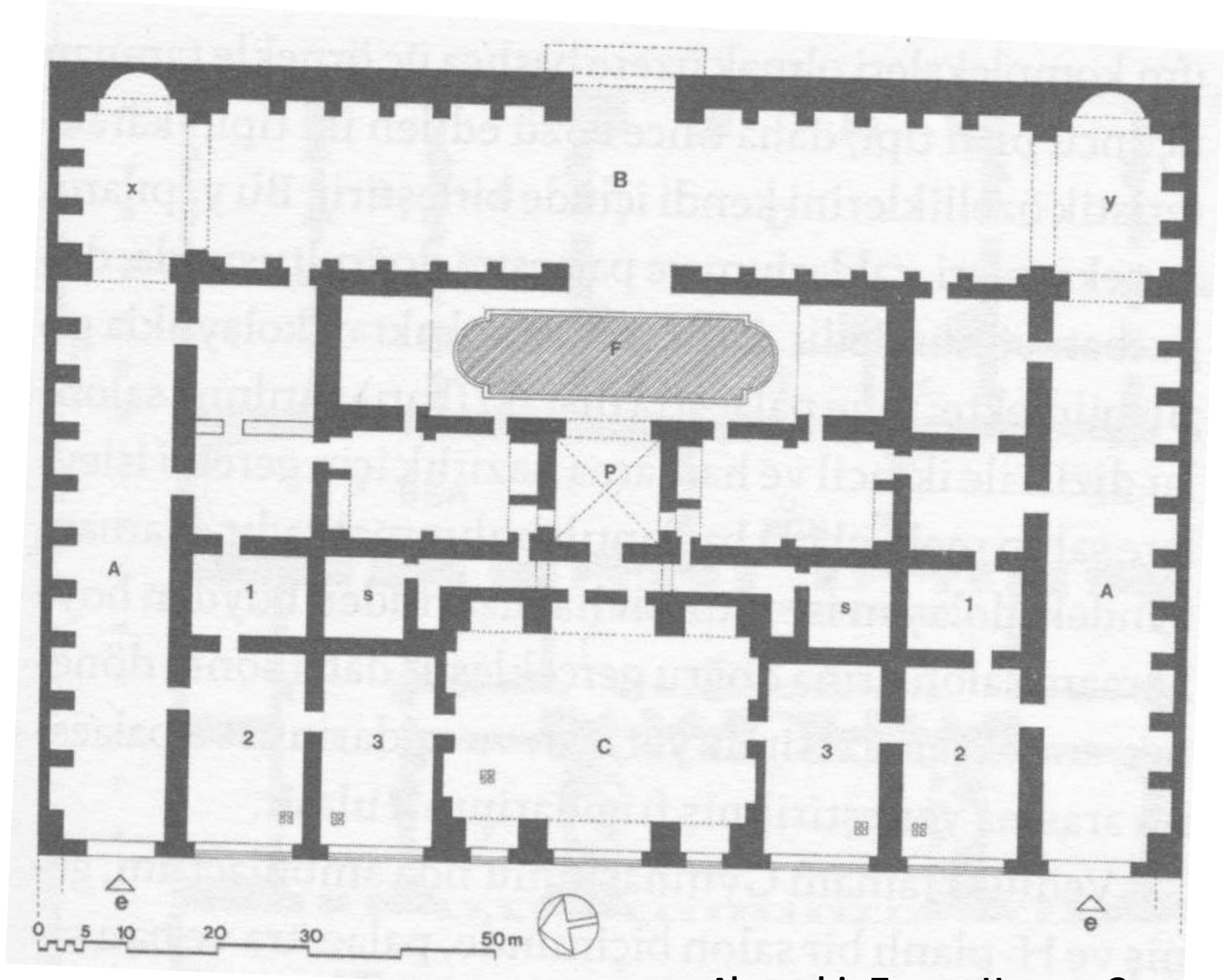

Alexandria Troas – Hamam-Gym.

Anadolu Hamam – Gym.

**Hamam ve Palaestra'nın aynı eksen
üzerinde birleştiği tip**

Ephesos – Vadius Hamam-Gym.

Sardes – Hamam-Gym.

Aezanoi – Hamam-Gym.

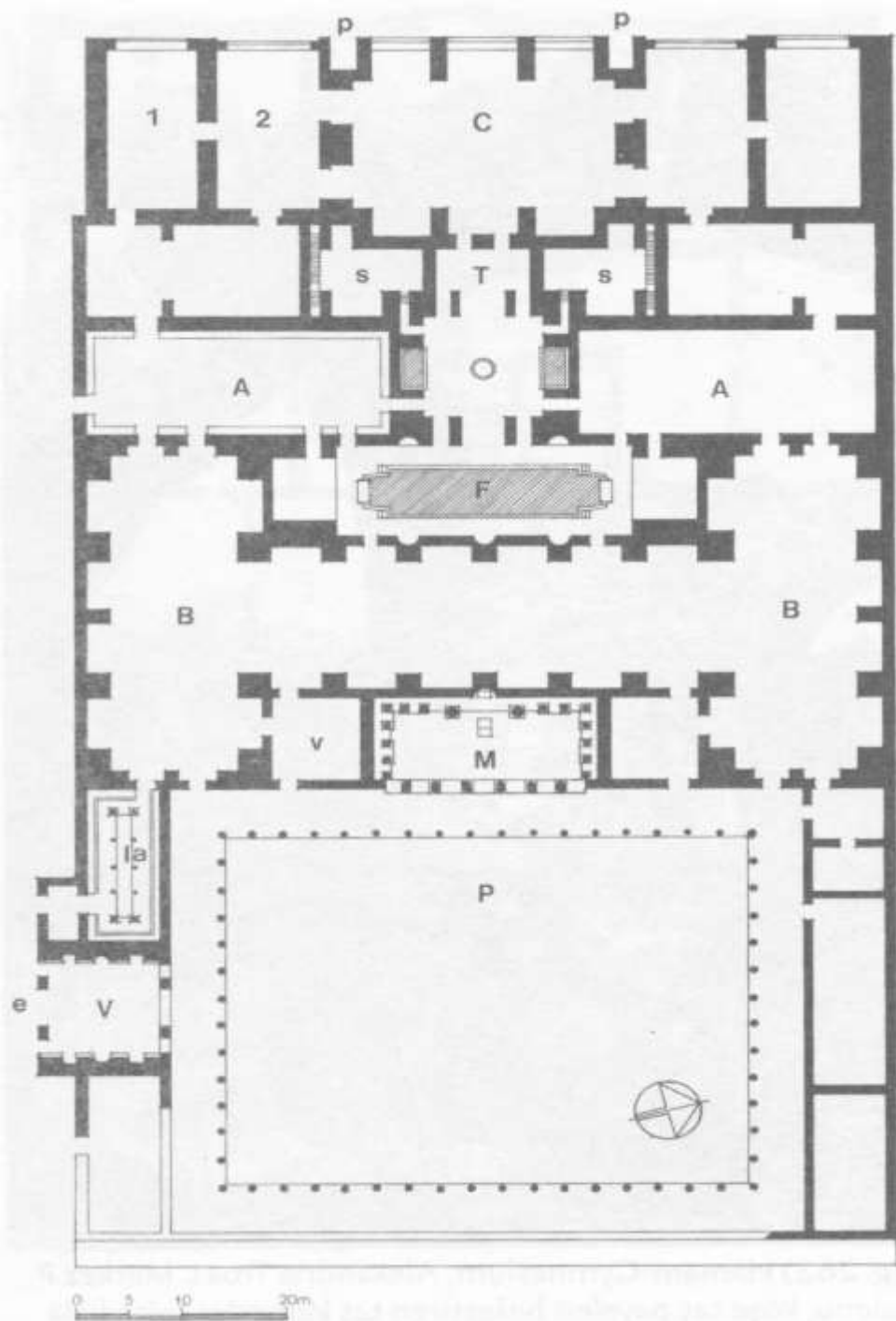

Ephesos – Vedius Hamam-Gym.

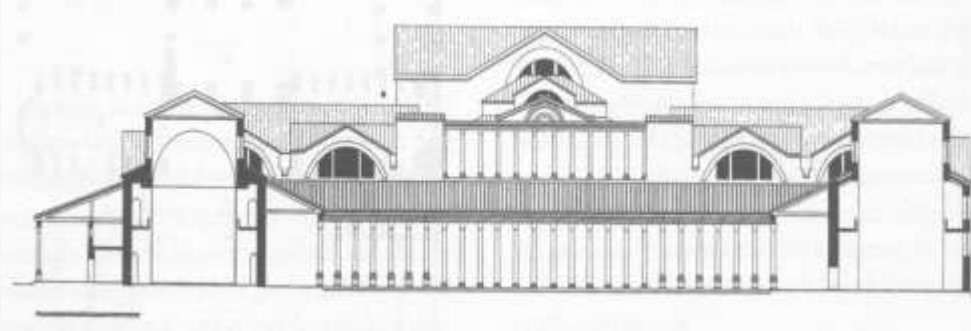
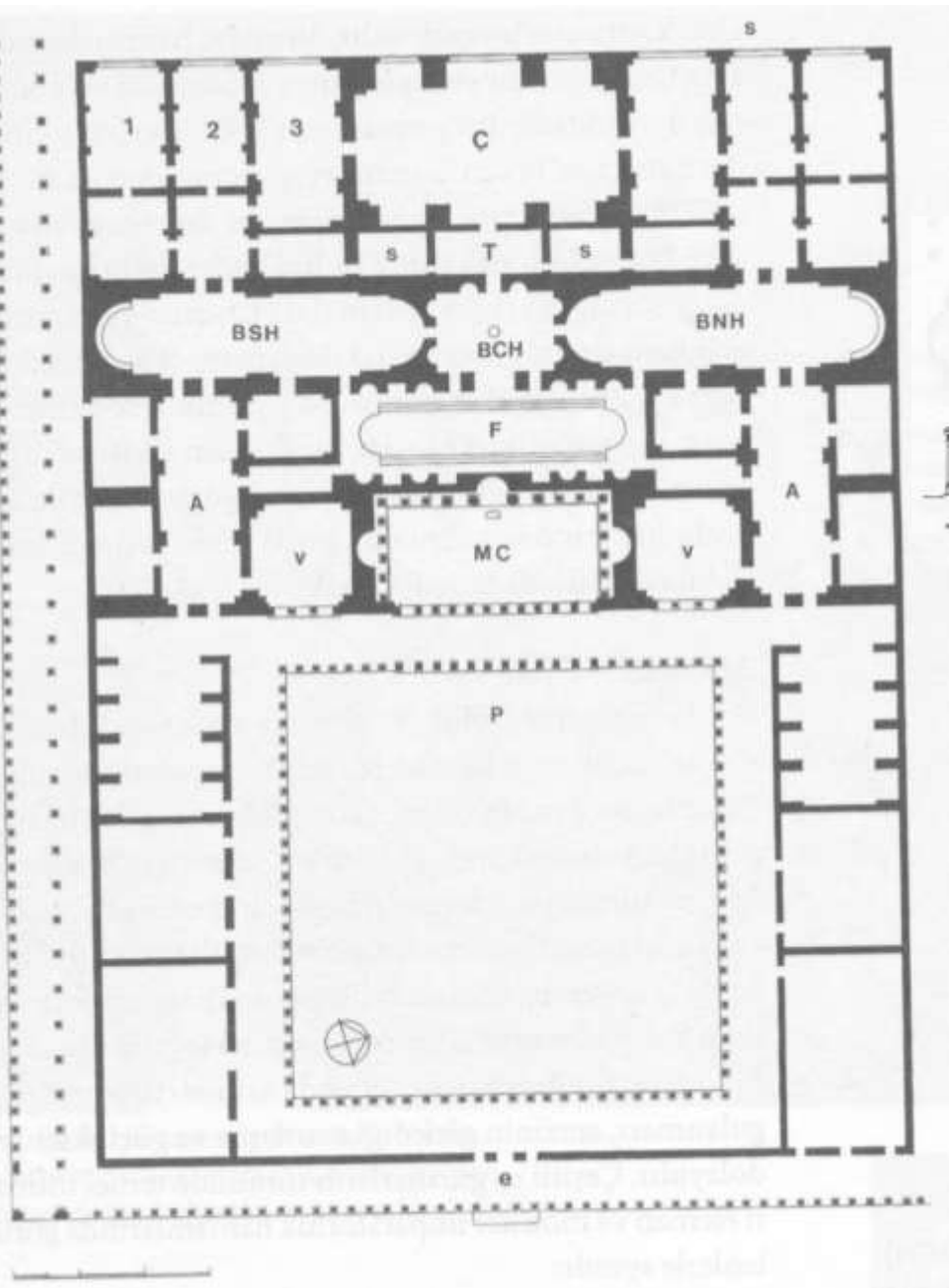

Sardes – Hamam-Gym.

Aezanoi – Hamam-Gym.

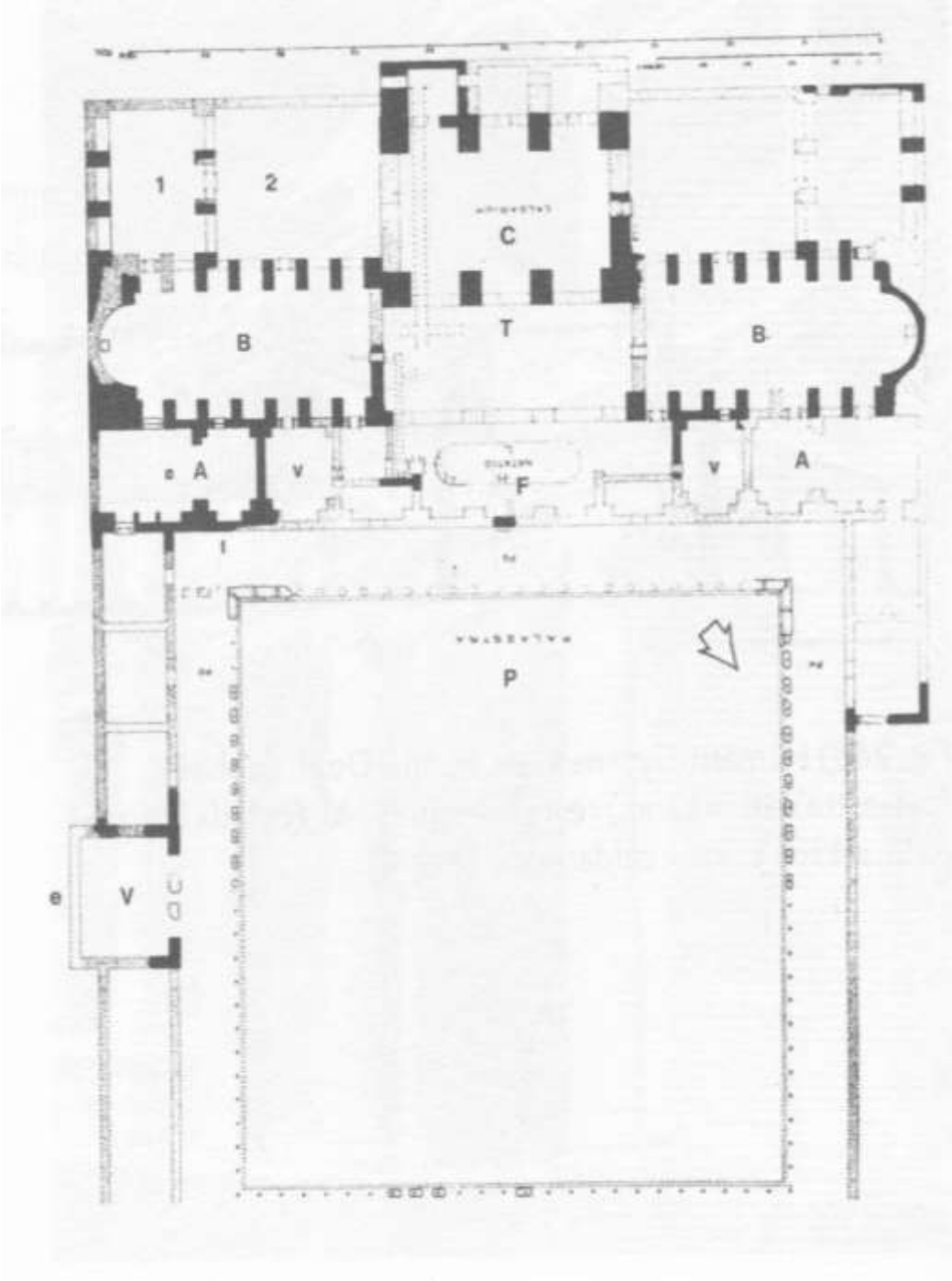

Anadolu Hamam – Gym. Asimetrik tipler

**Pergamon – Yukarı Gymnasion Batı ve Doğu
Hamamları**

Ephesos – Varius - Scholastica Hamamları

Miletos - Faustina Hamamları

Aspendos – Büyük, Küçük Hamamlar

Side – Agora Hamamları

Perge – Güney (kent) kapısı hamamları

Sagalassos – Roma hamamları

Oenoanda, Patara, Arykanda, Tlos

Dağlık Kilikia Hamamları

Pergamon – Yukarı Gymnasion Batı ve Doğu Hamamları

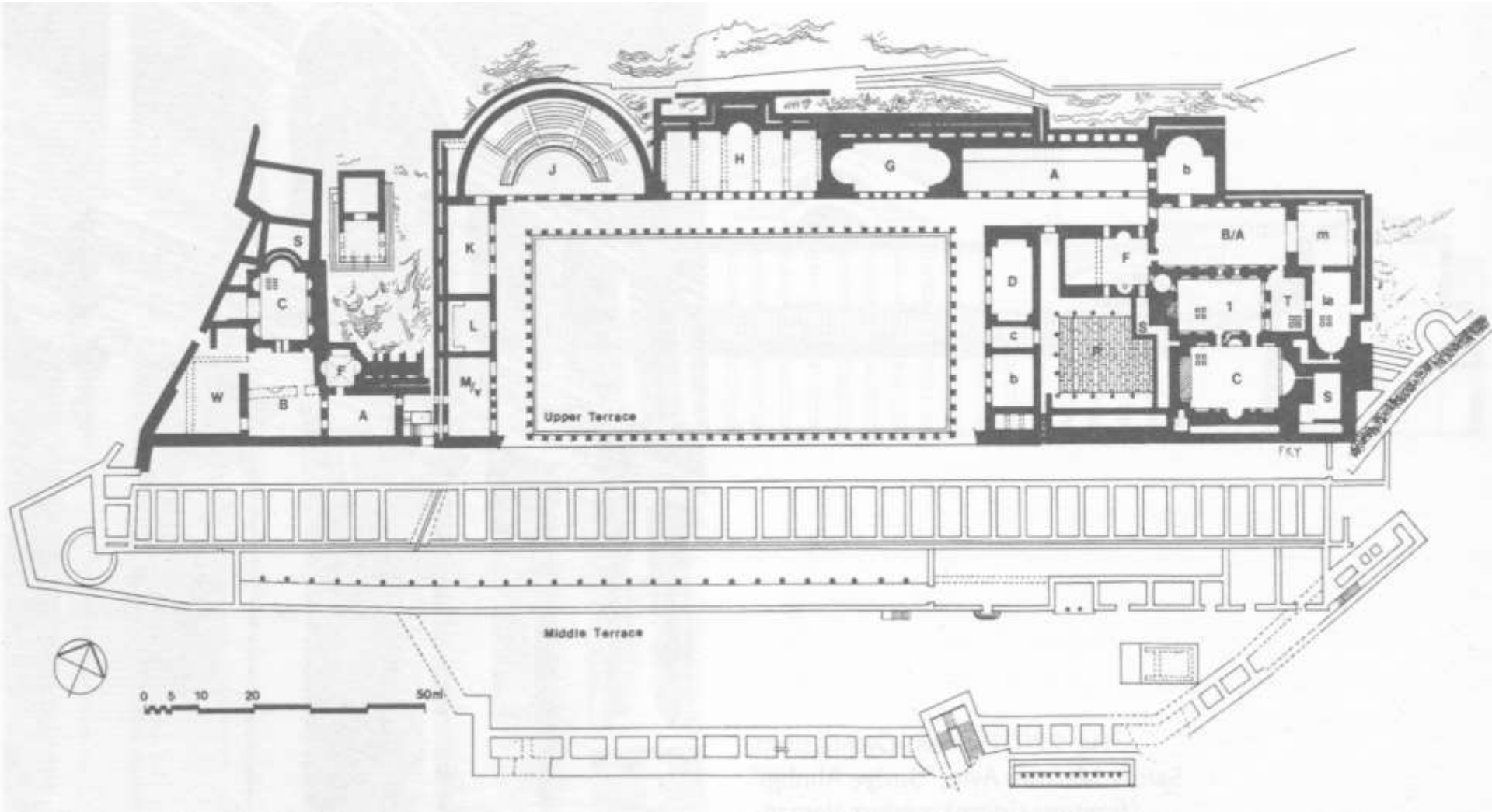

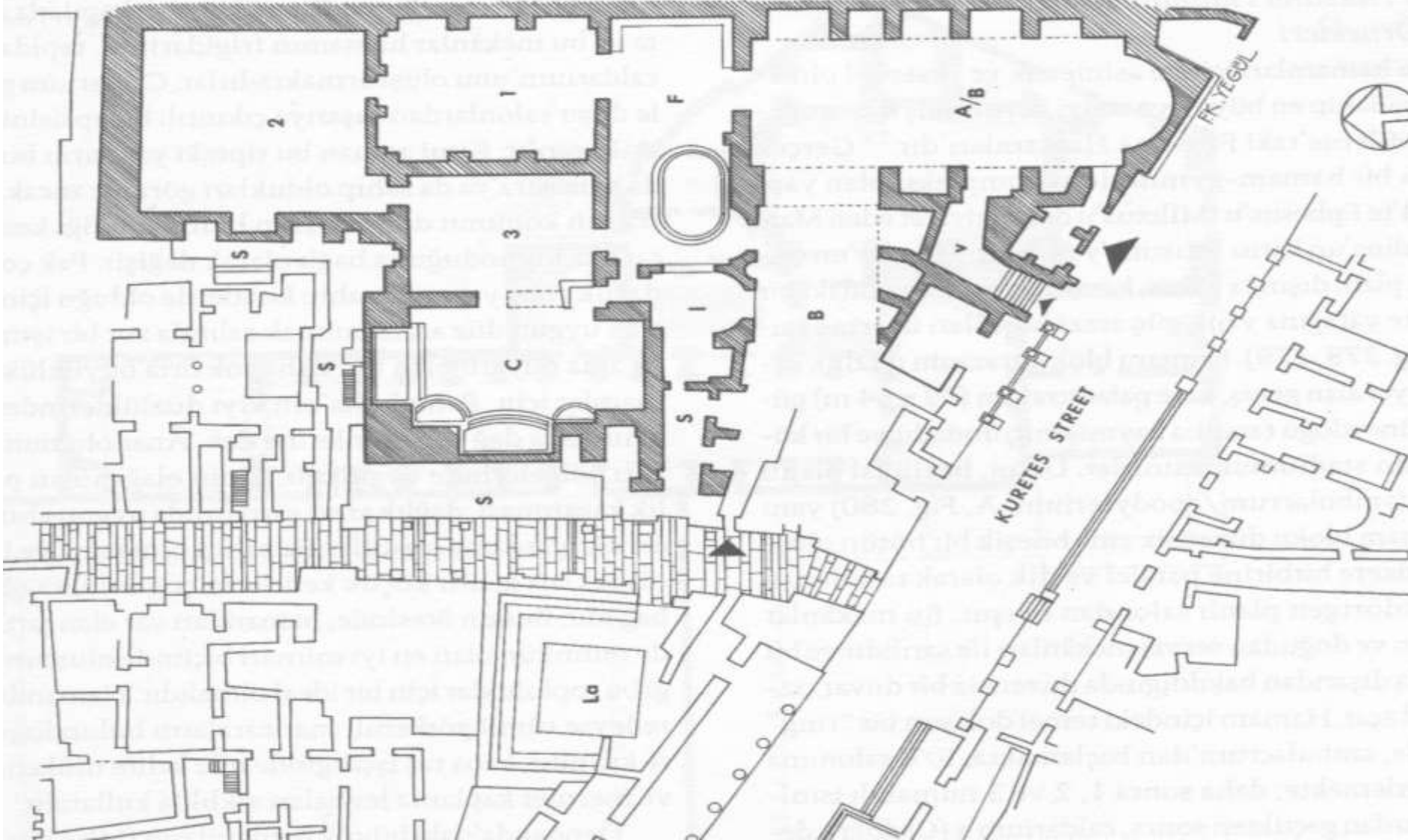

Ephesos – Varius - Scholastica Hamamları

Miletos - Faustina Hamamları

