

PRT 203 – ÖNTARİHTE EGE ARKEOLOJİSİ

Prof. Dr. Vasıf Şahoğlu
Ankara Üniversitesi, Mayıs 2020

Ders 13 : Girit – Minos Kültürü

1/2



Ankara Üniversitesi

Dil ve Tarih – Coğrafya Fakültesi

Arkeoloji Bölümü

Protohistorya ve Önasya Arkeolojisi Anabilim Dalı

MÖ 2. Bin'in İlk Yarisında Girit

GİRİT MİNOS KÜLTÜRÜ

MINOAN CRETE

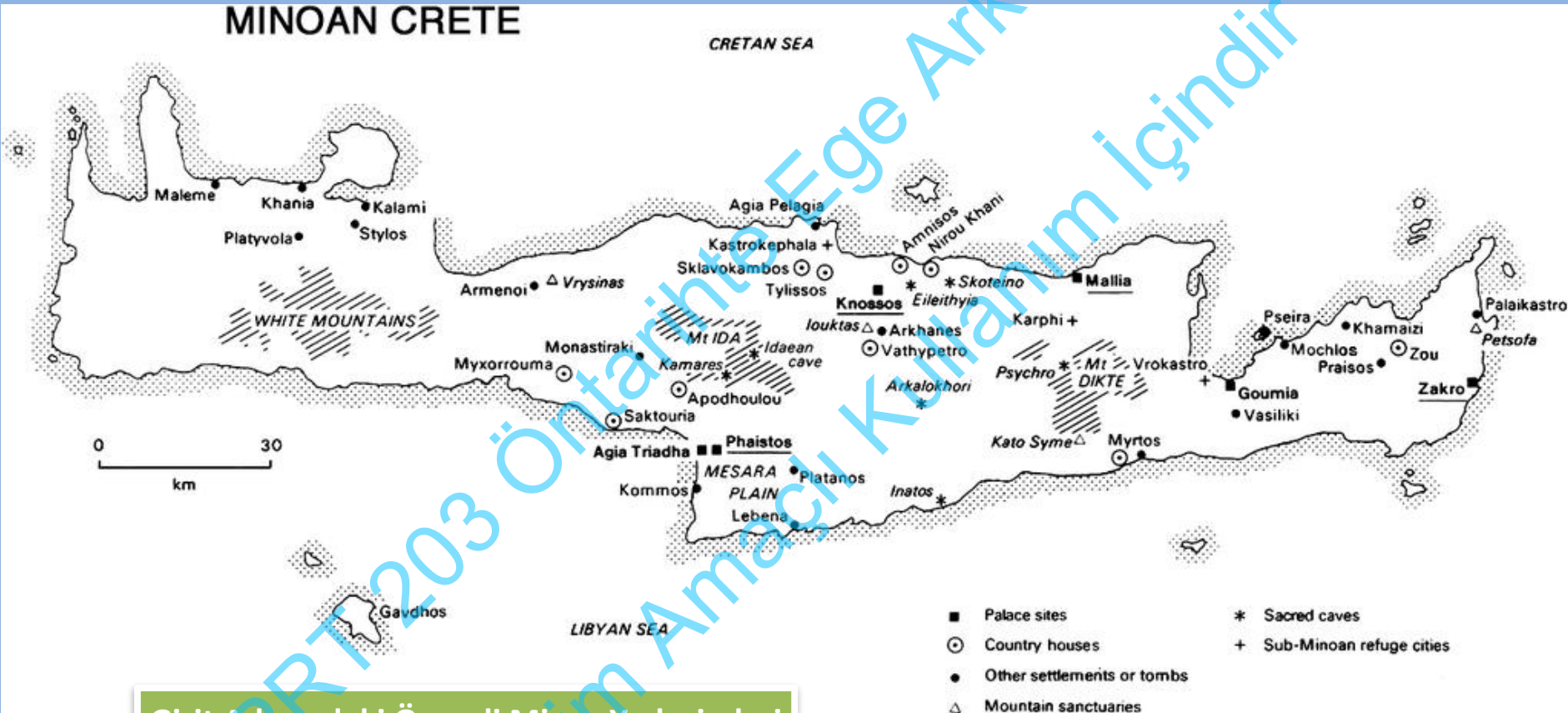

Girit Adasındaki Önemli Minos Yerleşimleri

MÖ 2. Bin'in İlk Yarısında Girit

GİRİT MİNOS KÜLTÜRÜ



Girit Adasındaki Önemli Minos Yerleşimleri

Minoan Crete

- Palaces sites
- Country houses
- Tombs or other settlements
- ★ Sacred caves
- ▲ Mountain sanctuaries

0 10 50 km

www.ancientgreece.com

MÖ 2. Bin'in İlk Yarisında Girit

GİRİT MİNOS KÜLTÜRÜ

Prepalatial	Early Minoan (EM) I	3100–2700
	Early Minoan IIA	2700–2400
	Early Minoan IIB	2400–2200
	Early Minoan III	2200–2000
Protopalatial ('Old Palace' period)	Middle Minoan (MM) IA	2000–1900
	Middle Minoan IB	1900–1800
	Middle Minoan II	1800–1700
Neopalatial ('New Palace' period)	Middle Minoan III	1700–1600
	Late Minoan (LM) IA	1600–1500 (in 'high', absolute chronology: 1700–1600)
	Late Minoan IB	1500–1450 (1600–1500 in 'high' chronology)
	Late Minoan II–Late Minoan III	1450–1100 (1500–1100 in 'high' chronology)

Girit Adasındaki MÖ 2. Bin Kronolojisi

MÖ 2. Bin'in İlk Yarısında Girit

Girit Adasındaki MÖ 2. Bin Kronolojisi

GİRİT MİNOS KÜLTÜRÜ

CHRONOLOGICAL OVERVIEW: THE AEGEAN BRONZE AGE

PERIOD	LOW DATES	HIGH DATES	CRETE	MAINLAND	CYCLADES
Early Bronze Age	before 3000–c. 2000		Early Minoan I (EM I)	Early Helladic (EH I)	Grotta-Pelos
			Early Minoan II (EM II)	Early Helladic (EH II)	Keros-Syros (Kastri Group)
			Early Minoan III (EM III)	Early Helladic (EH III)	Phylakopi I
Middle Bronze Age	c. 2000–c. 1625	c. 2000–c. 1725	Middle Minoan IA (MM IA)	Middle Helladic I–III (MH I–III)	Middle Cycladic (MC)
			Middle Minoan IB (MM IB)		
			Middle Minoan IIA (MM IIA)		
			Middle Minoan IIB (MM IIB)		
			Middle Minoan IIIA (MM IIIA)		
			Middle Minoan IIIB (MM IIIB)		
Late Bronze Age	c. 1625–c. 1525	c. 1725–c. 1600	Late Minoan IA (LM IA)	Late Helladic I (LH I)	Late Cycladic IA (LC IA)
	c. 1525–c. 1450	c. 1620–c. 1450	Late Minoan IB (LM IB)	Late Helladic IIA (LH IIA)	Late Cycladic IB (LC IB)
Late Bronze Age	c. 1450–c. 1420		Late Minoan II (LM II)	Late Helladic IIB (LH IIB)	Late Cycladic II (LC II)
	c. 1420–c. 1300		Late Minoan IIIA (LM IIIA)	Late Helladic IIIA (LH IIIA)	Late Cycladic IIIA (LC IIIA)
	c. 1300–c. 1200		Late Minoan IIIB (LM IIIB)	Late Helladic IIIB (LH IIIB)	Late Cycladic IIIB (LC IIIB)
POST-PALATIAL					

FIRST PALACE PERIOD

SECOND PALACE PERIOD

THIRD PALACE PERIOD

POST-PALATIAL

MÖ 2. Bin'in İlk Yarısında Girit

GİRİT MİNOS KÜLTÜRÜ

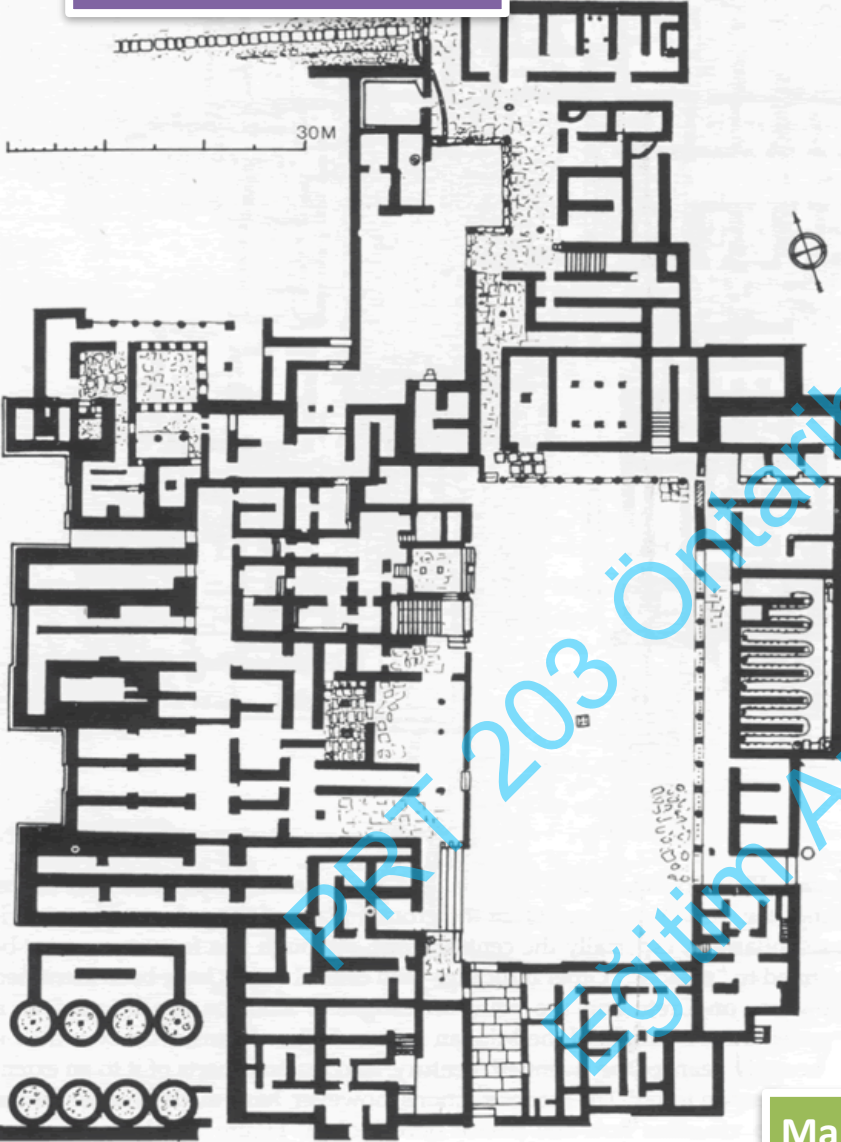

Malia Sarayı

MÖ 2. Bin'in İlk Yarısında Girit

GİRİT MİNOS KÜLTÜRÜ



Malia Sarayı

MÖ 2. Bin'in İlk
Yarısında Girit

GİRİT MİNOS KÜLTÜRÜ



MÖ 2. Bin'in İlk Yarısında Girit

GİRİT MİNOS KÜLTÜRÜ



Phaistos Sarayı

MÖ 2. Bin'in İlk
Yarısında Girit

GİRİT MİNOS KÜLTÜRÜ



Phaistos Sarayı

MÖ 2. Bin'in İlk Yarısında Girit

GİRİT MİNOS KÜLTÜRÜ



Phaistos Sarayı

MÖ 2. Bin'in İlk
Yarısında Girit

GİRİT MİNOS KÜLTÜRÜ



Zagros Sarayı Dağ Kristali Vazo



Zagros Sarayı, Steatit Vazo

MÖ 2. Bin'in İlk Yarısında Girit

GİRİT MİNOS KÜLTÜRÜ

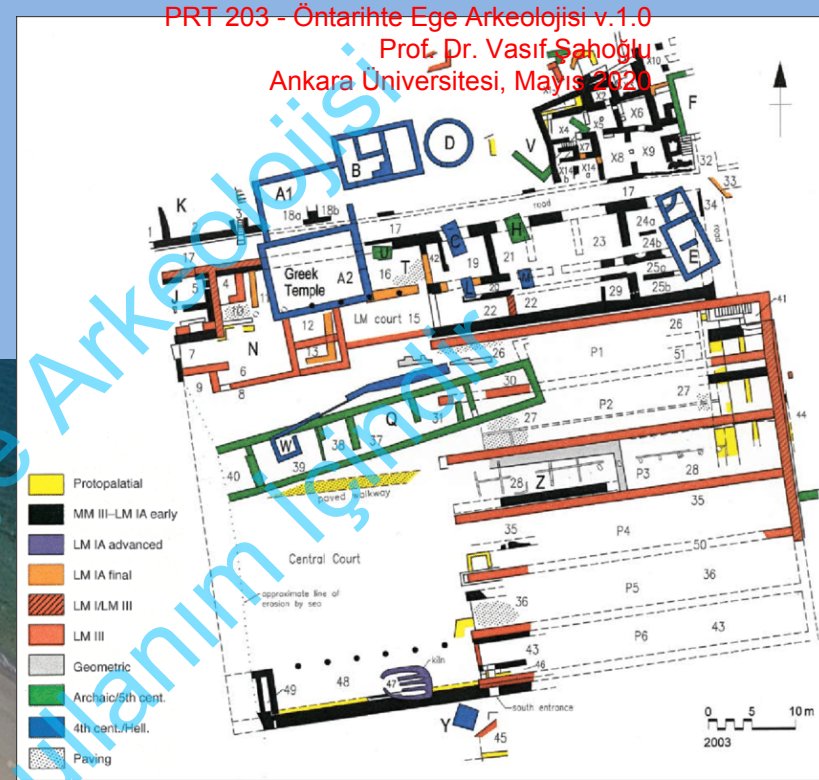

Kommos Liman Kenti

MÖ 2. Bin'in İlk Yarısında Girit

GİRİT MİNOS KÜLTÜRÜ

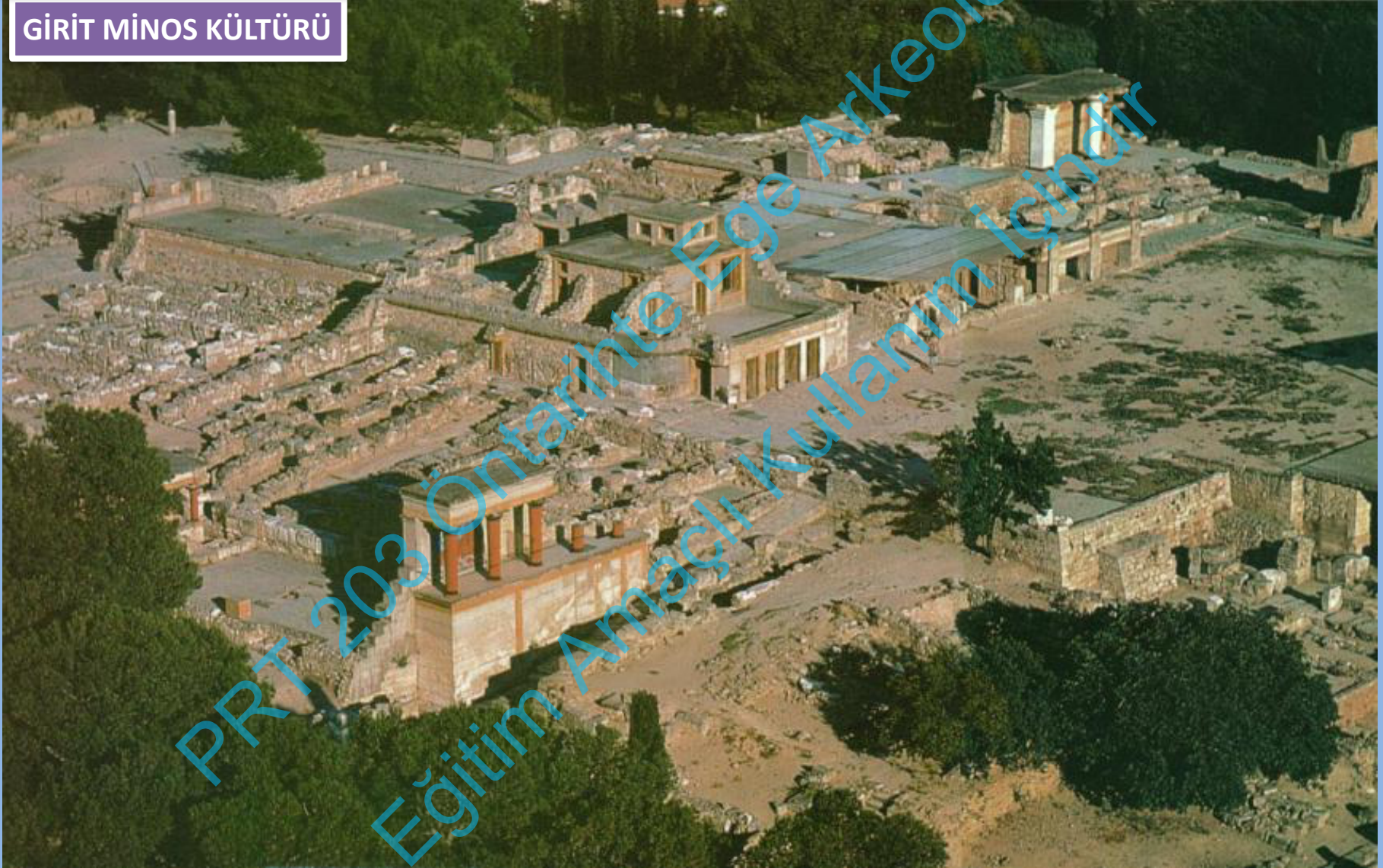

Knossos Sarayı

MÖ 2. Bin'in İlk Yarısında Girit

GİRİT MİNOS KÜLTÜRÜ

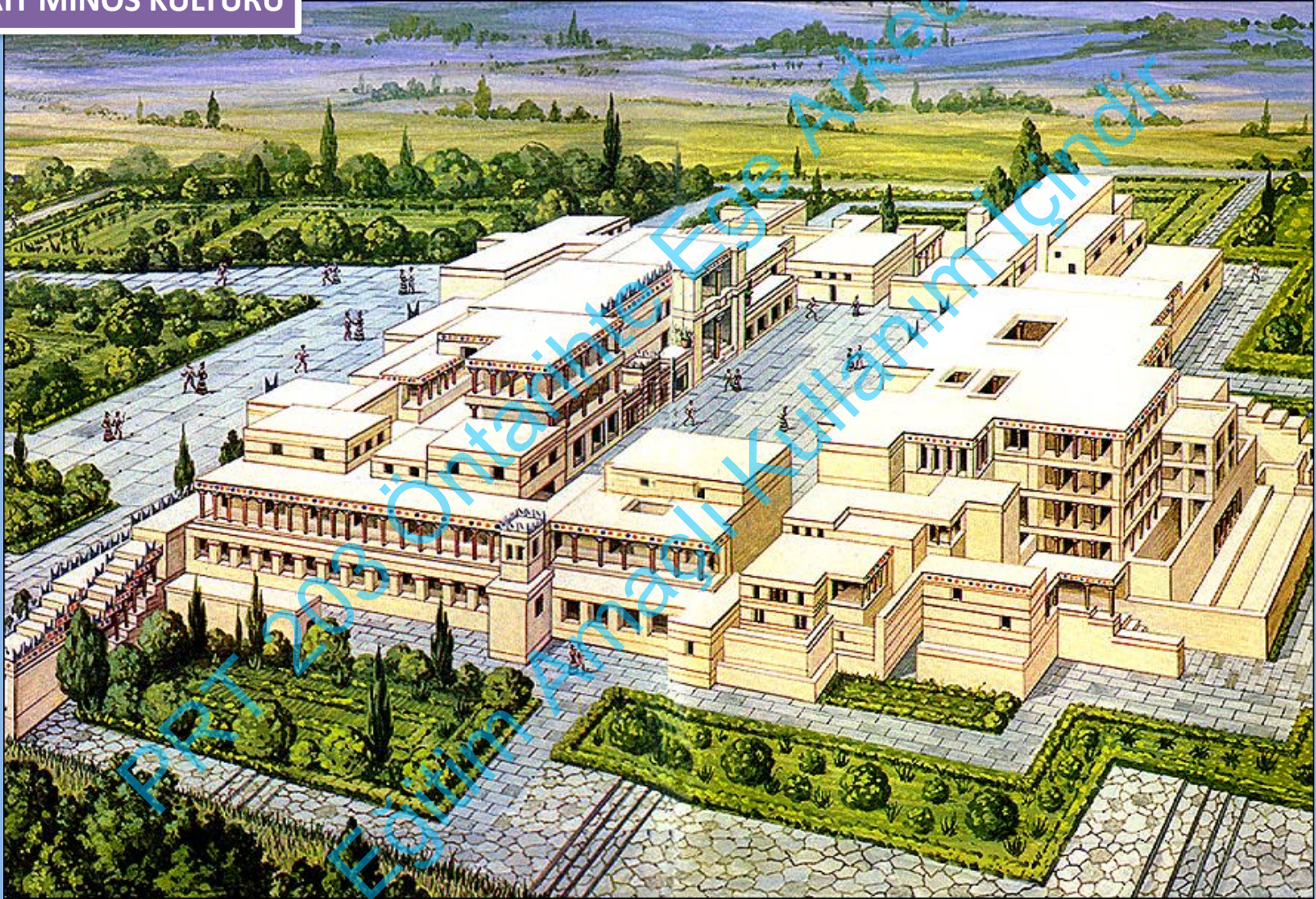

Knossos Sarayı Canlandırma

MÖ 2. Bin'in İlk Yarısında Girit

GİRİT MİNOS KÜLTÜRÜ

Knossos Sarayı

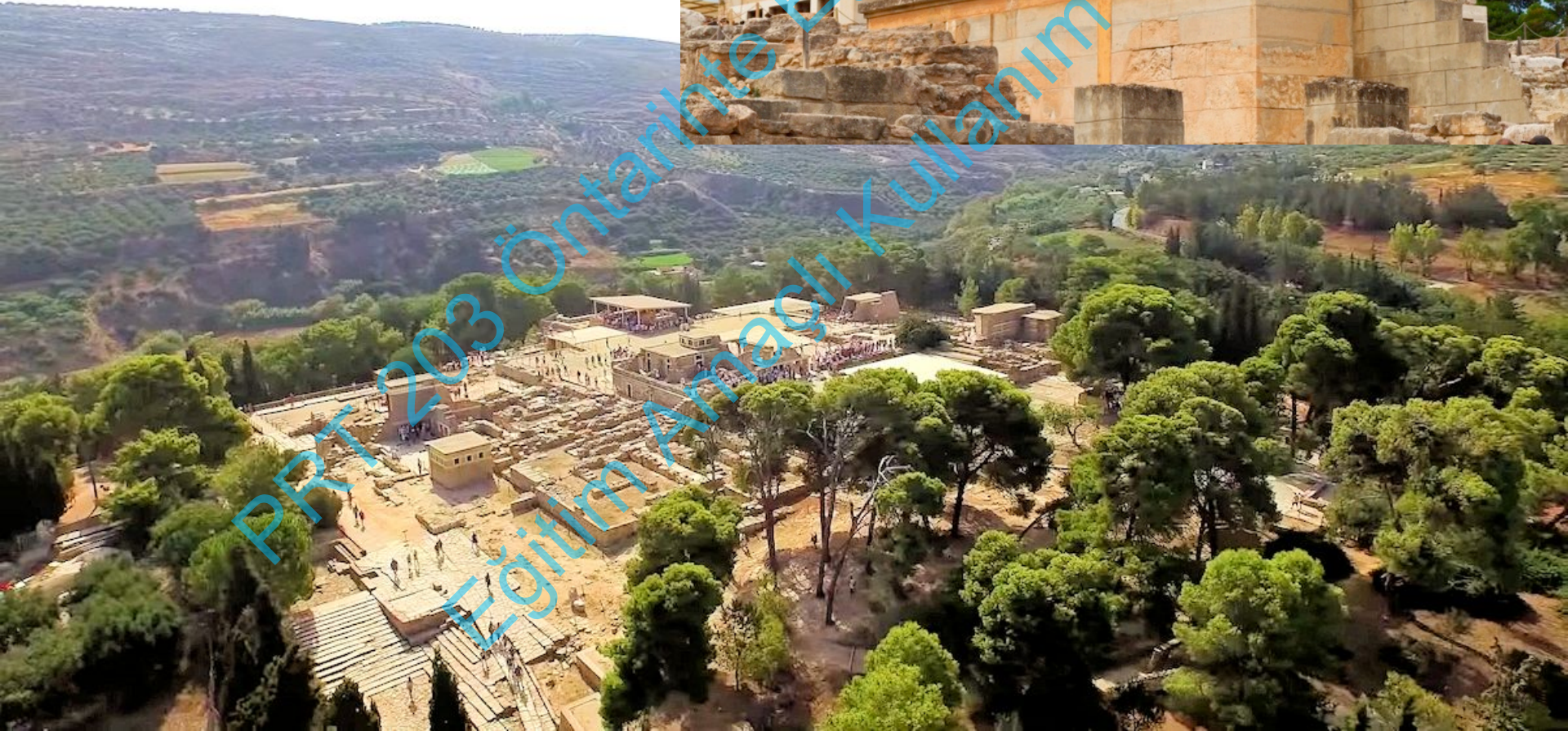

MÖ 2. Bin'in İlk Yarısında Girit

GİRİT MİNOS KÜLTÜRÜ

Knossos Sarayı

KNOSSOS

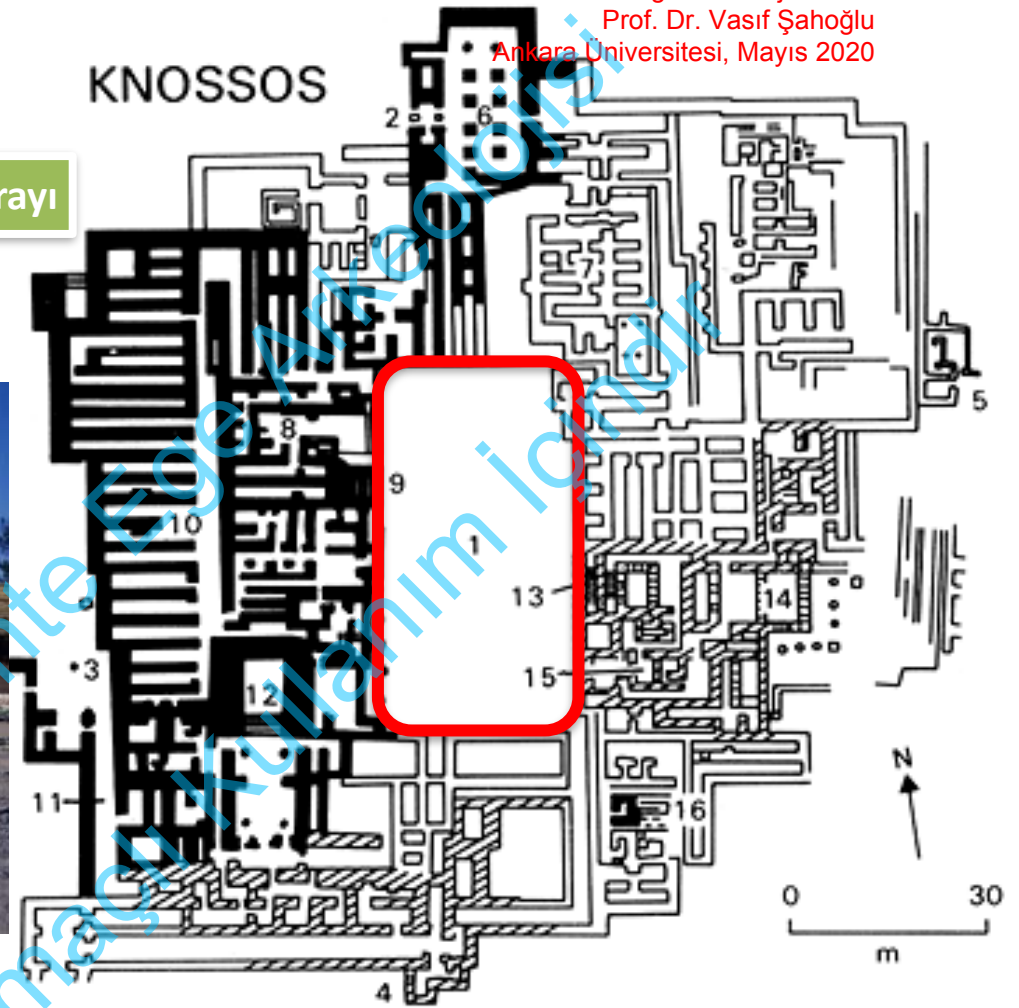

Knossos Saray Merkezi Avlusu

- | | | |
|------------------|-------------------------------|---|
| 1 Central Court | 7 North-east Magazines | 13 Grand staircase to residential quarters |
| 2 North entrance | 8 Throne Room | 14 Main room of the Hall of the Double Axes |
| 3 West entrance | 9 Stairway to upper floor | 15 Treasure chamber |
| 4 South entrance | 10 West Magazines | 16 Shrine of the Double Axes |
| 5 East entrance | 11 Corridor of the Procession | |
| 6 Pillared hall | 12 Stairway to upper floor | |

— Walls in use at the time of the destruction : Central Court

▨ Walls in use at the time of the destruction : lower levels

MÖ 2. Bin'in İlk Yarısında Girit

GİRİT MİNOS KÜLTÜRÜ



Knossos Sarayı, Batı Verandadan Batı Avluya Bakış

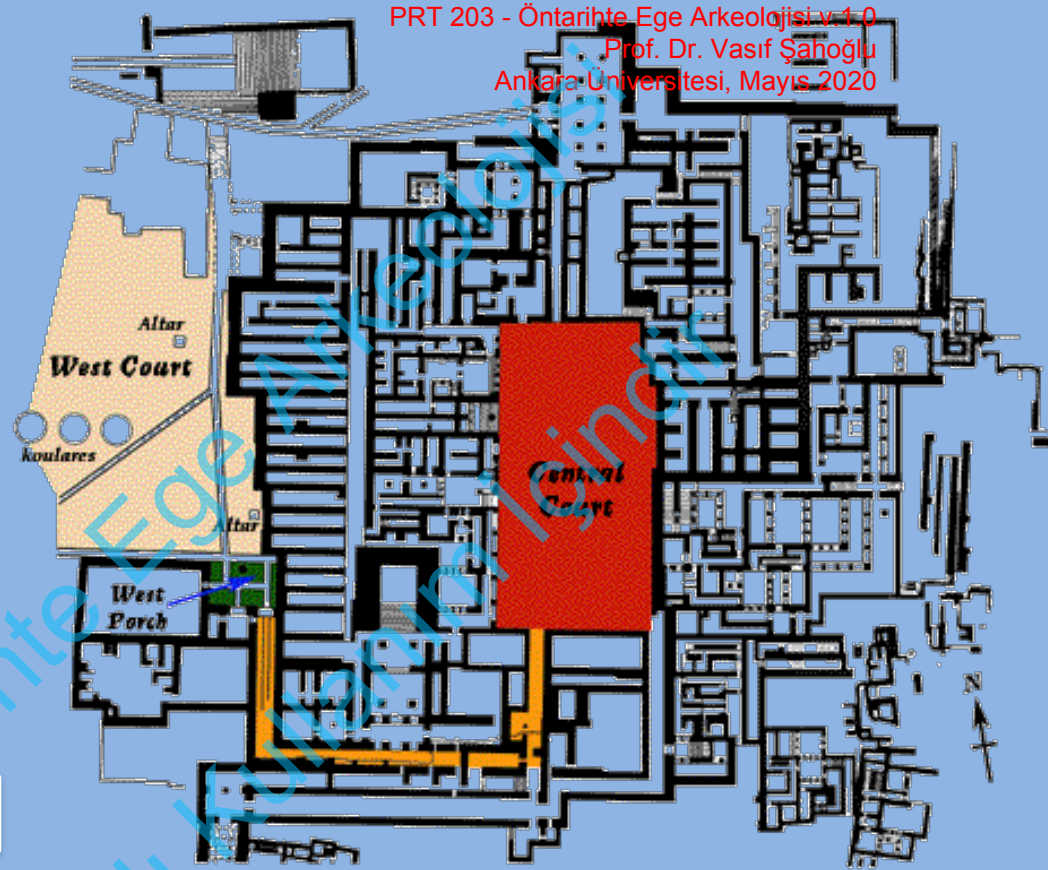

Knossos Sarayı, Batı Veranda ve Sarayın Girişi

Knossos Sarayı, Törensel Geçiş Koridorundan Duvar Freski



MÖ 2. Bin'in İlk Yarısında Girit

GİRİT MİNOS KÜLTÜRÜ



Knossos Sarayı, Törensel Geçiş Koridorunun altındaki odadan 'Prince of Lillies' Duvar Freskosu



Knossos Sarayı, Güney Propyleumdan 'Cup bearers' Freskosu

MÖ 2. Bin'in İlk Yarısında Girit

GİRİT MİNOS KÜLTÜRÜ

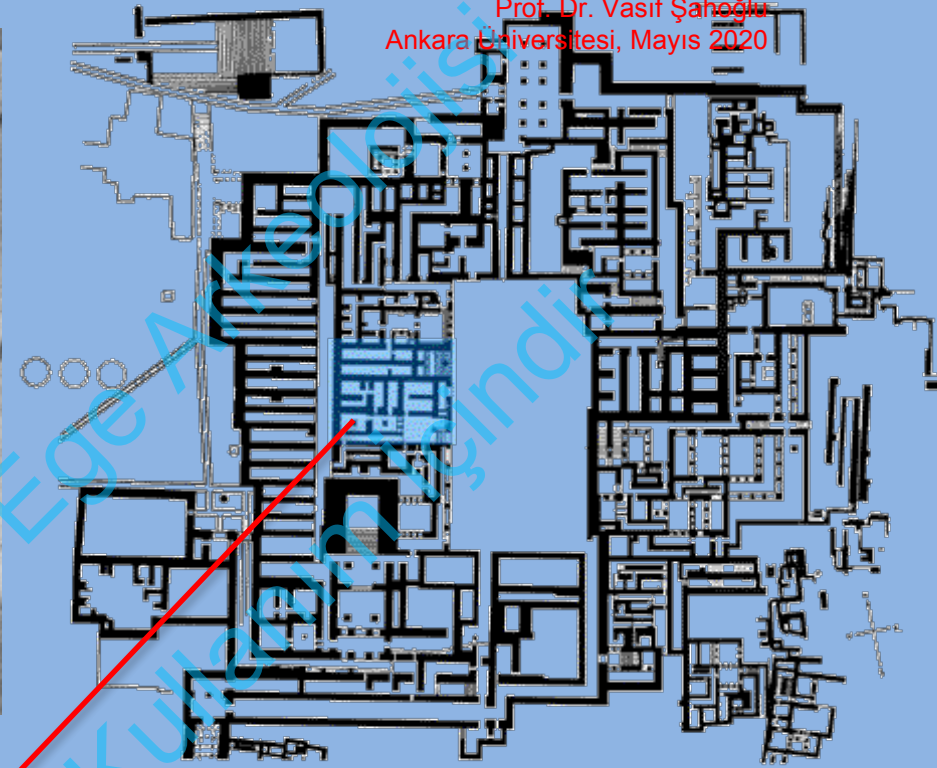

Knossos Sarayı, Batı Kanattaki Kült Mekanları

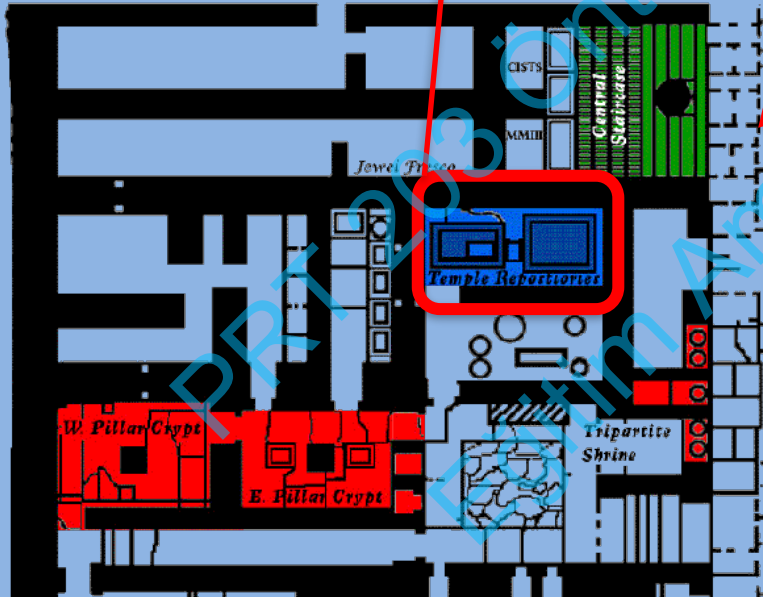

MÖ 2. Bin'in İlk Yarısında Girit

GİRİT MİNOS KÜLTÜRÜ

Knossos Sarayı, Batı Kanadı, Depo Odaları

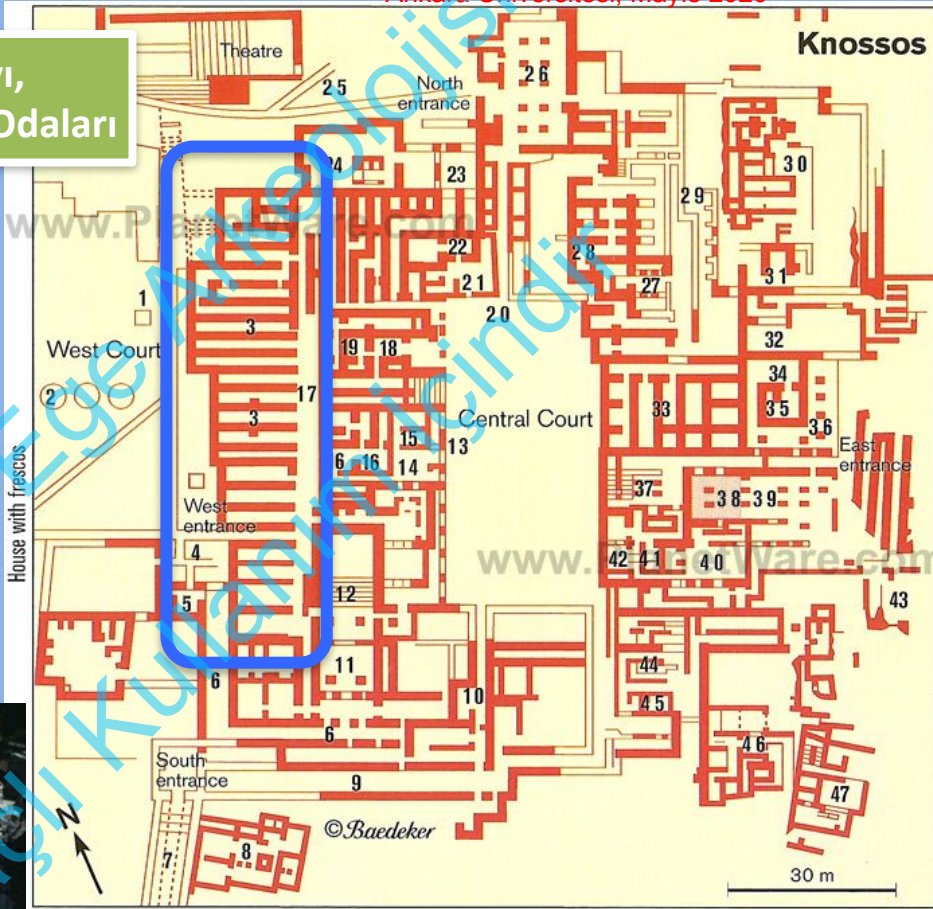

- | | | |
|-------------------------|---------------------------|--------------------------------|
| 1 Altar base | 17 Storeroom corridor | 33 Room with water basin |
| 2 Circular pits | 18 Throne room | 34 Potter's workshops |
| 3 Storerooms | 19 Cult chamber | 35 Stone cutter's workshop |
| 4 West Propylaea | 20 North ramp | 36 East veranda |
| 5 Guard room | 21 Prison | 37 Staircase |
| 6 Processional corridor | 22 Cult chamber | 38 Hall of Double Axes |
| 7 Columned staircase | 23 North-west Propylaea | 39 King's Megaron |
| 8 South House | 24 Cult area | 40 Queen's Megaron |
| 9 South corridor | 25 Royal Road | 41 Queen's Bathroom |
| 10 Corridor | 26 Custom House | 42 Queen's Dressing Room |
| 11 South Propylaea | 27 North-east Hall | 43 Eastern bastions |
| 12 Staircase | 28 North-east storerooms | 44 Shrine of Double Axes |
| 13 Shrine | 29 Potter's workshops (?) | 45 Lustral basin |
| 14 Antechamber | 30 Potter's workshops | 46 House of the Chancel Screen |
| 15 Central shrine | 31 Storeroom | 47 South-east House |
| 16 Pillar crypt | 32 Light well | |

MÖ 2. Bin'in İlk Yarısında Girit

GİRİT MİNOS KÜLTÜRÜ

Knossos Sarayı, İkamet Kısmı

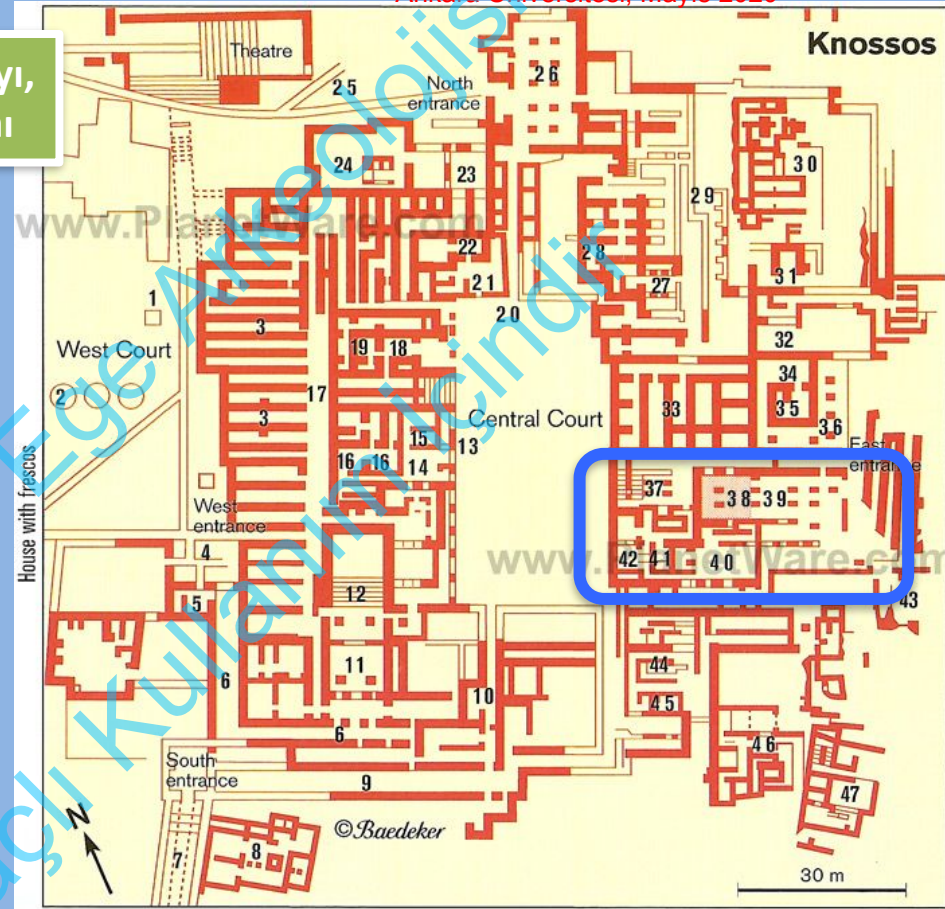
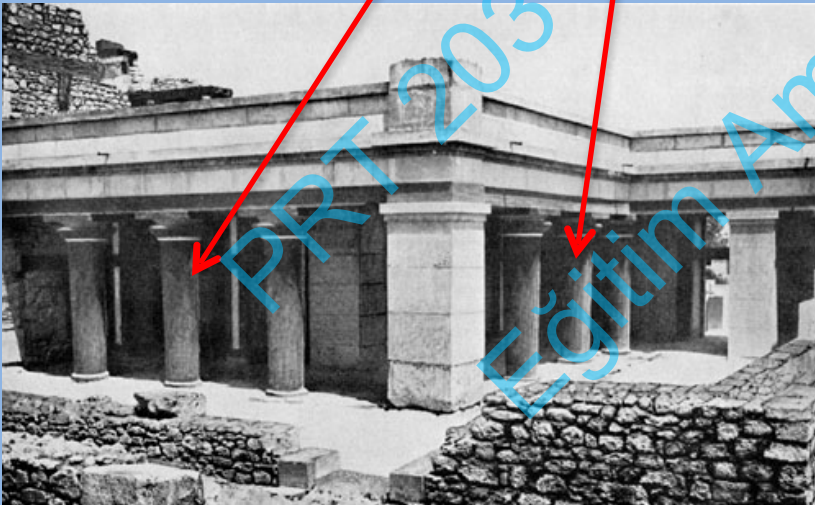
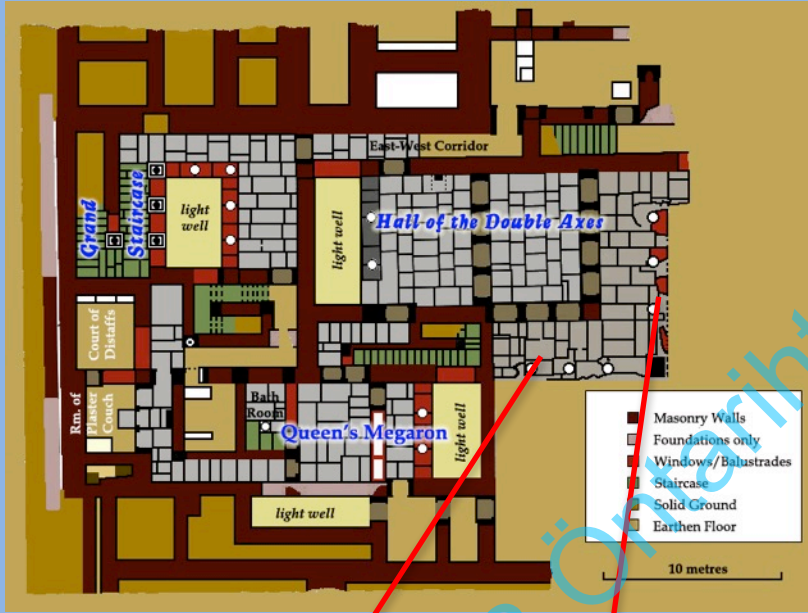

- | | | |
|-------------------------|---------------------------|--------------------------------|
| 1 Altar base | 17 Storeroom corridor | 33 Room with water basin |
| 2 Circular pits | 18 Throne room | 34 Potter's workshops |
| 3 Storerooms | 19 Cult chamber | 35 Stone cutter's workshop |
| 4 West Propylaea | 20 North ramp | 36 East veranda |
| 5 Guard room | 21 Prison | 37 Staircase |
| 6 Processional corridor | 22 Cult chamber | 38 Hall of Double Axes |
| 7 Columned staircase | 23 North-west Propylaea | 39 King's Megaron |
| 8 South House | 24 Cult area | 40 Queen's Megaron |
| 9 South corridor | 25 Royal Road | 41 Queen's Bathroom |
| 10 Corridor | 26 Custom House | 42 Queen's Dressing Room |
| 11 South Propylaea | 27 North-east Hall | 43 Eastern bastions |
| 12 Staircase | 28 North-east storerooms | 44 Shrine of Double Axes |
| 13 Shrine | 29 Potter's workshops (?) | 45 Lustral basin |
| 14 Antechamber | 30 Potter's workshops | 46 House of the Chancel Screen |
| 15 Central shrine | 31 Storeroom | 47 South-east House |
| 16 Pillar crypt | 32 Light well | |

MÖ 2. Bin'in İlk Yarısında Girit

GİRİT MİNOS KÜLTÜRÜ

Knossos Sarayı, Çift Ağızlı Balta Salonu

PRT 203 - Öntarihte Ege Arkeolojisi v.1.0
Prof. Dr. Vasıf Şahoğlu
Ankara Üniversitesi, Mayıs 2020

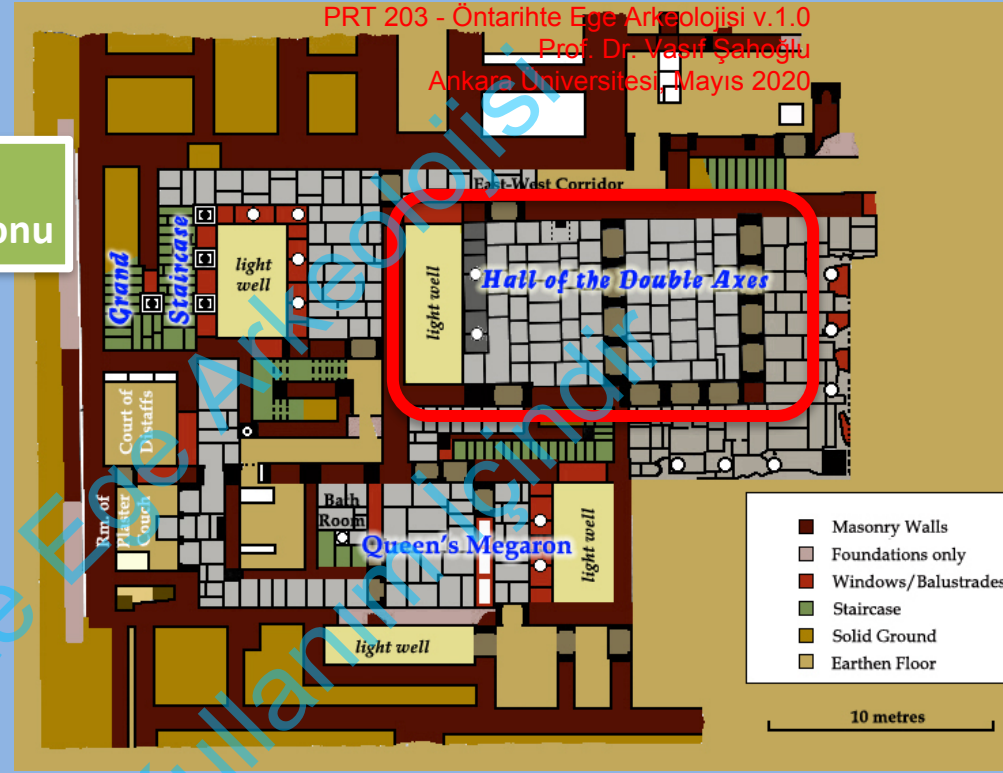

MÖ 2. Bin'in İlk Yarisında Girit

GİRİT MİNOS KÜLTÜRÜ

Knossos Sarayı, Kraliçenin Megaronu

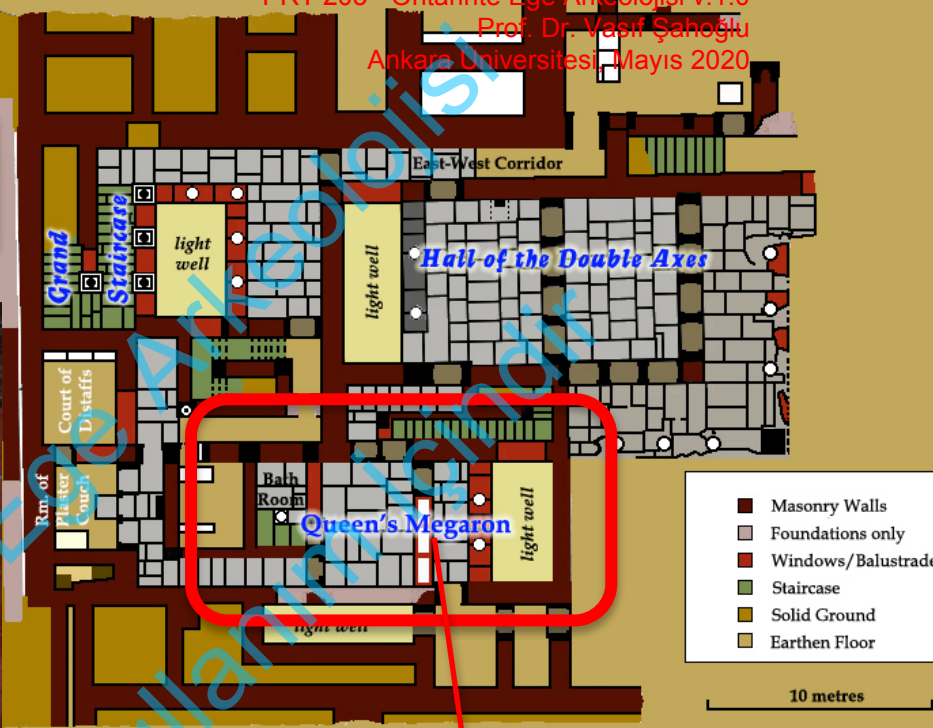

PRT 203 Öntarihte Ege Arkeolojisi
Eğitim Amacı Kullanılmamalıdır

MÖ 2. Bin'in İlk Yarısında Girit

GİRİT MİNOS KÜLTÜRÜ

Knossos Sarayı, Büyük Merdiven ve Aydınlık Alanı

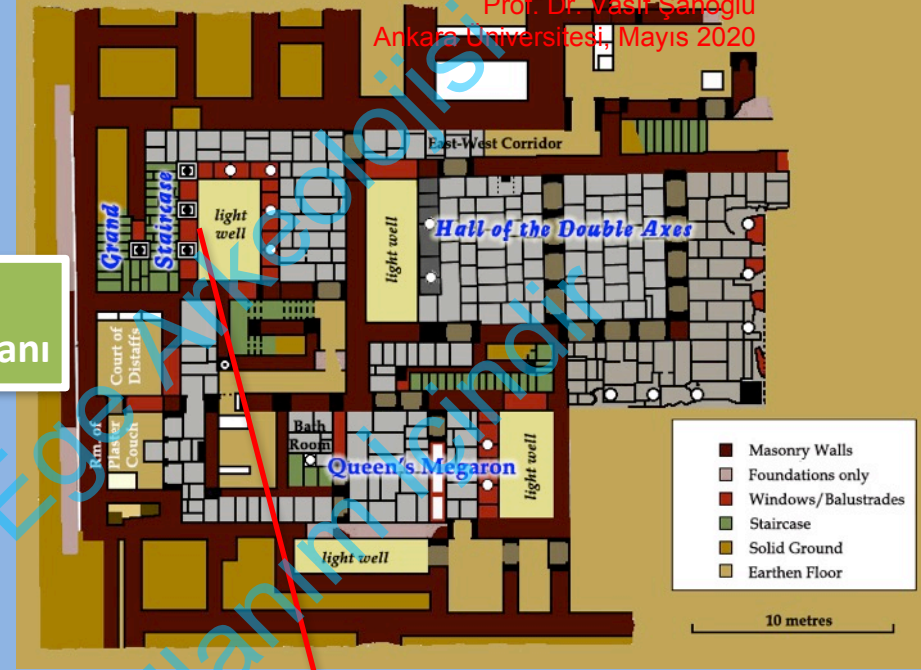

Knossos Sarayı, Kraliçenin Salonundan Fresko

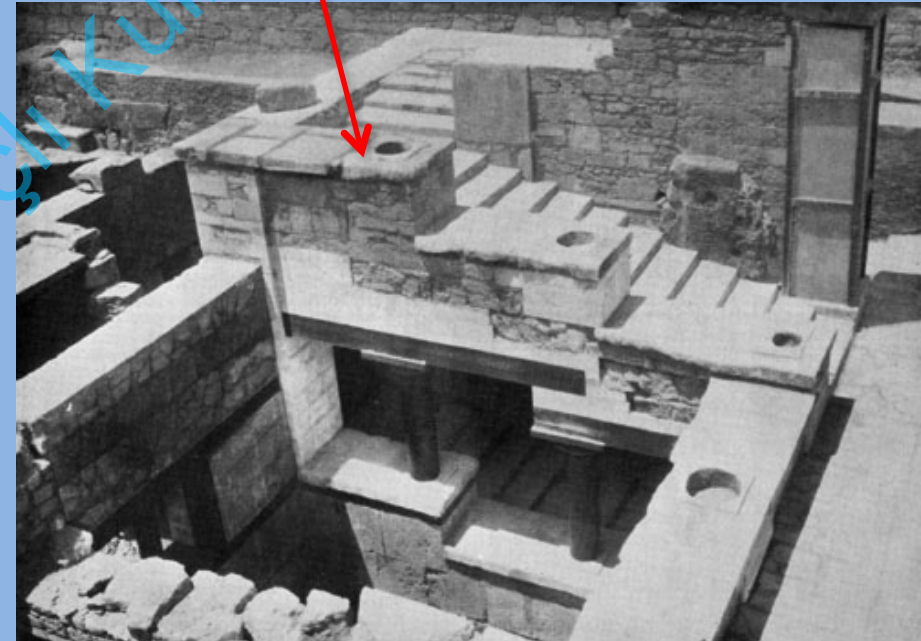

MÖ 2. Bin'in İlk
Yarısında Girit

GİRİT MİNOS KÜLTÜRÜ

Knossos Sarayı,
Kraliçenin Salonundan Fresko

Knossos Sarayı,
Taht Salonu

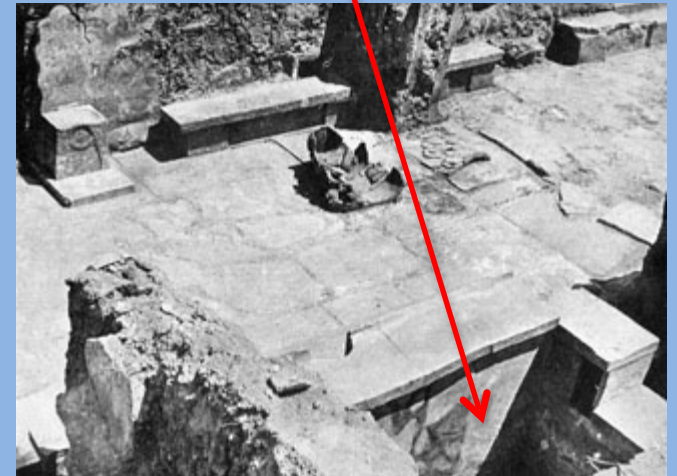
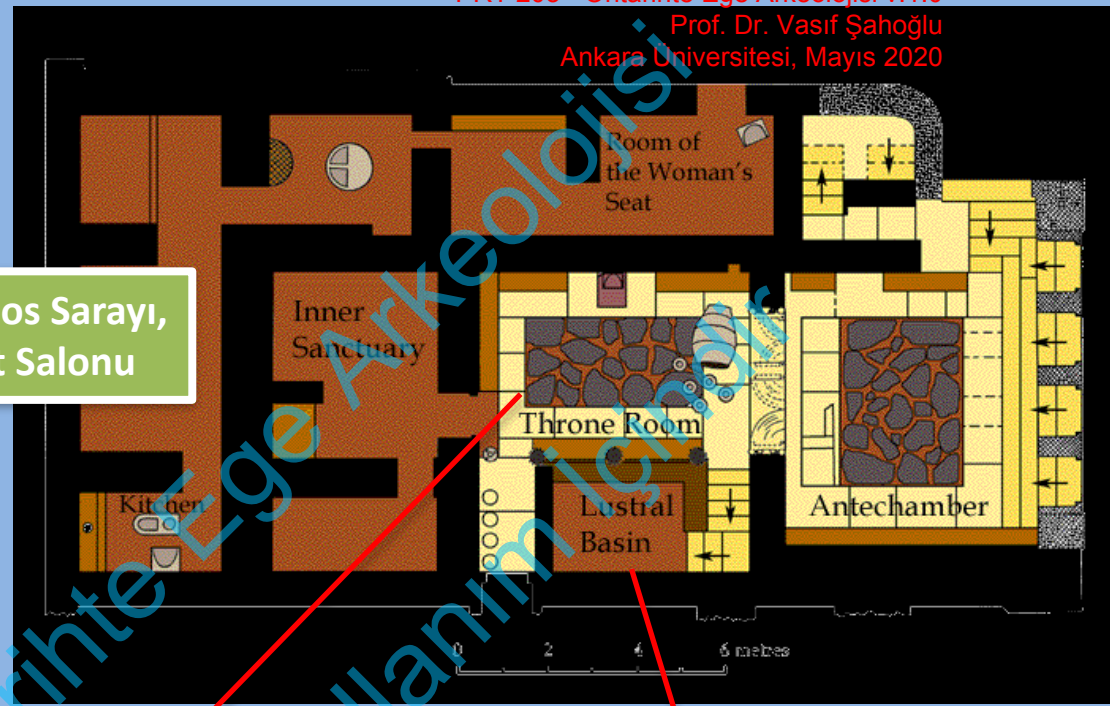

MÖ 2. Bin'in İlk
Yarısında Girit

GİRİT MİNOS KÜLTÜRÜ



Knossos Sarayı, Taht Odası

MÖ 2. Bin'in İlk
Yarısında Girit

GİRİT MİNOS KÜLTÜRÜ



Knossos Sarayı, Taht Odası