

PROJENİZİ NASIL SUNABİLİRSİNİZ?

I.Kaymaz, 2020

Ankara Üniversitesi Ziraat Fakültesi Peyzaj Mimarlığı

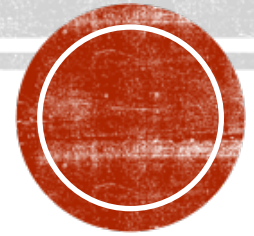

PROJENİZİ SUNUMA HAZIRLARKEN...

- Projeniz siz yanında olmadan da kendini anlatabilmeli.
- Konseptiniz, temanız, fikriniz... açıklanabilir ve anlaşılabilir şekilde sözel ve/veya görsel olarak yer almalı. Bunun için farklı formatlar benimseyebilirsiniz. Resmi kurumlara teslim edilen projelerde genellikle alışlagelen ya da belirlenen standartlar veya beklentiler vardır. Bunlar dışında projenizin sunumunda kullanacağınız teknik size, projenizin detaylarına ve ölçeğine, müşterinize bağlı olarak değişebilir.
- Bu sunum içinde göreceğiniz yalnızca fikir vermesi ve çeşitliliği görmemiz açısından seçilen örneklerdir.
- Tabi ki çizgi kalınlıkları, kullanılan yazı karakteri ve büyüklüğü, renk seçimi gibi konuları önceden çözümlemiş olmalısınız.





PROTOTYPE OF ACTIVITIES

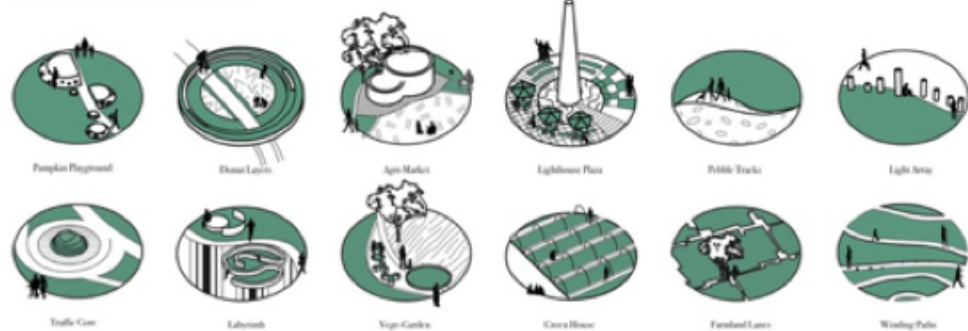

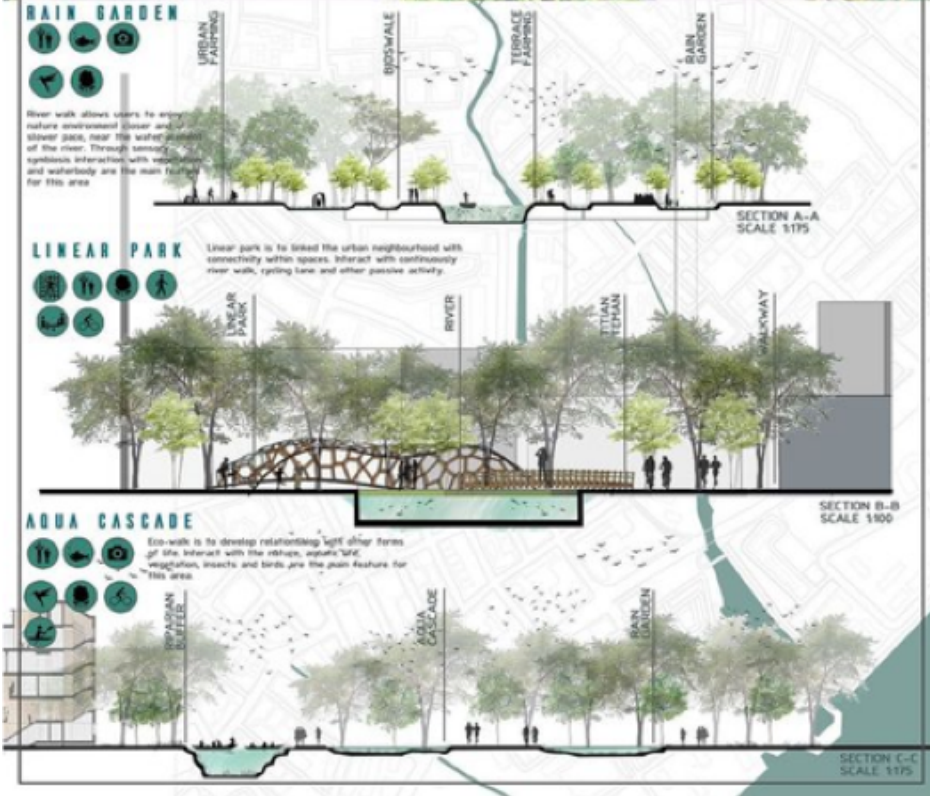

<https://tr.pinterest.com/pin/673780794242154847/>

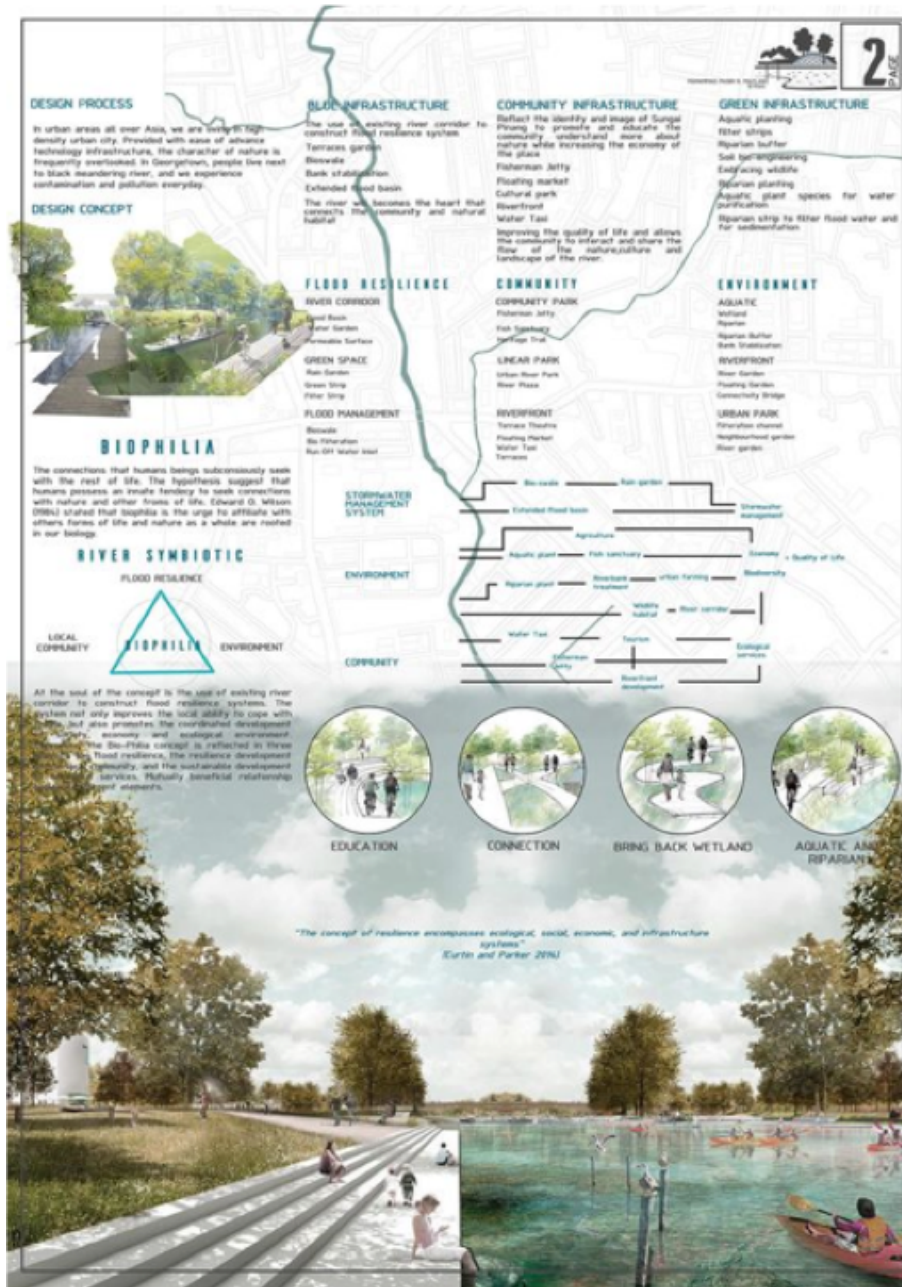

<https://tr.pinterest.com/pin/297167275412340179/>







<https://tr.pinterest.com/pin/556194622711334878/>

<https://tr.pinterest.com/pin/684195368378775576/>



KESİTLER, GÖRÜNÜŞLER VE BİTKİ PALETLERİ

- Tasarımınızı zenginleştiren ve farklı kılan detayları farklı sunum paftaları ile ifade edebilirsiniz.
- Tasarımdaki fikrinizi açıklamada ve karşıdakinin algılamasını sağlamada plandan ziyade kesitler, görüşler, perspektifler etkilidir. Kullanıcının 3. boyutta yaşayacağı deneyimin aktarılması açısından önem taşır.
- Eğer projenizi yalnızca bir grafik çalışması ya da desen çalışması gibi düşündüyseniz, bu aşamada tasarımdaki hatalarınızı siz de fark edeceksinizdir.
- Bitki paletleri ise tasarımınızda kullandığınız bitkinin değişken özelliklerini (yıl boyunca, farklı iklim alanlarında vb.) anlatmada etkilidir.



GARDEN | WINTER

7
6
5
4
3
2
1
0

Aeonium arboreum
Purple Queen
Light full sun
pH Neutral/Alkaline
Soil: Loam, Sand
Water: Average to dry

Agave attenuata
Foxtail Agave
Light full sun/part sun
pH Neutral/Alkaline
Soil: Silty loam
Water: Dry

Aloe e spinosissima
Spider Aloe
Light full sun/part sun
pH Neutral/Alkaline
Soil: Sand
Water: Average to dry

Lycopodium obscurum
Lizard Tail
Light full sun/part sun
pH 5.5 to 7.5
Soil: Humus rich to dry
Water: Average

Furcraea macdougalii
Furcraea
Light full sun, reflected heat
pH: Silty loam
Soil: Silty loam
Water: Dry

james corner field operations | palisades garden walk + town square



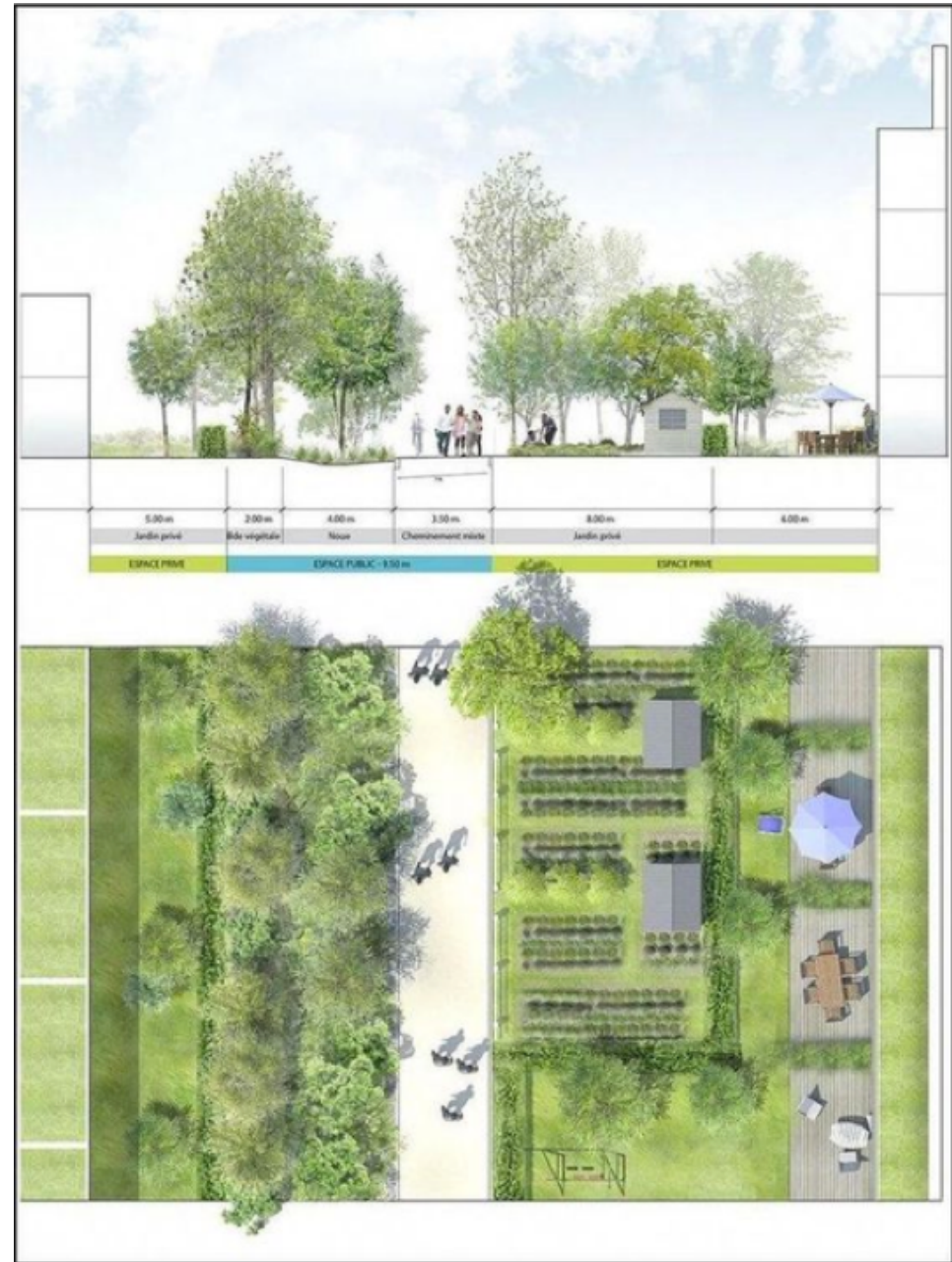
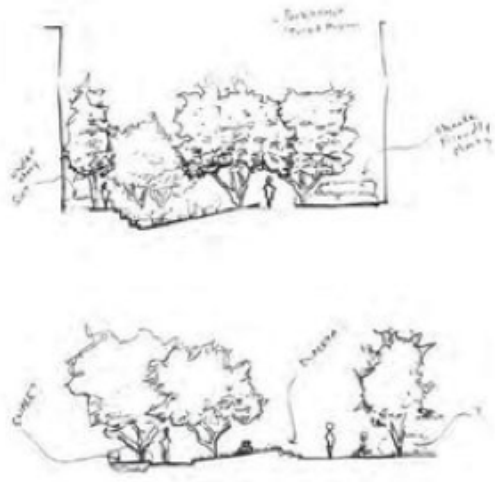
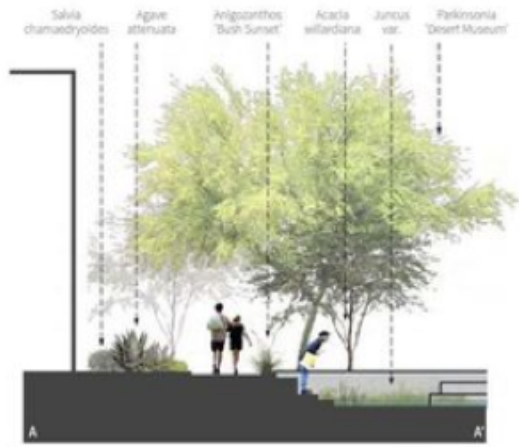

Species Information

Nyssa sylvatica Black Gum

The Black Gum, a woody species, is a slow growing deciduous tree adaptive to many diverse conditions. The species tolerates poorly drained soils and some periods of drought. A long history of characteristics of the species, including damage to nearby pavement, the form of the Black Gum is characterized as a broad, pyramidal or rounded crown. The plant has dark green glabrous leaves, which transition into a striking orange-red color in the fall.

Form / Ave. Size



Selected Images



Ginkgo biloba 'Autumn Gold' Autumn Gold Maidenhair Tree

The 'Autumn Gold' Ginkgo tree is a deciduous conifer that is recognized for its distinctive fan-shaped leaves. The 'Autumn Gold' is an all-male cultivar that grows to approximately 50' tall and takes a broad pyramidal form. Male cultivars, such as the 'Autumn Gold', will not produce the strong and odorous but characteristic of the female Ginkgo. The Ginkgo is tolerant of diverse soil conditions, both compacted and a wide range of soil conditions. This tolerance to adverse conditions makes it an excellent candidate for urban environments. The Ginkgo is especially attractive in the fall when the leaves have a radiant golden-yellow.



Gleditsia triacanthos var. *inermis* 'Skyline' Thornless Honeylocust

The Thornless Honeylocust, a woody species, typical grows into a rounded spreading crown. The 'Skyline' variety is a domestic and widely varying of the Honeylocust. This species is tolerant of a wide range of soil conditions. Honeylocusts are very tolerant of shade, drought, insect pests, and saline conditions making it an excellent candidate for urban areas. The species rarely causes storm and lightning damage, allow for a filtered sunlight effect continuously in the winter. The species seasonal interest lies in its bright yellow fall color.



Acer saccharum 'Green Mountain' Green Mountain Sugar Maple

The Sugar Maple is a woody species which grows with a dense broad pyramidal crown to about 50 to 60' tall. The tree grows to average soil moisture soils, with average moisture levels. The species has no serious health or disease problems. The Sugar Maple has a magnificent fall color with shades of orange and red. This species grows in a moist soil shade tree.



Sample Placement Concept Plan

