

KLA 120
ANTİK MİMARİDE MALZEME - TEKNİK

11. Hafta

KLA 120

ANTİK MİMARİDE MALZEME - TEKNİK

PİŞMİŞ TOPRAK MALZEME :

TUĞLA

ÇATI KİREMİTİ

TUĞLA

Pişmiş toprak yapı malzemesi

Vitruvius tuğlaları şekillerine göre adlandırıldığını söyler:

- 1- Lydia tipi tuğla (1.5x1 ayak – dikdörtgen)
- 2- Pentadoron (beş avuç kare tuğla – kamu yapılarında)
- 3- Tetradoron (dört avuç kare tuğla – özel yapılarda)



Stroter / kiremit : düz, yassı kiremit

kalypther : kapama kiremidi

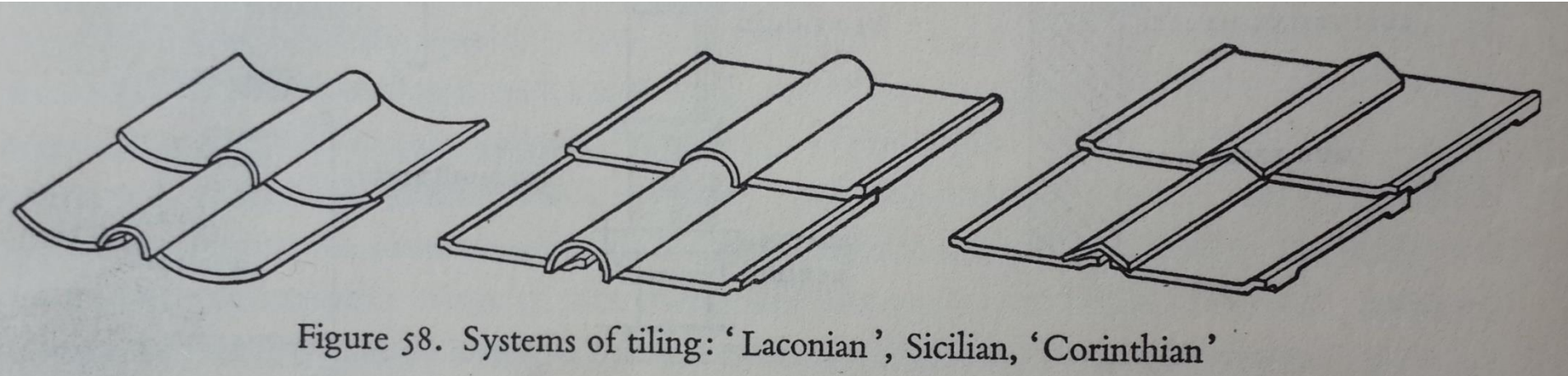

Alaturka Kiremitler.



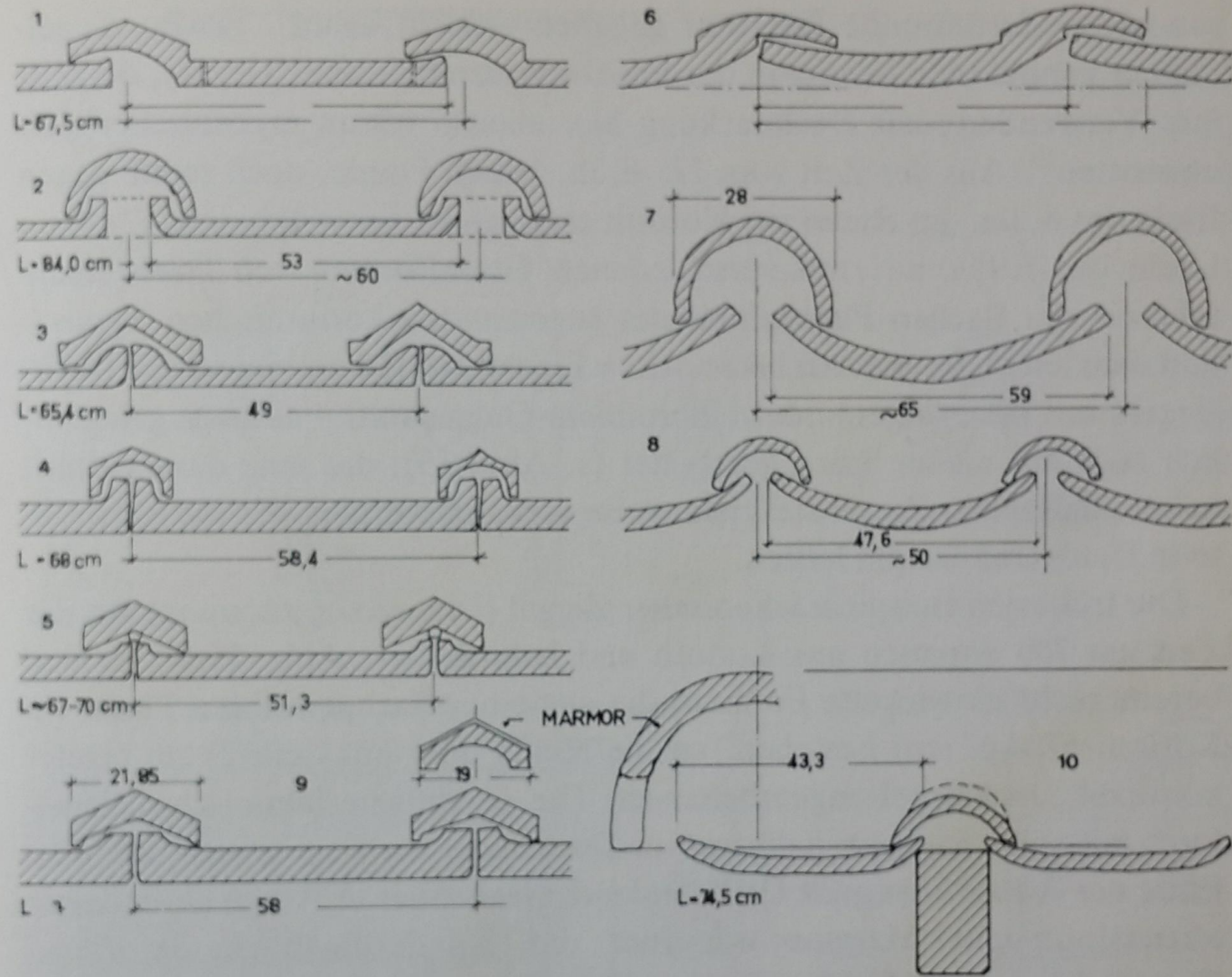

15 Profile von Dachziegeln (Mstb. 1 : 20): 1: Ägina-Apollontempel; 2: Neandria (6. Jh.); 3 - Olympia, Altsizilisches Dach; 4: Larisa/Hermos (6./5. Jh.); 5: Athen, Pompeion (4. Jh.); 6: Isthmia, Alter Tempel; 7: Olympia, Heraion; 8: Kalydon; 9: Paros, Marmorziegel (3. V. 6. Jh.); 10: Delos, Naxieroikos (um 575)

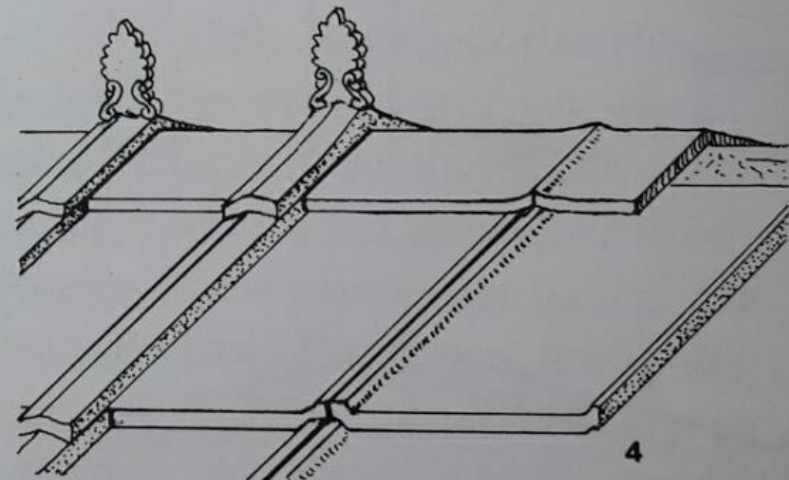
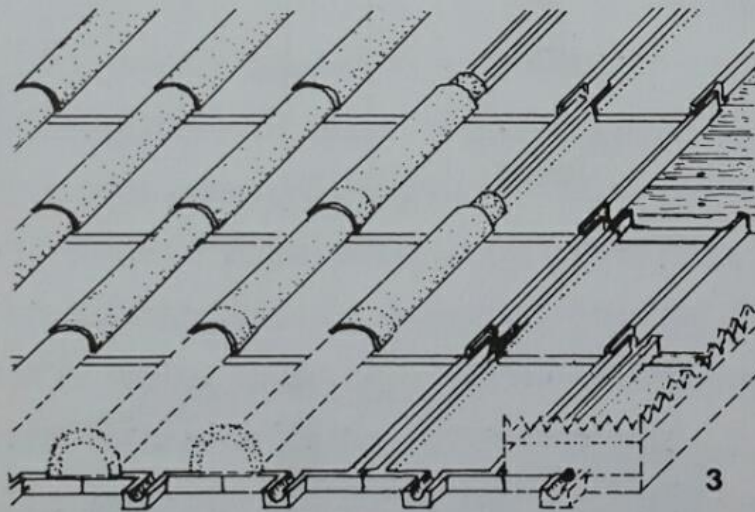
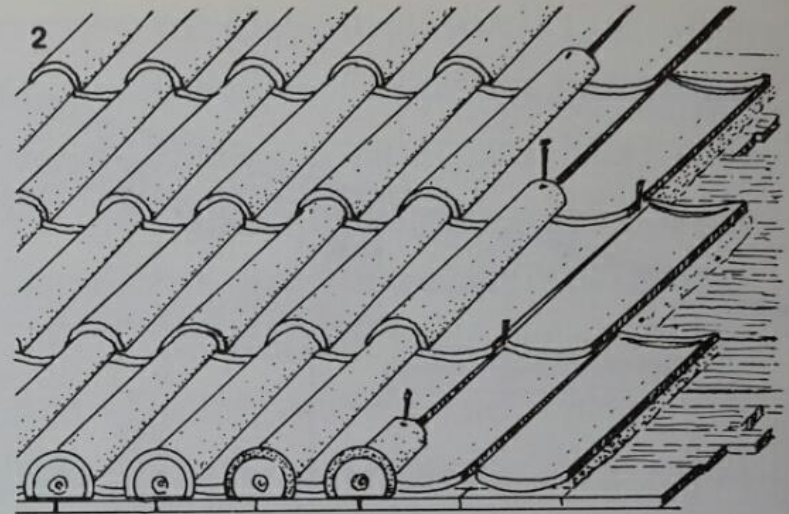
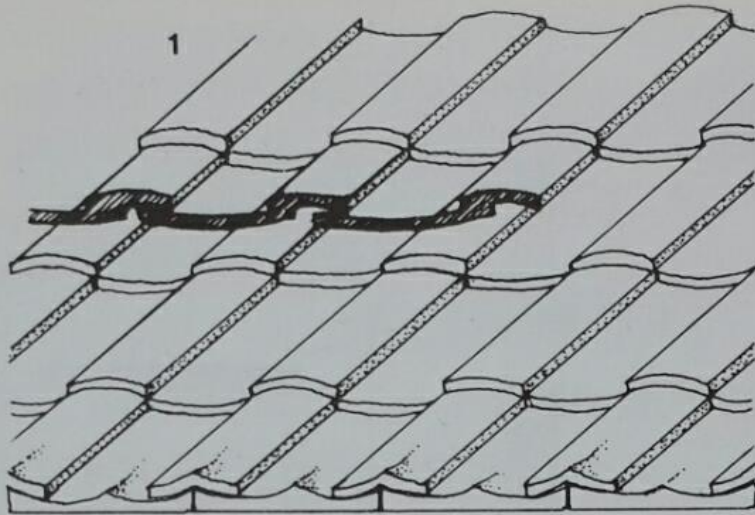

54 Schematische Darstellung verschiedener Dachdeckungen: 1: Dach des archaischen Zeustempels Isthmia; 2. Lakonisches Dach des Laphrion (Kalydon); 3: Dach aus Neandria; 4: Firstkonstruktion am Aphaiatempel (Ägina)

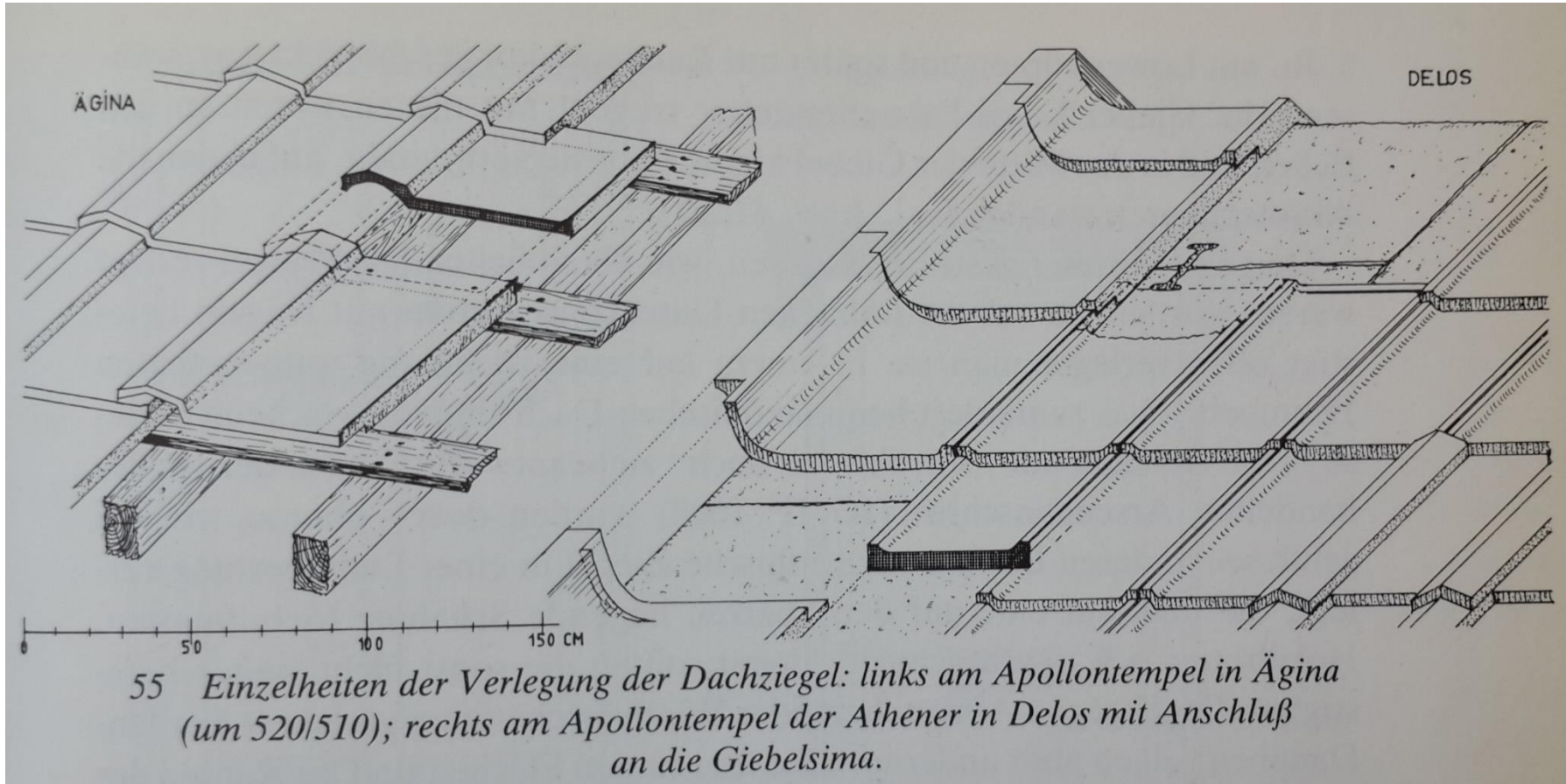

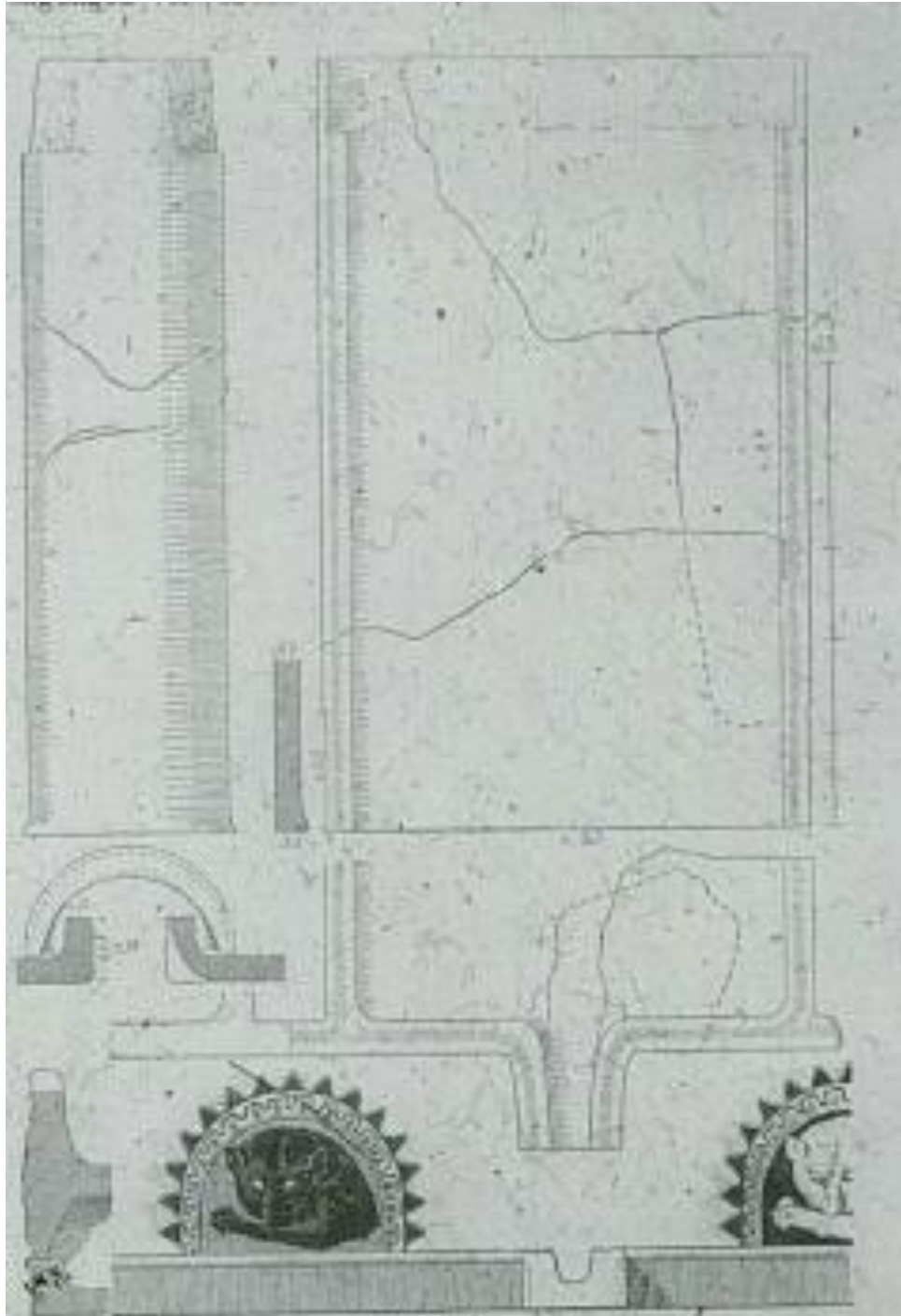

116. 60. Dordrecht, 1800.

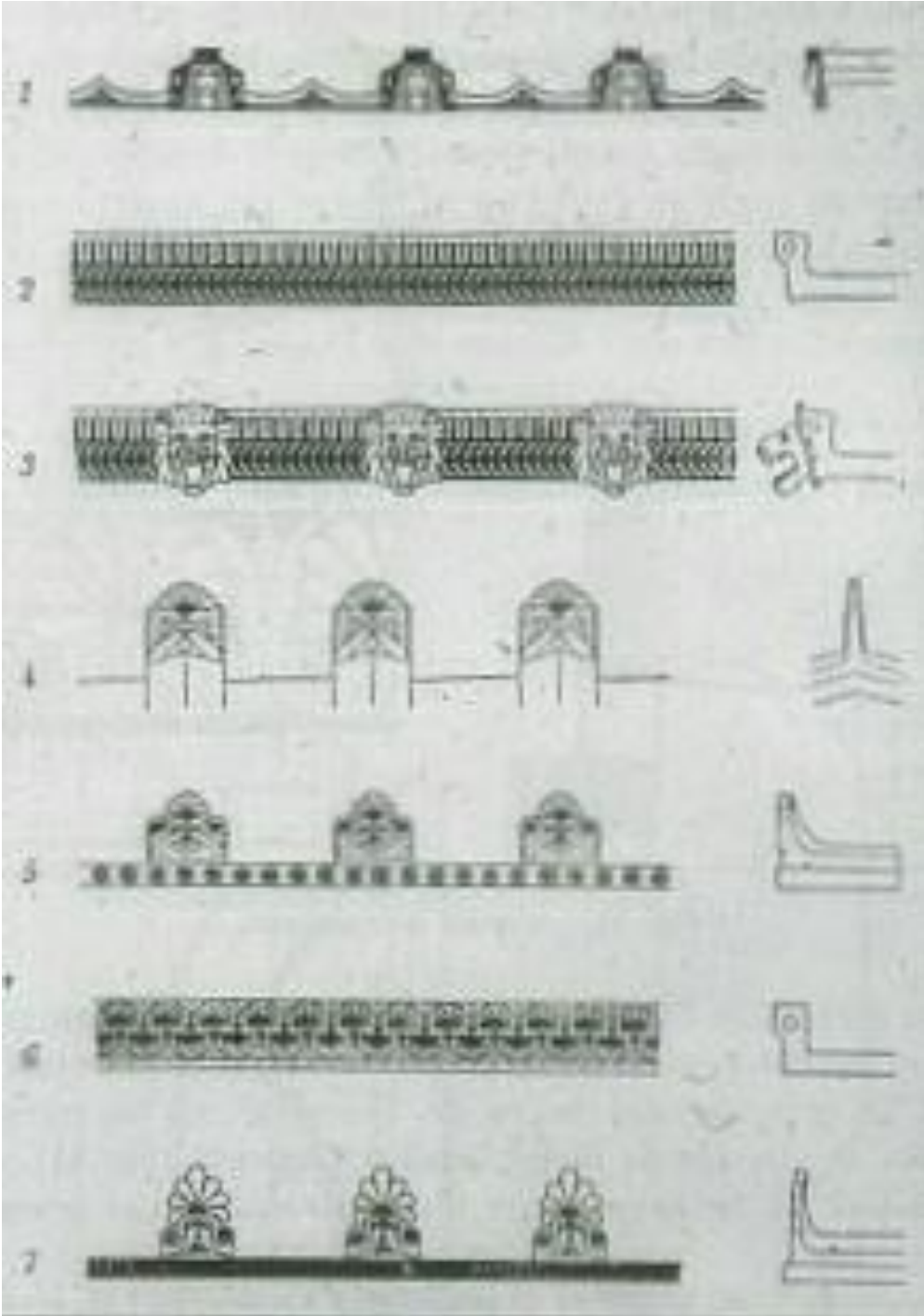

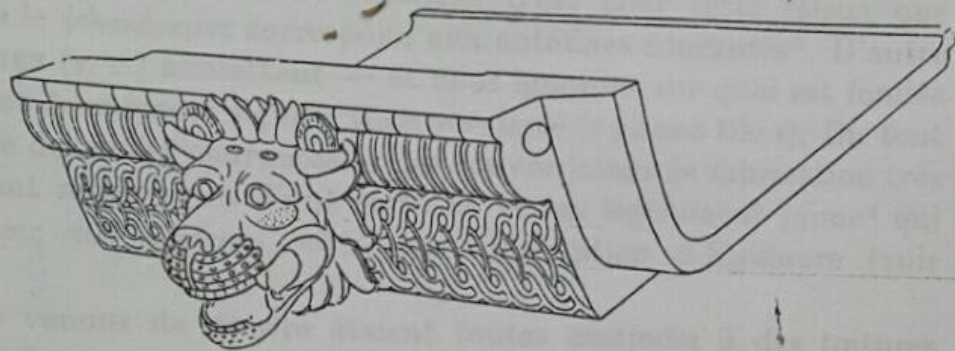

Fig. 60. — Tuile de rive de l'angle inférieur du fronton (παραετίς), en terre cuite; type corinthien à tête de lion, Kalydôn (Ρηομαίος).

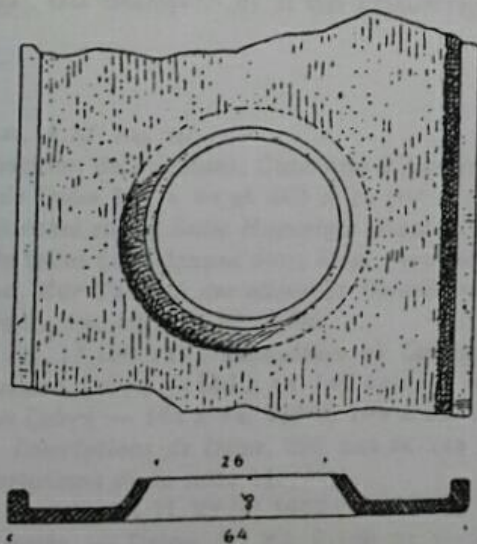

Fig. 61. — Tuile percée en terre cuite (ὀπαία κεραιμία) de Priène (WIEGAND-SCHRADER).

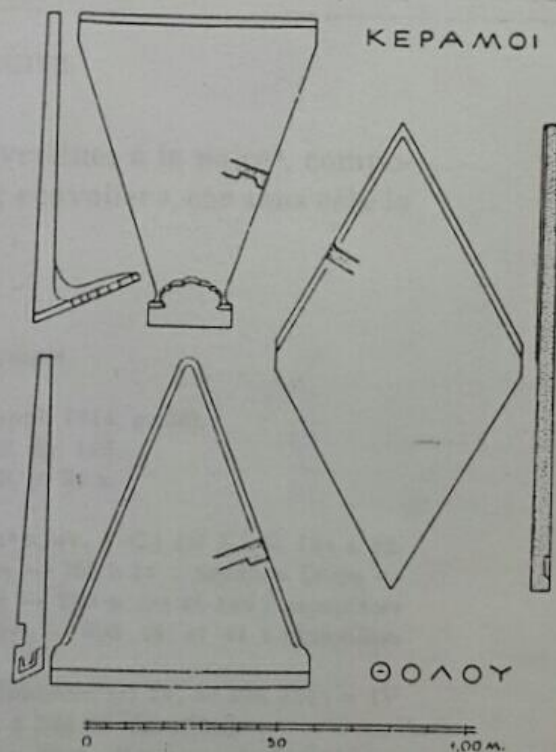
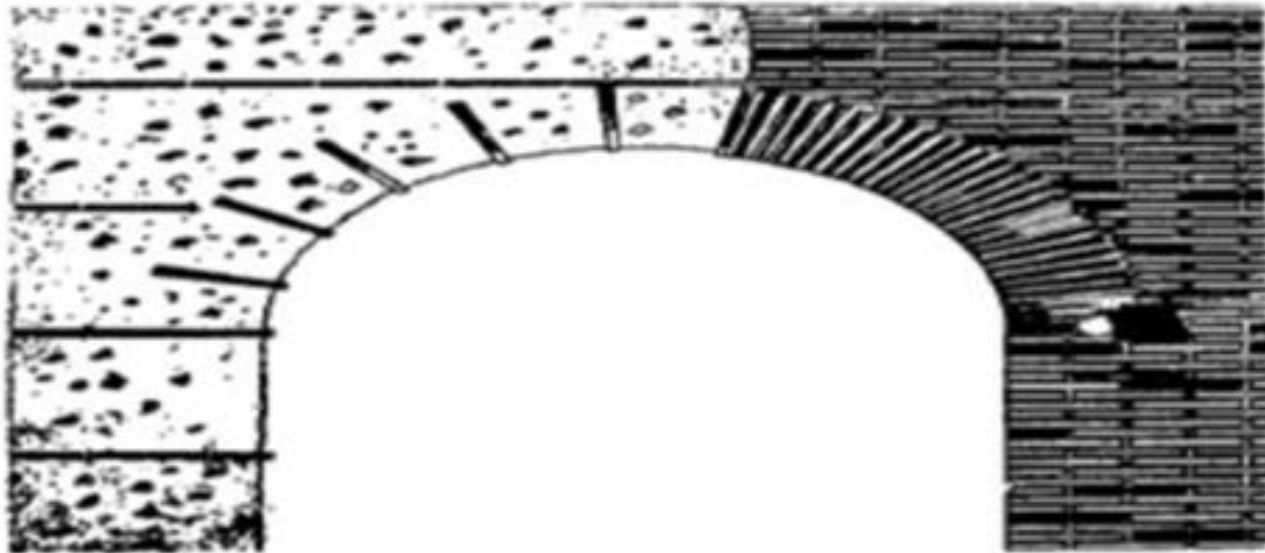

Fig. 62. — Tuiles triangulaires et en losanges de la Tholos d'Athènes (THOMPSON).

Antik Dönemde Kemer ve Tonoz



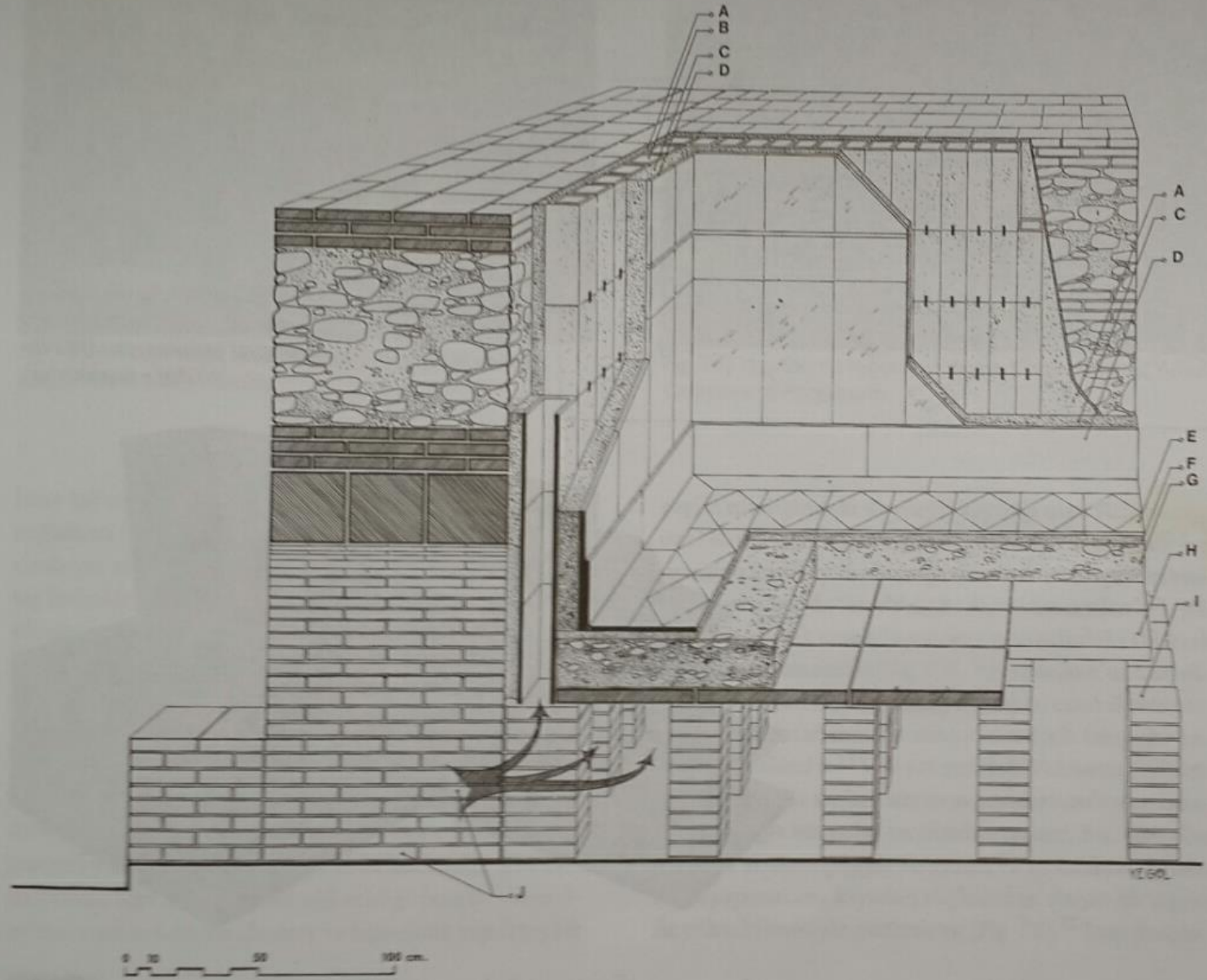

Fig. 71) Tipik bir Roma hamamının hypocaust ısıtma sistemi şeması (Yegül).

a: Kireç harç; b: Tubuli; c: Tuğla kırığı ve tozlu harç; d: Mermer duvar kaplaması; e: Taban döşemesi; f: Döşeme altı harcı; g: Beton taban harcı; h: Büyük tuğlalar (bipedales); i: Tuğla ayaklar veya sütunlar (pilae); j: Ocak (prae-furnium).

