

# ALAN ANALİZİ ÖRNEKLERİ

PEYZAJ TASARIMI DERSİ

Doç.Dr.Işıl KAYMAZ

# 01 Durum Analizi

## Ulaşım İlişkin Sorunlar

- Yaya akışını kısıtlayan hatlar
- Sorunlu kavşaklar
- Düzensiz araç birikim alanları

## Kullanım İlişkin Sorunlar

- Cazibesini yitirmiş odak
- Bölücü arazi kullanımı
- Restore edilmesi gereken yapılar

## Doku Değerlendirmesi

- Tescilli anıtsal yapılar
- Tescilli sivil mimari örnekleri
- Geleneksel mimari karakteri tamamlayan yapılar
- Aykırı yapılar

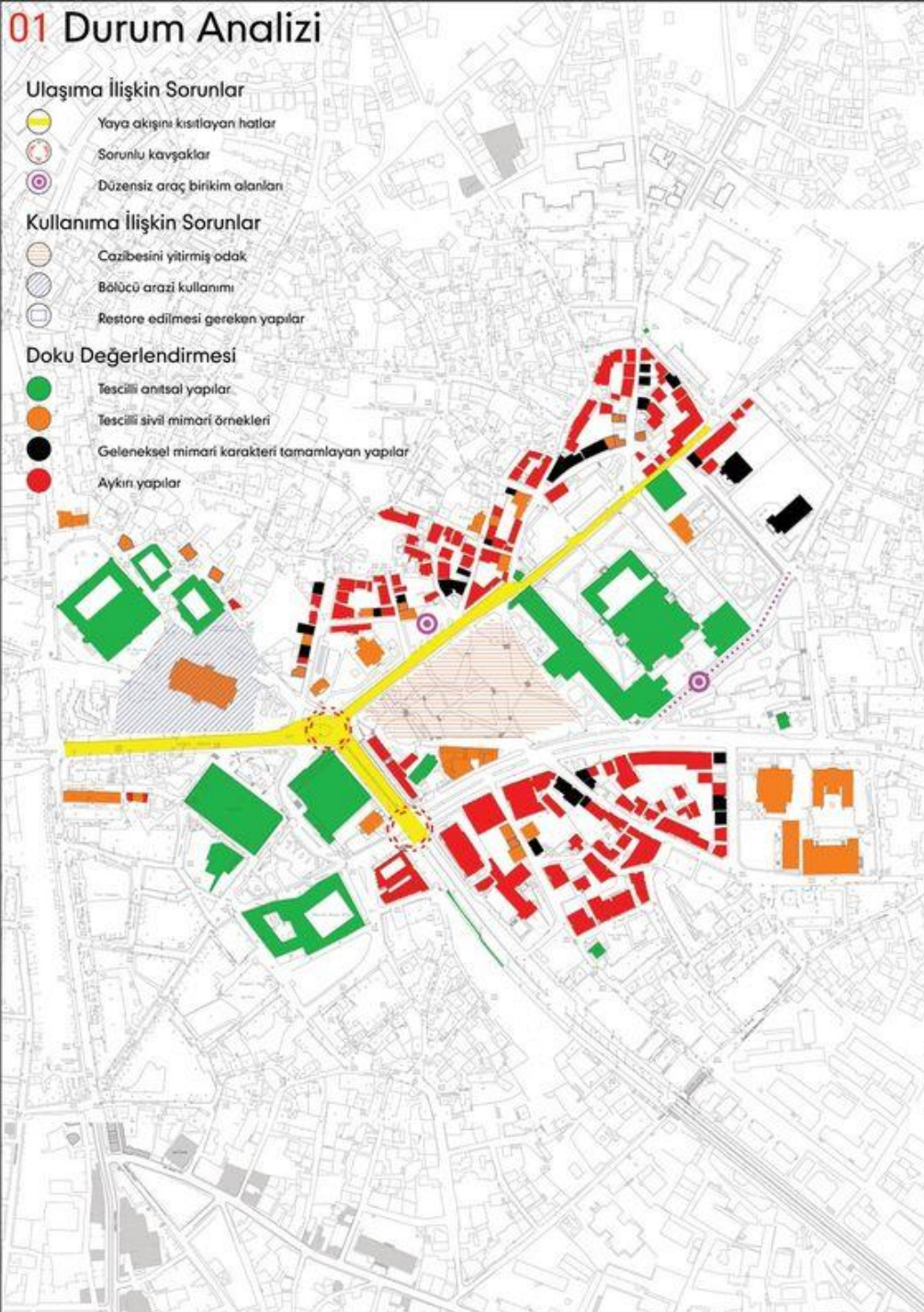

## YAKIN ÇEVRE İLİSKİSİ

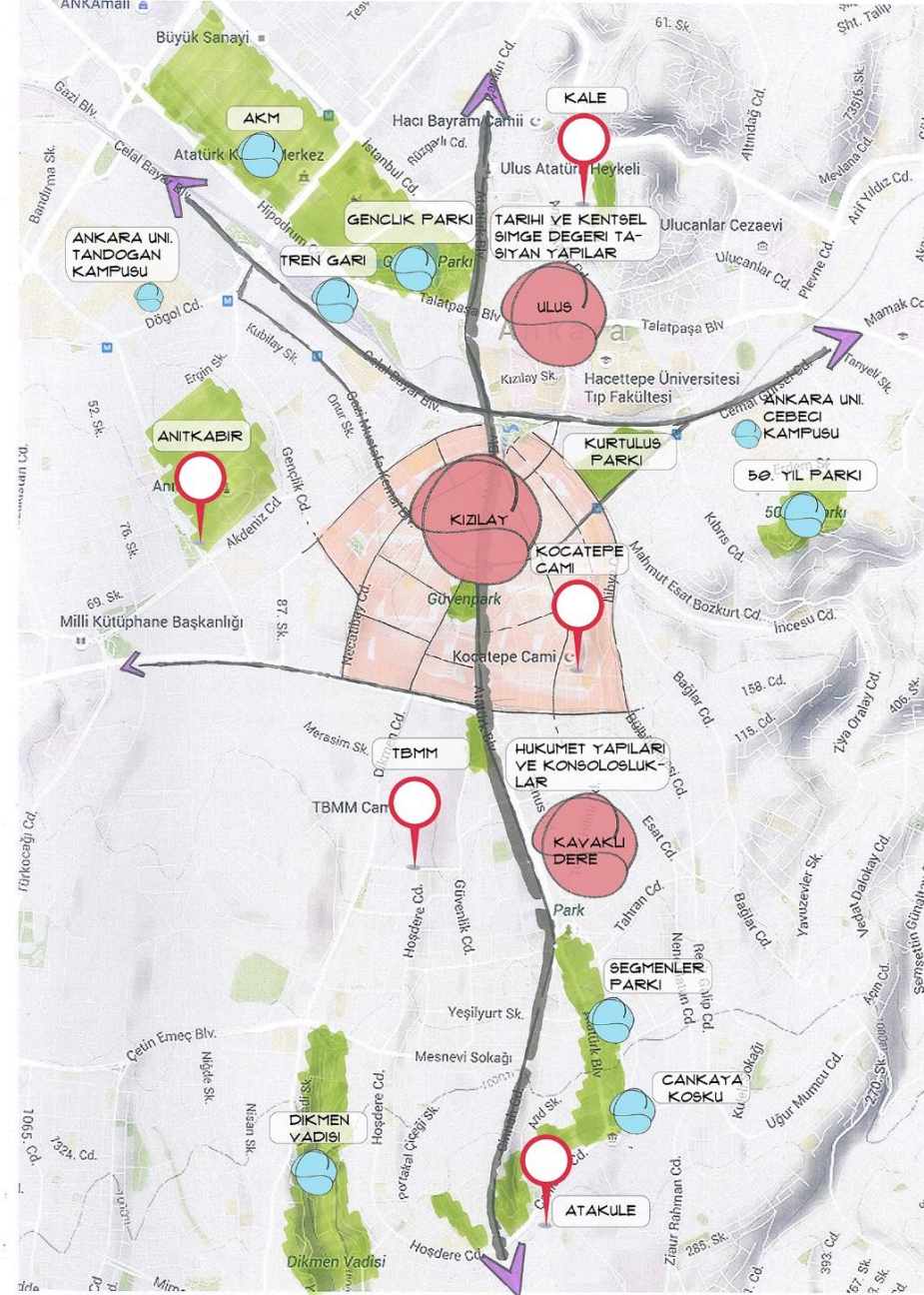

## MADE IN PORTLAND

### SITE FEATURES

Industrial features that reflect the unique legacy of the site are preserved and integrated.

### ADAPTIVE RE-USE

A former manufacturing shed for building facades is re-imagined as a contemporary retail and cultural space.

### CREATIVE STUDIOS

A network of spaces taps into Portland's distinct maker + creative culture.

## CLIMATE

### OPTIMAL BUILDING ORIENTATION

All buildings are oriented to maximize exposure to the sun.

## LIVABILITY

Every resident has access to public space, work, living, retail, food and cultural amenities within 5 minutes.



## HEALTHY COMMUNITY

### SPORTS+RECREATION

A series of sports amenities programmed under the bridge to promote active recreation.

### ACCESS TO PUBLIC SPACE



### COMMUNITY FARM

Every building has access to a rooftop community farm.

### COMPLETE STREETS

A system of complete streets prioritizes pedestrians, biking and storm water management.

### PUBLIC TRANSIT

The site is well connected to other core streets in Portland by public transportation.



### VERTICAL FARM

Promotes sustainable food production on-site for dining, learning and engaging the broader community.

## WATER MANAGEMENT



The development is structured around an integrated storm water management strategy.



A diagram of a greenway along the waterfront, showing a path for walking, biking, and infiltration. It includes icons for public open space, bioswale, biking, pedestrian, and infiltration.

### GREENWAY

A public greenway along the waterfront is integrated into the development.

- PUBLIC OPEN SPACE
- BIOSWALE
- BIKING
- PEDESTRIAN
- INFILTRATION

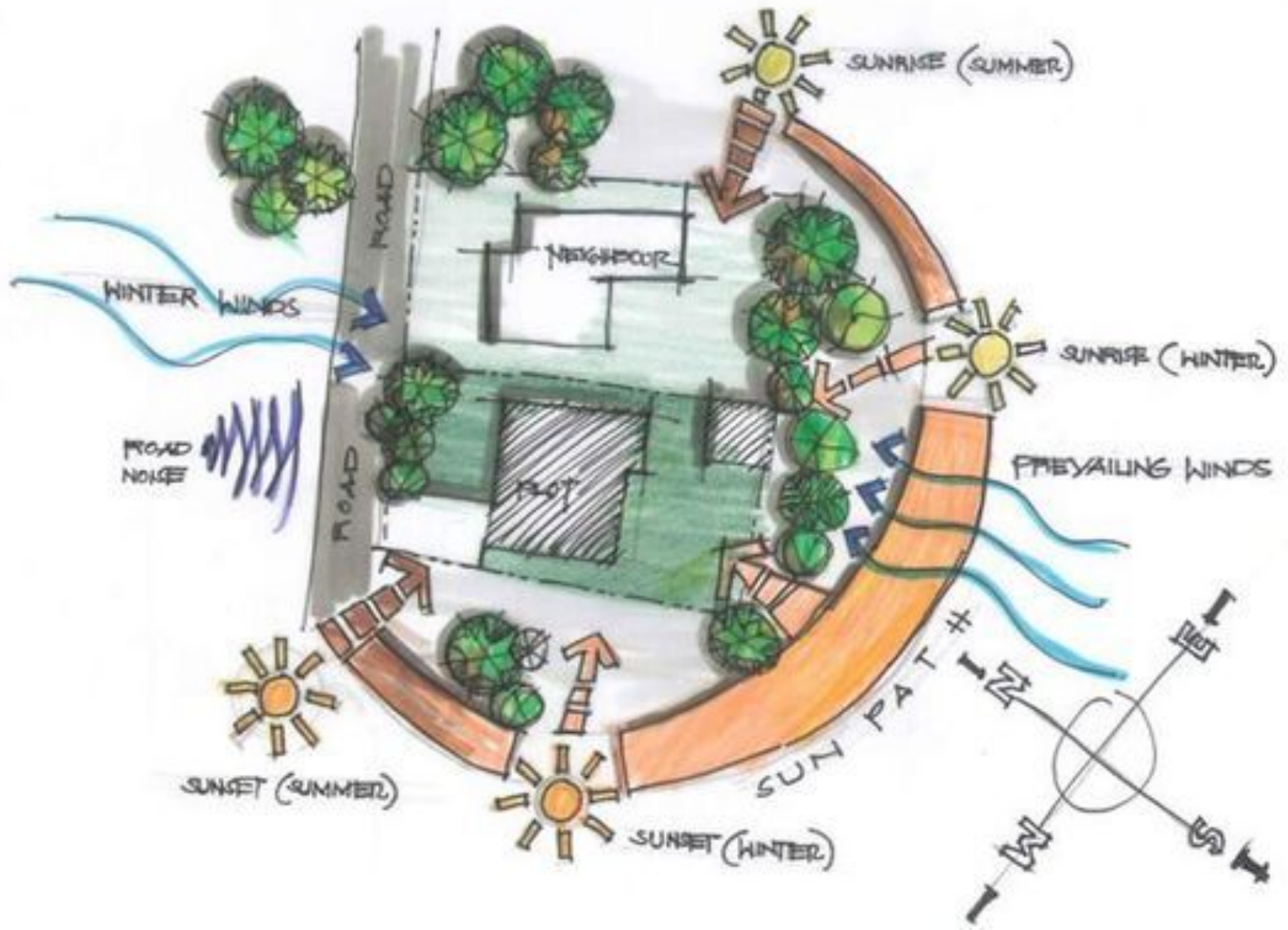



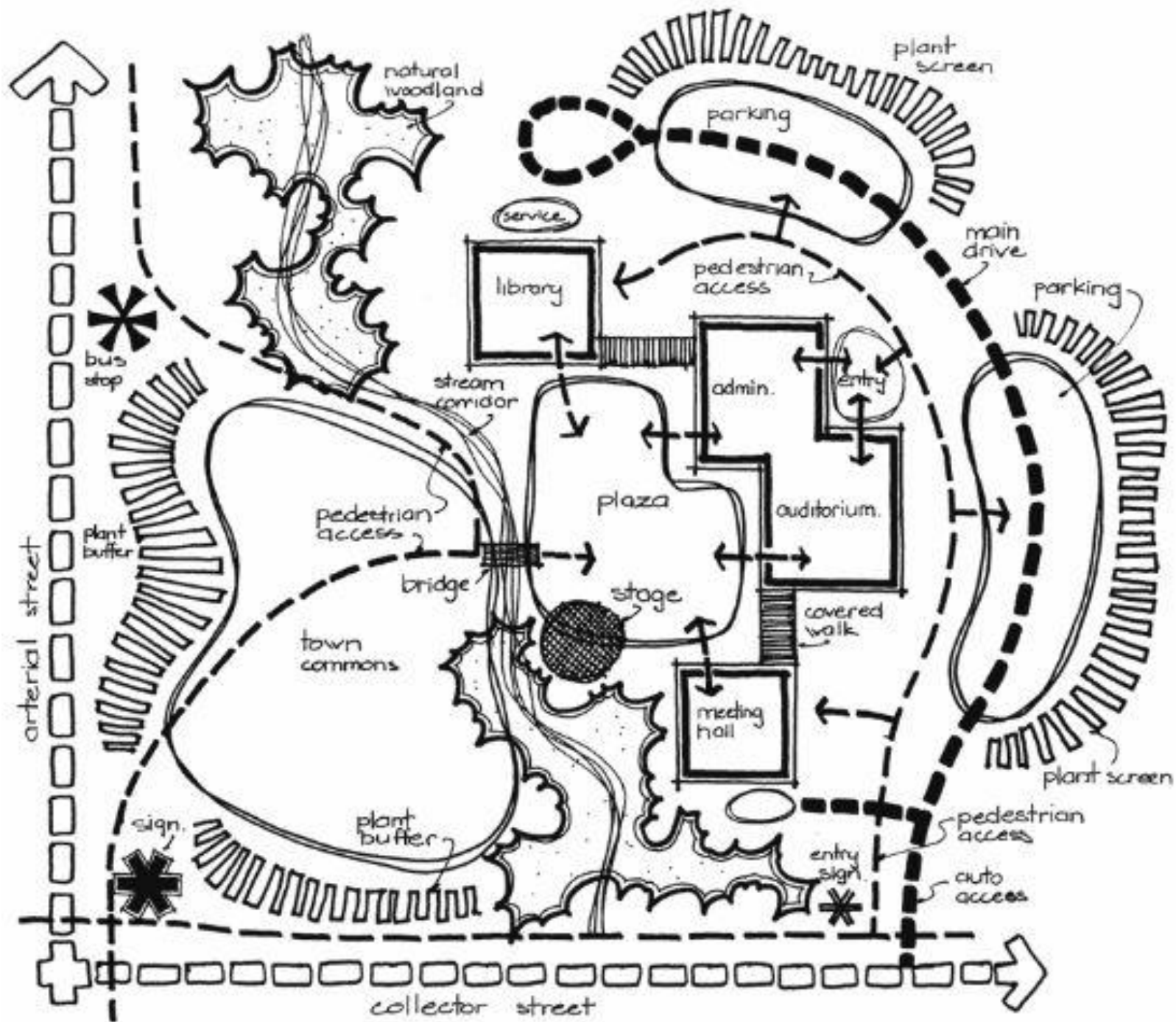

General Notes

- Shady
- woody feel
- Beautiful backyard

CREATE SENSE OF ENTRY

- current layout creates confusion
- lead people to front door



EX. SIDEWALK  
• to be removed  
• regrade to new curb?

EX. PAVING  
• to remain

EX. GARDEN

LAWN DESIRED  
• remove some of asphalt

MAINTAIN VEHICULAR CIRCULATION  
• provide clear sense of entry

STEEP HILLSIDE  
• protect from erosion  
• create terraces w walls?

FINISH FLOOR  
ELEVATION = 100.00

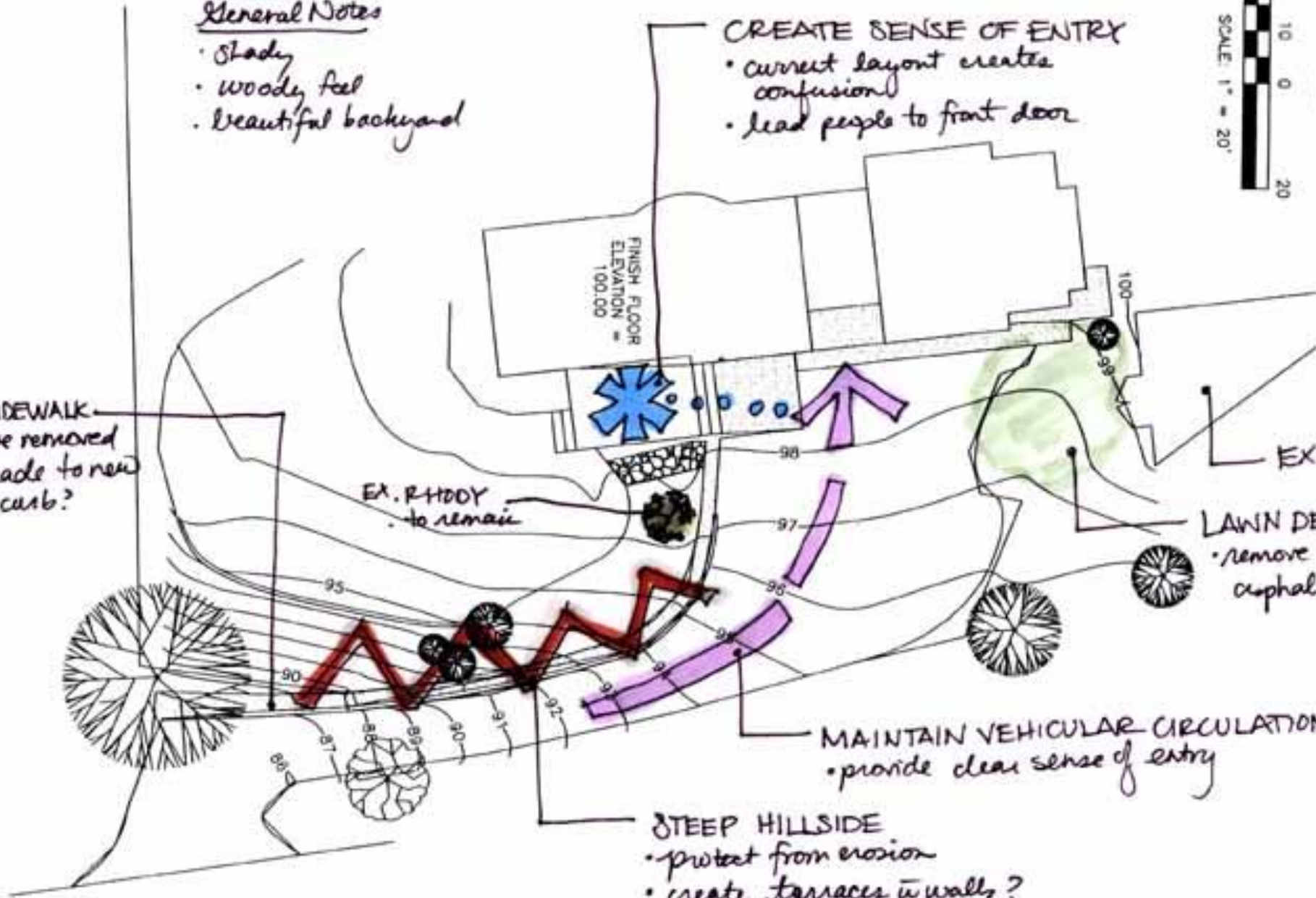

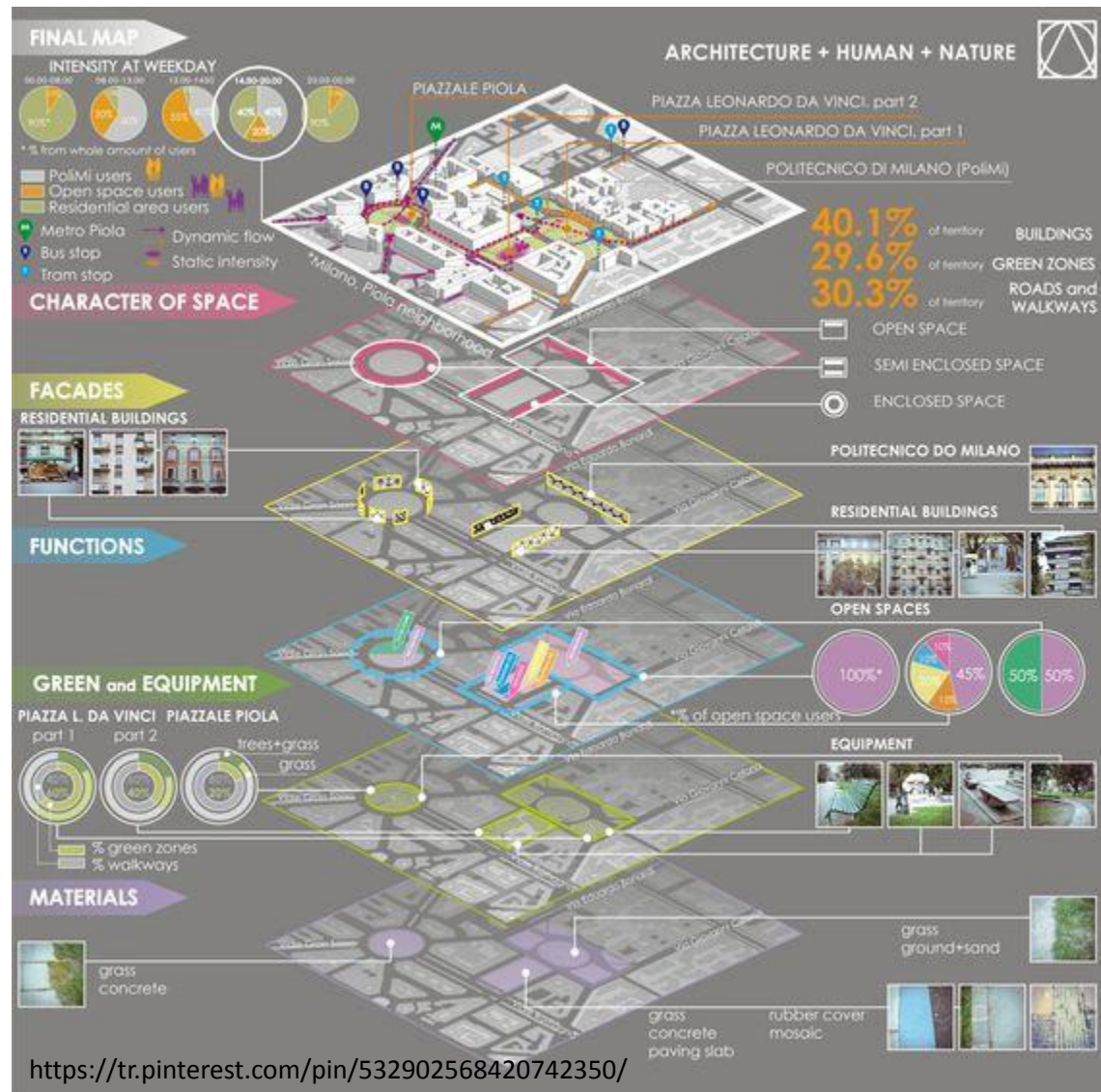
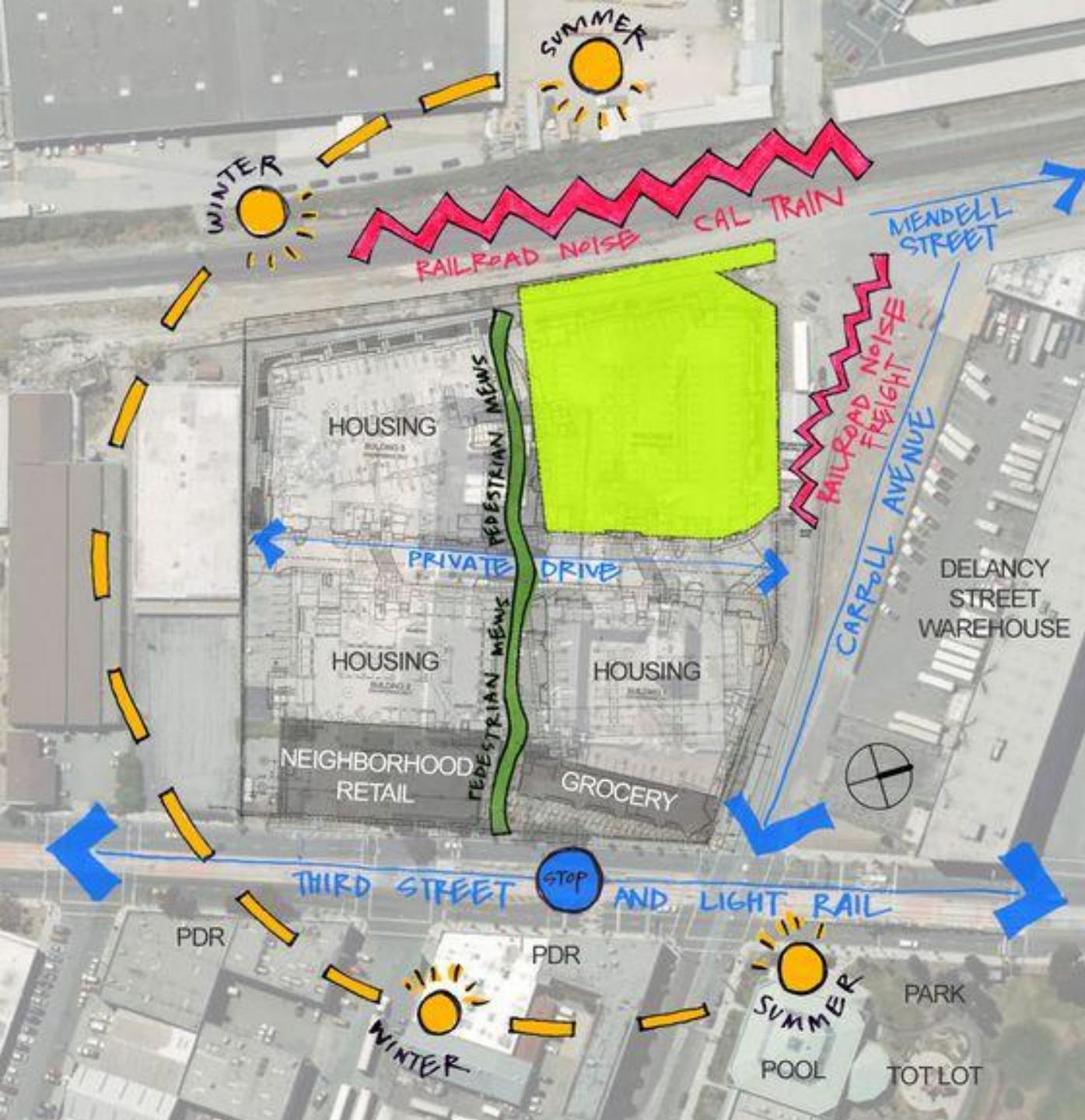



# synthesis plan

# Analysis

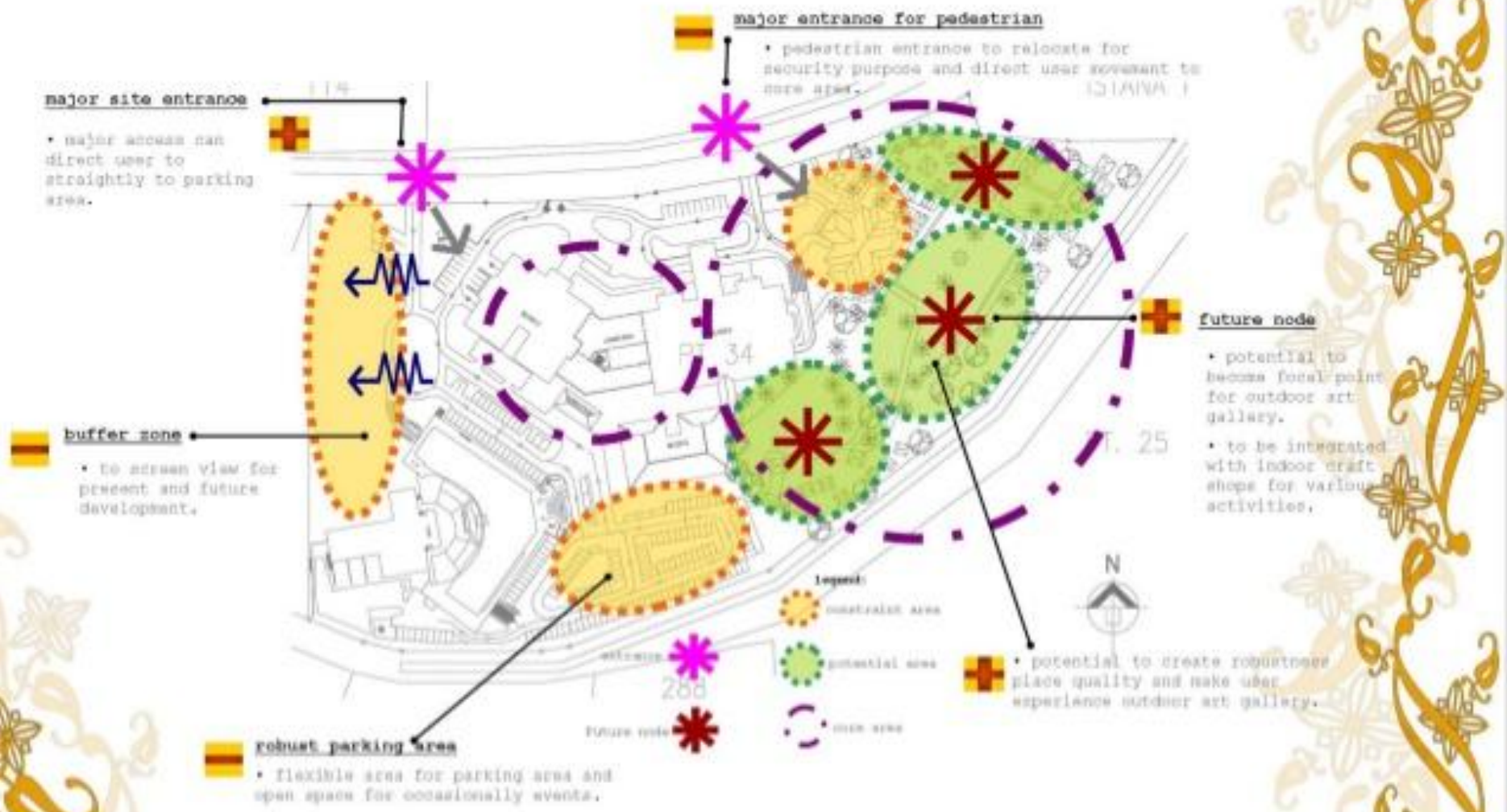

07/08/2018  
noorul iffa mohd nayan, 4th year landscape architecture

**Example of Site Synthesis Diagram**



Site Analysis

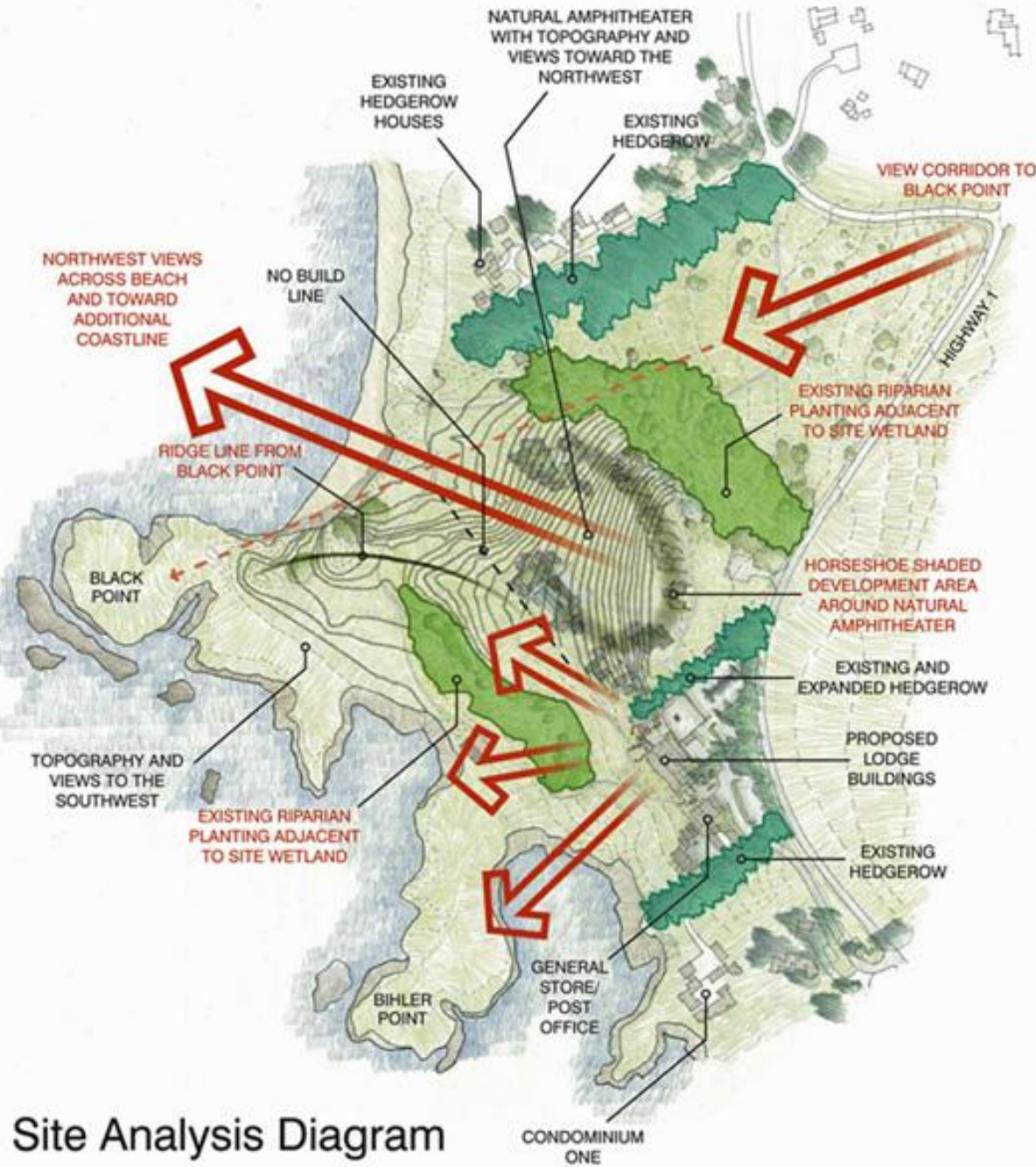

Site Analysis Diagram

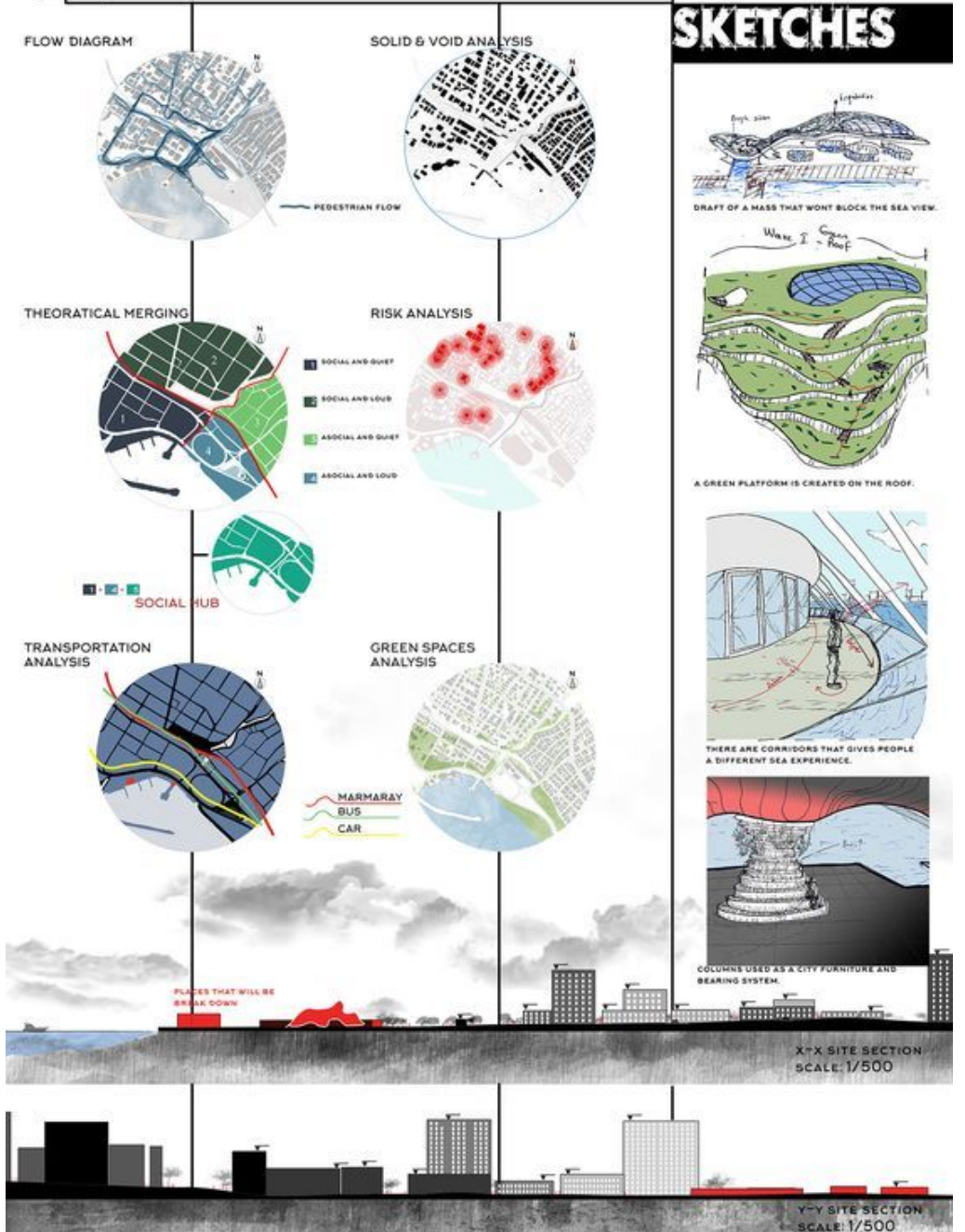



# Architecture Site Analysis Symbols

Site Boundary



Existing Buildings

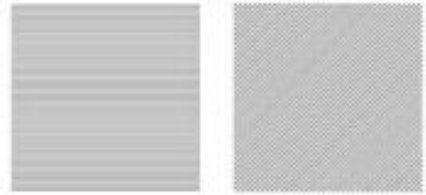

Existing Buildings To Be Demolished

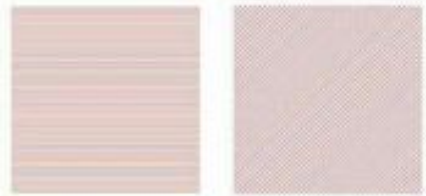

Trees



Sun Path



Wind Direction

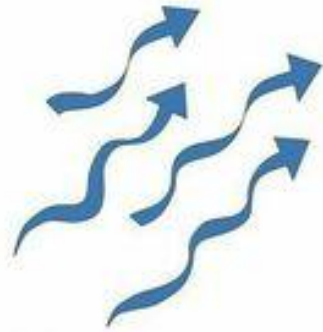

Labels



Pedestrian Access

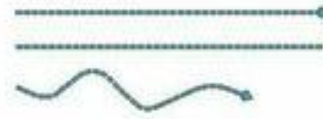

Vehicle Access

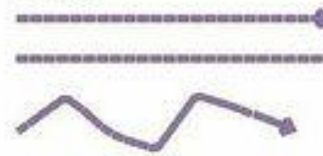

Public Access



Private Access



Right Of Way



Views



Key Zone 01

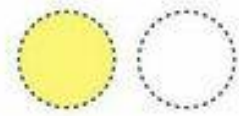

Key Zone 02

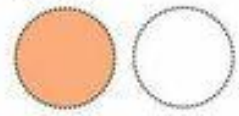

Key Zone 03

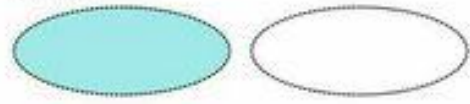

Key Zone 04



Key Zone 05



Key Zone 06

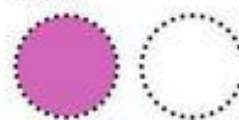

Straight Line



Obstruction

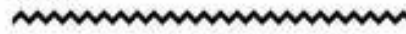

North Point



People

